

# Surveyor

by Forest River

DON'T JUST DREAM. LIVE.

Surveyor  
by Forest River



STRONG, DURABLE LAMINATED FIBERGLASS WITH ALL ALUMINUM CAGE CONSTRUCTION





# BIG THINGS COME IN SMALL PACKAGES

As with every series designed by Surveyor, a premium is placed on superior craftsmanship and unmatched value. By combining lightweight floor plans and efficient design, Surveyor delivers superior camping comfort.



**191T**  
SLATE DECOR



**224T**  
JAVA DECOR



EXPANDABLES



## EXPANDABLE FLOORPLANS

ST=Storage PT=Pass Thru Storage  
OHD=Overhead Cabinet

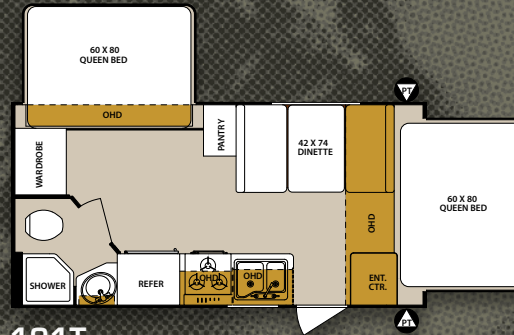

191T

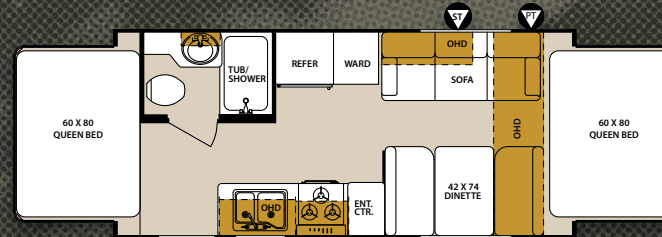

192T

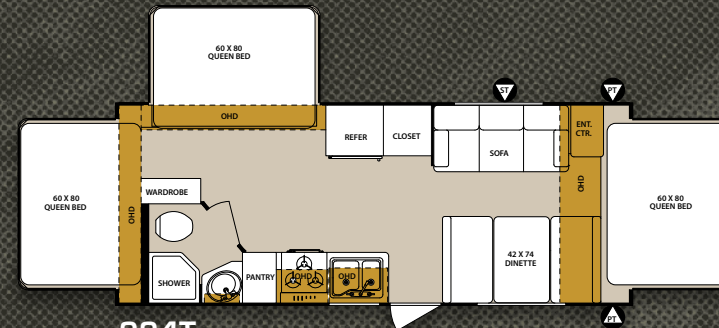

224T

## SPECIFICATIONS

MODEL	191T	192T	224T
*TOTAL DRY WEIGHT	3358	3680	4026
LOAD CAPACITY	1478	1730	1428
HITCH WEIGHT	436	372	416
OVERALL LENGTH	20'4"	21'11"	24'7"
EXT. WIDTH	8'0"	8'0"	8'0"
EXT. HEIGHT (W/ AC)	10'5"	10'5"	10'5"
FRESH WATER (GAL)	46	46	46
GREY WATER (GAL)	40	40	40
BLACK WATER (GAL)	30	30	30
AWNING SIZE	12'	9'	13'

\*We know weights and dimensions are an important part of your buying decision. Surveyor weighs every model to ensure accuracy, although refinements to the product can create variations to weights and dimensions. Review a current model at your nearest authorized Surveyor Dealer today.



# FINALLY IT'S YOUR TURN

Whether it's time for dinner or you are just sitting back to relax, you will feel right at home. Surveyor's spacious countertops provide you with the room you need to prepare even the most elaborate meals.



**32RETS**  
SLATE DECOR



COUPLES COACHES





**240RBS**  
SLATE DECOR



**251RKS**  
SLATE DECOR



**265RLDS**  
PEBBLE DECOR





# LET US FILL YOUR EMPTY NEST WITH GREAT FEATURES

No need to make sacrifices while you travel. Surveyor boasts standard seamless kitchen countertops, 22" ovens (where applicable) with a recessed glass stove cover and a residential pull out sprayer faucet. Modern conveniences on the road.



## COUPLES COACH TRAVEL TRAILERS

ST=Storage PT=Pass Thru Storage  
OHD=Overhead Cabinet

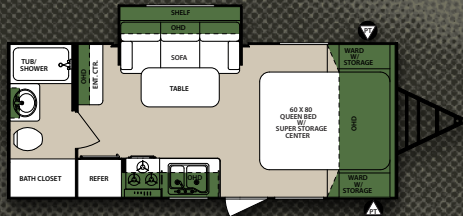

201RBS

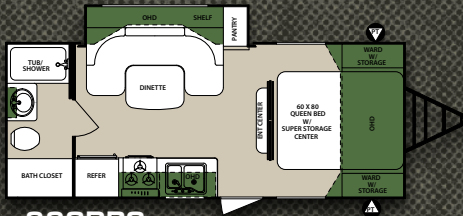

220RBS

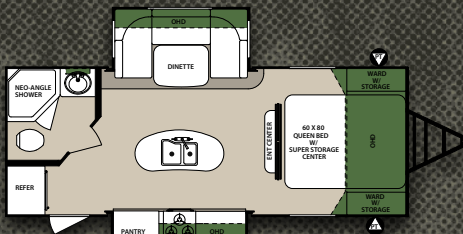

226RBS

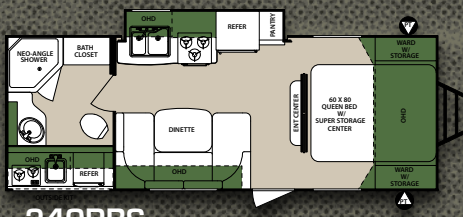

240RBS

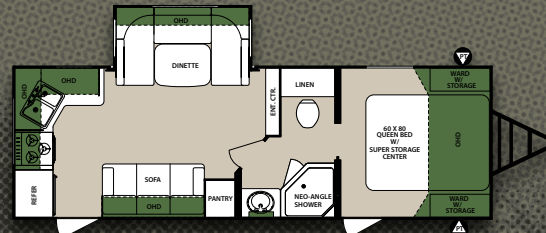

251RKS

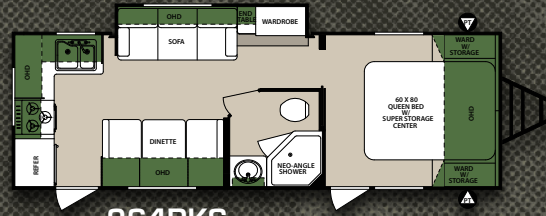

264RKS

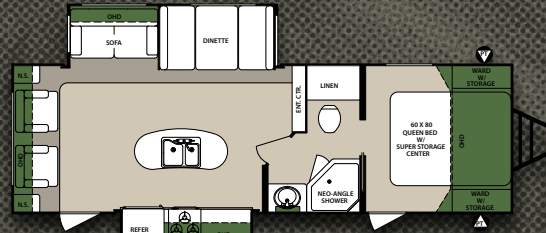

265RLDS

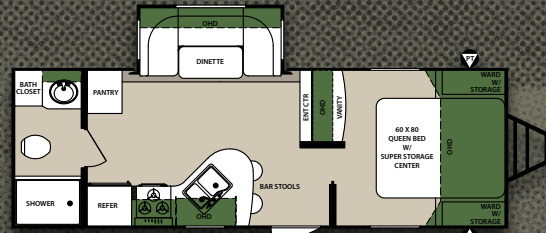

27RBS

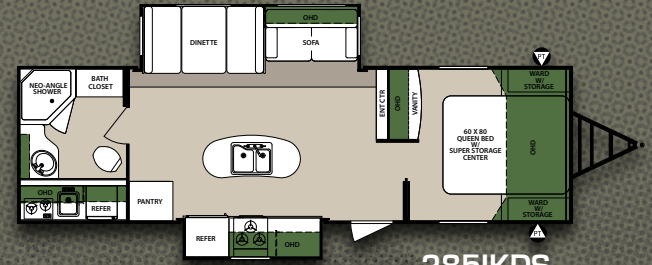

285IKDS

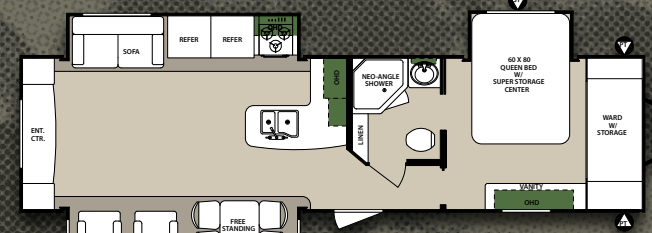

32RETS

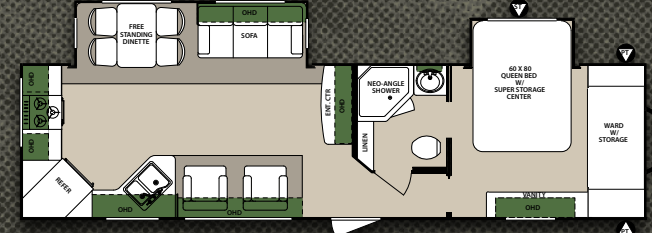

32RKDS



COUPLES COACHES



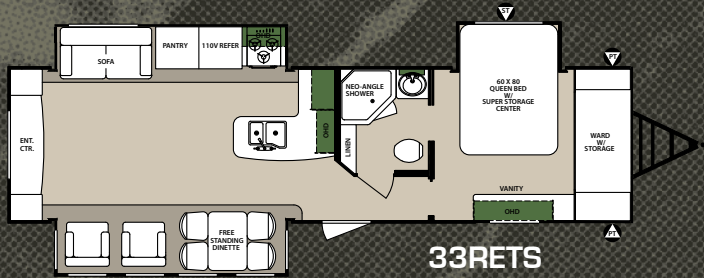
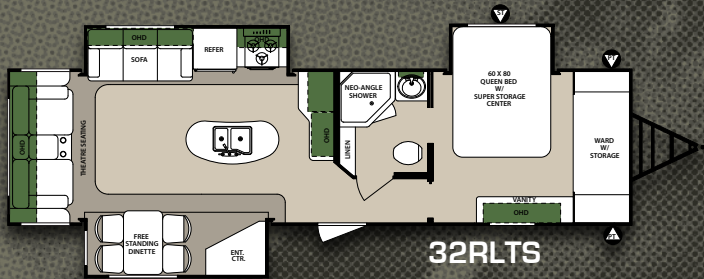

## SPECIFICATIONS

MODEL	201RBS	220RBS	226RBDs	240RBS	251RKS	264RKS	265RLDS	27RBS	285IKDS	32RETS	32RKDS	32RLTS	33RETS
*TOTAL DRY WEIGHT	4120	4329	4990	4763	5683	4958	5998	5408	6354	7478	6736	6980	7478
LOAD CAPACITY	1305	3157	2668	2859	2085	2993	1464	2180	3159	2426	2913	3034	2426
HITCH WEIGHT	425	486	658	622	768	651	762	588	713	1104	849	1214	1104
OVERALL LENGTH	24'5"	24'11"	25'10"	26'9"	29'6"	29'4"	31'3"	29'0"	32'7"	36'5"	36'5"	36'5"	36'5"
EXT. WIDTH	8'0"	8'0"	8'0"	8'0"	8'0"	8'0"	8'0"	8'0"	8'0"	8'0"	8'0"	8'0"	8'0"
EXT. HEIGHT (W/ AC)	10'5"	10'5"	11'0"	10'5"	10'5"	10'5"	11'2"	11'2"	11'3"	11'3"	11'3"	11'3"	11'3"
FRESH WATER (GAL)	46	46	46	46	46	46	46	46	46	46	46	46	46
GREY WATER (GAL)	40	40	40	40	60	60	40	40	75	75	75	75	75
BLACK WATER (GAL)	30	30	30	30	30	30	30	30	35	35	35	35	35
AWNING SIZE	13'	14'	17'	13'	20'	20'	17'	20'	18'	13'	20'	21'	13'

\*We know weights and dimensions are an important part of your buying decision. Surveyor weighs every model to ensure accuracy, although refinements to the product can create variations to weights and dimensions. Review a current model at your nearest authorized Surveyor Dealer today.





# FAMILY TIME IS TIME WELL SPENT

Surveyor's selection of family coaches is sure to cover your family camping needs. From smaller light weight models to the largest with a triple slide, Surveyor has something to fit your family.



**321BHTS**  
PEBBLE DECOR



**291BHSS**  
PEBBLE DECOR





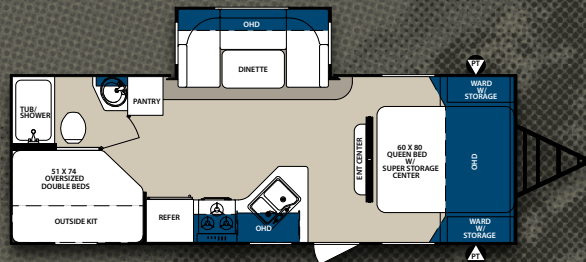

245BHS

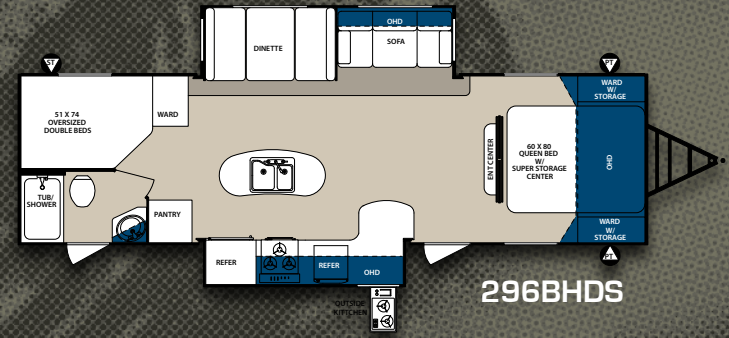

296BHDS

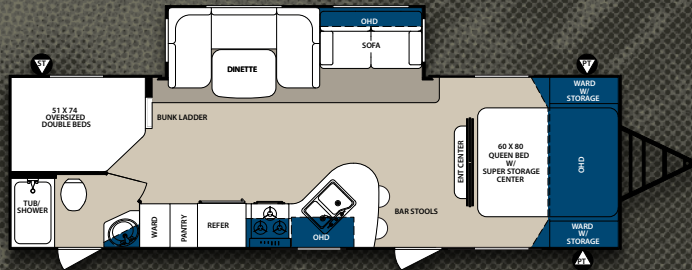

291BHSS

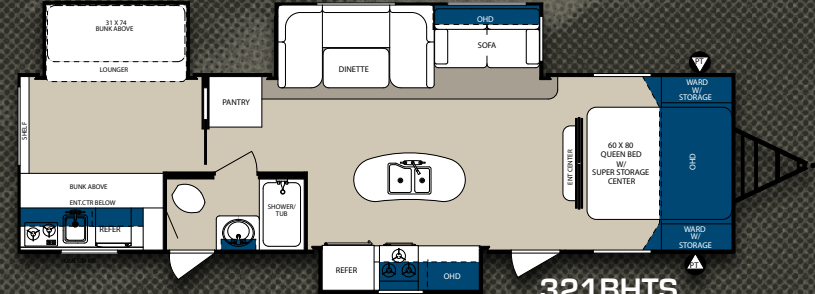

321BHTS

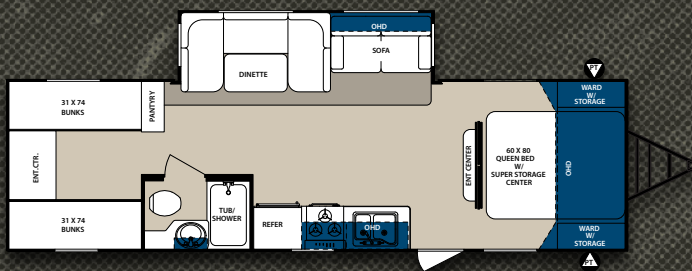

294QBLE

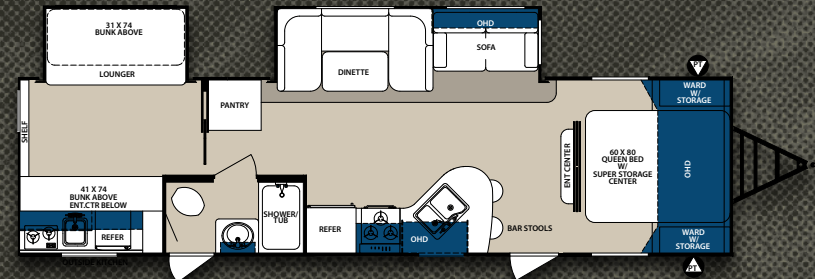

32BHDS



## SPECIFICATIONS

MODEL	245BHS	291BHSS	294QBLE	296BHDS	321BHTS	32BHDS
*TOTAL DRY WEIGHT	5166	5858	5564	6643	7283	6866
LOAD CAPACITY	2460	1886	2114	3021	2288	2668
HITCH WEIGHT	626	744	678	864	771	734
OVERALL LENGTH	28'3"	32'7"	33'0"	33'11"	36'5"	36'6"
EXT. WIDTH	8'0"	8'0"	8'0"	8'0"	8'0"	8'0"
EXT. HEIGHT (W/ AC)	11'3"	11'3"	11'3"	11'3"	11'3"	11'3"
FRESH WATER (GAL)	46	46	46	46	46	46
GREY WATER (GAL)	40	40	40	40	40	40
BLACK WATER (GAL)	30	30	30	30	30	30
AWNING SIZE	19'	17'	17'	20'	17'	17'

\*We know weights and dimensions are an important part of your buying decision. Surveyor weighs every model to ensure accuracy, although refinements to the product can create variations to weights and dimensions. Review a current model at your nearest authorized Surveyor Dealer today.



# HIGH END FEATURES, VALUE PRICE

Features and quality you expect. Our handcrafted furniture built in the USA, solid surface kitchen countertops, 8 cu. ft. refer, 22" ovens and a standard fireplace are just a few of the high end items you will find in every Surveyor fifth wheel.



FIFTH WHEEL



**293RLTS**  
SLATE DECOR



**292RETS**  
JAVA DECOR





# FIFTH WHEEL FLOORPLANS

ST=Storage PT=Pass Thru Storage  
OHD=Overhead Cabinet

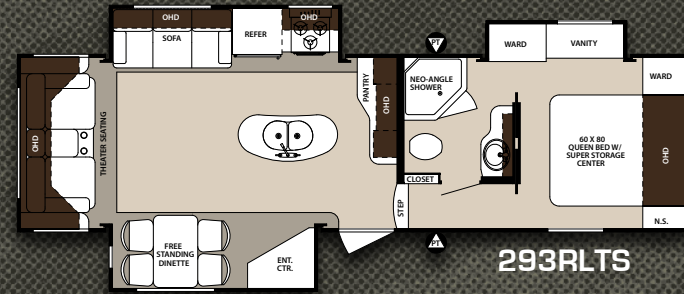
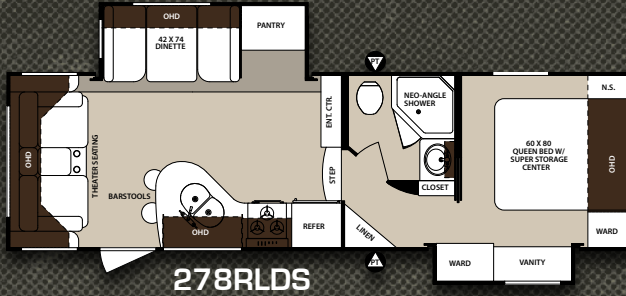
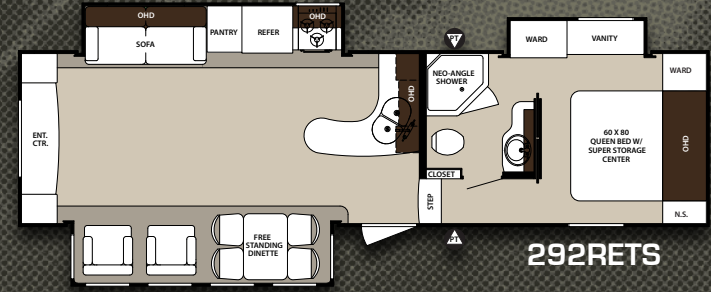
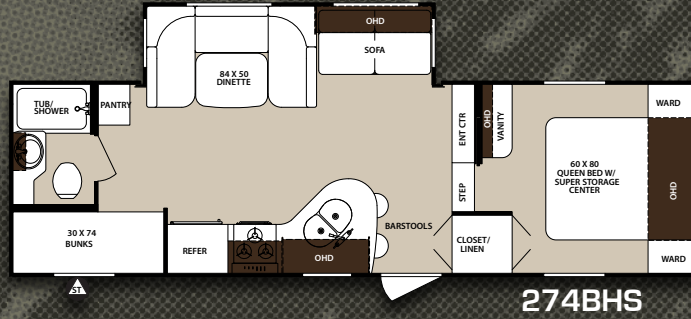

## SPECIFICATIONS

MODEL	274BHS	278RLDS	292RETS	293RLTS
*TOTAL DRY WEIGHT	7071	7769	8266	8496
LOAD CAPACITY	2801	2481	3398	3456
HITCH WEIGHT	1072	1450	1504	1792
OVERALL LENGTH	30'8"	30'4"	32'10"	32'10"
EXT. WIDTH	8'0"	8'0"	8'0"	8'0"
EXT. HEIGHT (W/ AC)	12'5"	12'5"	12'3"	12'7"
FRESH WATER (GAL)	47	47	47	47
GREY WATER (GAL)	75	75	75	75
BLACK WATER (GAL)	35	35	35	35
AWNING SIZE	16'	12'	18'	20'

\*We know weights and dimensions are an important part of your buying decision. Surveyor weighs every model to ensure accuracy, although refinements to the product can create variations to weights and dimensions. Review a current model at your nearest authorized Surveyor Dealer today.



# SURVEYOR SIGNATURE PACKAGE

THE SURVEYOR ADVANTAGE



**SIDEWALL**  
2-TONE GEL-COATED FIBERGLASS SIDE WALLS WITH PREMIUM GRAPHICS



**FIFTH WHEEL CAP**  
FRONT GEL COAT FIBERGLASS CAP



**TRAVEL TRAILER CAP**  
FRONT GEL COAT FIBERGLASS CAP

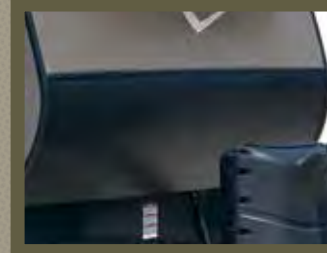

**TRAVEL TRAILER DIAMOND PLATE**  
BLACK DIAMOND PLATE



**BACK UP CAMERA**  
PREP ONLY TRAVEL TRAILER



**ALUMINUM WHEELS**



**BAGGAGE DOOR**  
MAGNETIC HINGED BAGGAGE DOOR CATCHES



**HINGES**  
FRICTION HINGES ON ENTRY DOOR



**COUNTERTOP**  
SEAMLESS KITCHEN COUNTERTOPS (TRAVEL TRAILER)



**COUNTERTOP**  
SOLID SURFACE KITCHEN COUNTERTOPS WITH UNDER MOUNTED SINK (FIFTH WHEEL)



**LED RECESSED INTERIOR LIGHTING**



**RESIDENTIAL CURTAIN RODS**



**BEDROOM NIGHT SHADES**



**LIVING ROOM WOOD BLINDS**



**RECESSED STOVE WITH GLASS COVER**



**DYSON CORDLESS VACUUM**  
(FIFTH WHEEL ONLY)



**50 AMP SERVICE**  
(STANDARD FIFTH WHEEL/OPTIONAL TRAVEL TRAILER)



TO LEARN MORE ABOUT SURVEYOR RV SCAN HERE



# SURVEYOR FEATURE BENEFITS

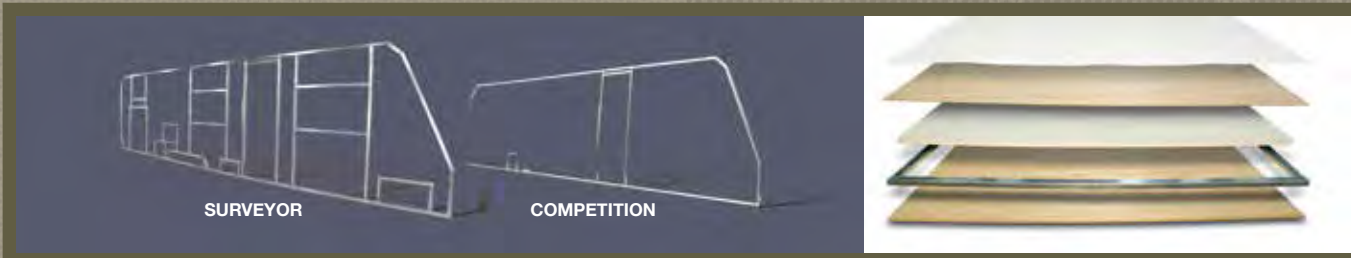

## SUPERIOR CONSTRUCTION

SURVEYOR IS ONE OF THE STRONGEST LIGHT WEIGHT TRAILERS BECAUSE OF OUR ALUMINUM FRAMED OPENINGS AND LAMINATION PROCESS. HIGH QUALITY MATERIALS, 100% GLUE COVERAGE AND FULLY FRAMED ALUMINUM FLOOR, ROOF, WALLS, FRONT AND BACKS PROVIDE YOU A STRUCTURE FOR PEACE OF MIND. NOT FOUND IN MOST RV'S TODAY.



## FRESH WATER

LIKE TO CARRY THIS MUCH FRESH WATER? YOU CAN NOW, SURVEYOR'S 46 GALLON FRESH WATER TANK ALLOWS YOU TO CAMP LONGER.



## UTILITY CENTER (FW)

OUR CENTRALIZED UTILITY CENTER PROVIDES ALL OF YOUR HOOK-UPS IN ONE CONVENIENT LOCATION. STANDARD ON ALL FIFTH WHEELS.

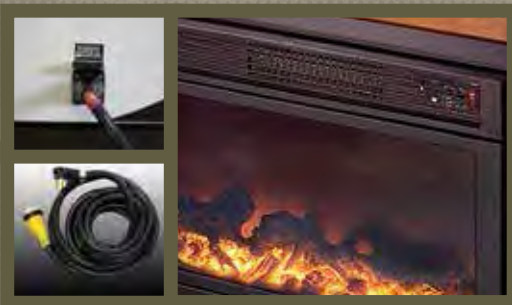

## FIREPLACE AND 50 AMP SERVICE

STANDARD ON FIFTH WHEELS OPTIONAL TRAVEL TRAILERS. NO WORRIES ABOUT HAVING ENOUGH POWER TO RUN ALL OF YOUR APPLIANCES. THE FIREPLACE OFFERS ADDITIONAL ELECTRIC HEAT, SAVES ON YOUR PROPANE COSTS.

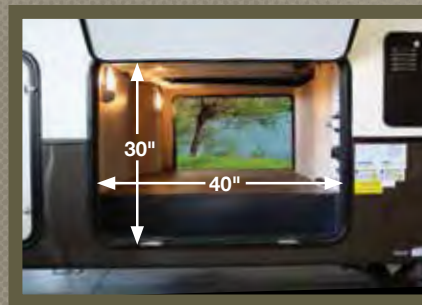

## EXTERIOR STORAGE

OUR FIFTH WHEELS GIVE YOU EVEN MORE ROOM WITH OUR 40" X 30" STORAGE DOOR AND OUR "Z" FRAME DESIGN, LARGEST STORAGE IN ITS CLASS.



## LED AWNING LIGHT

THE INTEGRATED LED AWNING LIGHT PROVIDES YOU WITH AN ABUNDANCE OF LIGHT FOR ADDED SAFETY AND SECURITY. (STANDARD IN EXTERIOR LUXURY PACKAGE)



## 82.5" INTERIOR HEIGHT (TRAVEL TRAILERS)

OUR BARRELED ROOF GIVES YOU THE HEIGHT YOU DESERVE. THE 82 1/2" INTERIOR HEADROOM IS ONE OF THE HIGHEST IN ITS CLASS. THE RADIUS ALUMINUM ROOF RAFTERS ARE ON 16" CENTERS.



## STAINLESS STEEL APPLIANCES

JUST ONE OF THE MANY UPGRADES YOU'LL FIND IN SURVEYOR. OUR STAINLESS STEEL APPLIANCES GIVE YOU MORE OF A RESIDENTIAL LOOK.



## 60" X 80" BED

WE GIVE YOU THE EXTRA ROOM SO YOU CAN STRETCH OUT AND NOT HAVE YOUR FEET HANGING OFF THE END OF THE BED. WE CAN EVEN PROVIDE YOU AN UPGRADED SERTA™ MATTRESS FOR EVEN MORE COMFORT.



## CABINETS

OUR TWO-TONE SHAKER STYLE SOLID WOOD CABINERY WITH CONCEALED HINGES, LARGE HANDLE PULLS AND DRAWERS WITH FULL EXTENSION GLIDES GIVES YOU HIGH END AMENITIES AND A VALUE PRICE.

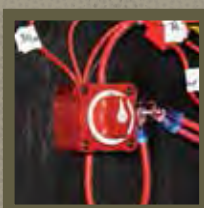

## BATTERY DISCONNECT

STANDARD IN ALL FIFTH WHEELS, THIS CONVENIENT SWITCH LETS YOU POWER DOWN ALL 12V.



## HEATED AND ENCLOSED UNDERBELLY

SURVEYOR'S AERODYNAMIC UNDERBELLY IS HEATED AND ENCLOSED. (251RKS AND UP) THE ENTIRE UNDERBELLY IS WARMED BY RADIANT HEAT FROM THE HEAT DUCT ALLOWING YOU TO USE THE COACH IN COLDER WEATHER ENVIRONMENTS. THIS UNIQUE CONSTRUCTION METHOD OPENS UP STORAGE SPACE ABOVE THE FLOOR, WHILE LOWERING THE UNITS' CENTER OF GRAVITY FOR TOWING EASE AND STABILITY.



## LED LIGHT

- MORE RESIDENTIAL
- BRIGHTER LIGHTING AND LESS AMPERAGE, SO YOU'RE USING LESS BATTERY POWER
- RECESSED LED LIGHTING IS STANDARD IN ALL MODELS (N/A 2940BLE)



## DECORS



PEBBLE



SLATE



JAVA

## APPLIANCES/EQUIPMENT

	EXPANDABLES	TRAVEL TRAILERS	FIFTH WHEELS
Dometic, G/E Flush-Mount Refrigerator	ILP	ILP	ILP
Power Range Hood w/ Light	X	X	X
Six Gallon G/E DSI Water Heater w/ Quick Recovery	ILP	ILP	ILP
Three Burner Range Top	X	X	X
17" Gas Oven with Piezo Ignition (Where Applicable)	X	X	X
22" Gas Oven with Piezo Ignition (Where Applicable)	N/A	X	X
Microwave Oven	X	X	X
Stainless Steel Appliances	ILP	ILP	ILP
20,000 BTU Furnace (Ducted 23'-26')	X	X	N/A
30,000 BTU Ducted Furnace (27' and Above)	N/A	X	X
13.5K Air Conditioning (Ducted ALL MODELS)	X	X	N/A
15K Air Conditioning (Ducted ALL MODELS)	N/A	O	ELP
Digital Wall Thermostat	X	X	X
Stereo CD/DVD with MP3/SD Card/USB Ports and Remote Control	ILP	N/A	N/A
12V Sound Bar FM Stereo/Bluetooth with 4 Zone Speakers (N/A 294QBLE)	N/A	ILP	ILP
Sony CD/DVD Player	N/A	ILP	ILP

## BATH

Fiberglass Tub/Shower	X	X	X
Adjustable Shower Head/Faucet	X	X	X
Lavatory Sink and Faucet	X	X	X
Wood Medicine Cabinet with Mirror	X	X	X
Thetford Commode with Foot Flush	X	X	X
Skylight in Tub/Shower	ILP	ILP	ILP
Monitor Panel	X	X	X

## CONSTRUCTION

Full Aluminum Cage Construction	X	X	X
Full Walk on Roof	X	X	X
Barreled Roof with Aluminum Trusses			
16" on Center (82 1/2" of headroom)	X	X	N/A
3/8" Decking	X	X	X
1-1/2" Laminated Sidewalls (R7) (Select models)	X	X	N/A
2" Laminated Sidewalls (R9) (Select models)	N/A	X	X
2" Laminated Floor (R9)	X	X	X
Electric Slide-Out Mechanism with/ Manual Override	N/A	X	X

## ELECTRICAL

Detachable 28', 30-amp Power Cord	ELP	ELP	N/A
Detachable 28', 50-amp Power Cord	N/A	O	ELP
Outside TV Bracket (N/A 294QBLE)	N/A	X	X
Cable Connection on Door Side	X	X	X
55 amp Converter with Charger	X	X	X
Exterior 120 volt Recept	X	X	X
Patio Light with Amber Lens	X	X	X
Hitch Light	X	N/A	N/A
LED Hitch Docking Lights	N/A	X	X
Pass Thru LED Storage Light	X	X	X
LED Interior Lighting	X	X	X
120-volt GFI Protected Circuit Safety	X	X	X
Cable & Satellite Ready	ELP	ELP	ELP
Utility Center	N/A	N/A	ELP

## EXPANDABLE BEDS

Attached Vinyl Weathershield Tent(s)	X	N/A	N/A
Automotive Rubber Gasket and Compression Latches	X	N/A	N/A
Quilted Bunk Cushions	X	N/A	N/A
Radius Door w/ Hinge	X	N/A	N/A
1,000# Capacity	X	N/A	N/A

## SAFETY

Break-Away Switch	X	X	X
Fire Extinguisher	X	X	X
LP Detector	X	X	X
Smoke Detector	X	X	X
Ground Fault Protected Electrical Circuit(s)	X	X	X
Dead-Bolt Door Lock	X	X	X
Safety Chains	X	X	N/A
CO <sup>2</sup> Detector	X	X	X
Tinted Safety Glass	X	X	X

## EXTERIOR

One Piece Roof Membrane	X	X	X
Radius Corner Windows	X	X	X
Flush Mount Outside Storage Compartment(s) w/ Rubber D-Seal	X	X	X
Flush Mount "Slam Latch" Outside Storage Compartment(s) w/ Rubber D-Seal	N/A	N/A	X
Self-Storing Double Entrance Step(s)	X	X	N/A
Self-Storing Triple Entrance Steps (Select models)	N/A	X	X
Butyl Tape Sealant on Seams	X	X	X
Combination Entrance/Screen Door w/ Dead-Bolt Lock	X	X	X
Premier Exterior Graphics	X	X	X
20# LP tanks w/ Molded Cover	X	ELP	30#
Enclosed Underbelly	N/A	X	N/A
Heated Enclosed Underbelly (Select models)	N/A	X	X
Extended Drip Rail and Down Spout	X	X	X
Electric Awning w/ Adjustable Rain Dump	ELP	ELP	ELP
LED Awning Light	ELP	ELP	ELP
Power Stabilizer Jacks	N/A	O	STD
Omni-Directional TV Antenna	X	X	X
Dual Battery Rack	X	X	X
4" Square Bumper w/ Sewer Hose Storage	X	X	X
Outside Shower (N/A 294QBLE)	ELP	ELP	ELP
Spare Tire w/ Carrier	X	X	X
Large Folding Assist Handle	O	ELP	ELP

## INTERIOR

Deep Double-Bowl Kitchen Sink w/ High Rise Faucet	X	X	X
Under Mount Sink	N/A	X	X
Seamless Kitchen Countertops	N/A	X	N/A
Solid Surface Kitchen Countertops	N/A	N/A	X
Stove and Sink Cover(s)	O	X	X
Knife Block Behind Stove	X	X	X
Panoramic Galley Window	X	X	X
Designer Carefree® Flooring	X	X	X
Solid Lumber Core Cabinet Fronts Assembled w/ Screws	X	X	X
Shaker Style Cabinet Doors w/ Concealed Hinges	ILP	ILP	ILP
Screwed & Glued Cabinetry	X	X	X
Residential Style Wood Drawers w/ Ball Bearing Glides	X	X	X
In-Floor Heat Ducts (Where available)	N/A	X	X
82 1/2" Interior Height	X	X	N/A



EXPANDABLES

TRAVEL TRAILERS

FIFTH WHEELS

80# Gas Bed Struts (Queen beds)	N/A	X	X
Adjustable Shelves in Pantry (Where applicable)	X	X	X
Ceiling Light Switch at Entrance Door	X	X	X
60"x 80" Queen Beds	ILP	ILP	ILP
Shaw® Stain and Soil Resistant Carpet	N/A	X	X

## PLUMBING

Black Tank Flush	ELP	ELP	ELP
Color-Coded Water Lines	X	X	X
Copper Gas Lines, Double Flared	X	X	X
Rotocast Holding Tanks, Underfloor	X	X	X
Rotocast Fresh Water Tank, Underfloor	X	X	X
Demand Waterpump, 12-volt	X	X	X
City Water Fill	X	X	X
Gravity Water Fill	X	X	X
Water Heater Bypass Kit	X	X	X
Winterization Kit	X	X	X

## RUNNING GEAR

Super-Lube Hubs	X	X	X
Galvanized Steel Wheel Wells	X	X	X
Equa-Flex Suspension System (N/A 191T)	O	O	O
Leaf Spring Axle(s)	X	X	X
Radial Trailer Tires	X	X	X
Nitrogen Filled Tires	X	X	X
Nev-R-Adjust® Electric Brakes, All Wheels	X	X	X
Tough, Powder Coated Frame	X	X	X
2-5/16" Coupler	X	X	N/A
205/75/R14C Tires (Model specific)	X	X	N/A
225/75/R15D Tires (Model specific) (191T)	N/A	X	X

## SURVEYOR OPTIONS

Interior Luxury Package	X	X	X
Exterior Luxury Package	X	X	X
15K Air Conditioner IPO 13.5 BTU A/C	N/A	O	ELP
13.5K Air Conditioner Bedroom	N/A	O	O
Serta® Mattress	N/A	O	O
Wood Planked Vinyl Flooring	O	O	O
Wood Blinds in Living Room	SP	SP	SP
Pleated Night shades	N/A	SP	SP
Roof Ladder (N/A 226RBDS)	N/A	O	O
Jensen 32" LED TV	N/A	ILP	N/A
Jensen 39" LED TV (N/A 264RKS)	N/A	O	ILP
Fantastic Fan	N/A	O	O
Hide-A-Bed Sofa (Select models)	N/A	O	X
Arctic Package (12V heat pads)	N/A	O	O
Power Tongue Jack	O	O	N/A
Slide-Out Awning Topper(s)	NA	O	O
Power Stabilizer Jacks	N/A	O	ELP
Electric Front Landing Gear w/ Quick Release Pins	N/A	N/A	ELP
Flip Down Bike/Utility Rack	N/A	O	O
8' cu. ft. Refer	N/A	N/A	ILP
Aluminum Wheels	O	SP	SP
Fireplace	N/A	O	X
50-amp Service w/ Detachable Power Cord	N/A	O	X
Dyson Cordless Vacuum	N/A	N/A	X

X = STANDARD EQUIPMENT, O = OPTIONAL, ILP= INTERIOR LUXURY PACKAGE  
ELP = EXTERIOR LUXURY PACKAGE, SP = SIGNATURE PACKAGE

**SURVEYOR WARRANTY INFORMATION** For Details on Surveyor's complete warranty program, see your Surveyor dealer. Surveyor offers the following additional limited warranties to the original purchasers. Consult written warranty for details.

# PACKAGES

## EXPANDABLES

### INTERIOR LUXURY PACKAGE

- 82 1/2" Barreled Ceiling
- Ducted Air Conditioning All Models
- Jensen Bluetooth Stereo with Remote
- Shaker Style Cabinet Doors w/ Recessed Hinges
- Stainless Steel Appliances
- Dometic Double Door Refrigerator w/ Stainless Fronts
- 6 Gallon Gas/Electric DSI Hot Water Heater
- Skylight Over Shower
- 60 X 80 Queen Beds
- 1000 lbs. Bed Capacity
- Quilted Bed Cushions
- LED Interior Lights

### EXTERIOR LUXURY PACKAGE

- Carefree Electric Awning w/ LED Light Bar
- Friction Hinges on Entry Door
- Dual Battery Rack
- 2 - 20lb LP Bottles and ABS Cover
- Detachable Power Cord
- Cable and Satellite Prep
- Four Scissor Stabilizing Jacks
- Spare Tire w/ Carrier and Cover/Nitrogen Filled Tires
- Black Tank Flush
- Outside Shower
- Outside Stereo Speakers
- Larger Holding Tanks 46 Gallon Fresh Water/40 Gallons Grey

## TRAVEL TRAILERS

### INTERIOR LUXURY PACKAGE

- 82 1/2" Barreled Ceiling
- Ducted Air Conditioning All Models
- Jensen 32" LED TV\*
- Bluetooth Stereo w/ Remote/Sony CD DVD Player\*
- 12V 4 Zone Premium Sound Bar and Surround Sound\*
- Shaker Style Cabinet Doors w/ Recessed Hinges
- Stainless Steel Appliances
- Dometic Double Door Refrigerator w/ Stainless Fronts
- 6 Gallon Gas/Electric DSI Hot Water Heater
- Skylight Over Shower
- 60 X 80 Residential Size Queen Bed

### EXTERIOR LUXURY PACKAGE

- Carefree Electric Awning w/LED Light Bar
- 2 - 20lb LP Bottles and ABS Cover
- Detachable Power Cord
- Large Folding Assist Handle\*
- Outside Shower\*
- Black Tank Flush\*
- Fully Enclosed Underbelly
- Outside Stereo Speakers
- Exterior TV Bracket\*
- Cable and Satellite Prep
- Larger Holding Tanks 46 Gallon Fresh Water/40 Gallons Grey

\* N/A 294QBLE

## FIFTH WHEELS

### INTERIOR LUXURY PACKAGE

- Electric Fireplace
- Jensen 39" LED TV
- Bluetooth Stereo w/ Remote/Sony CD DVD Player
- 12V 4 Zone Premium Sound Bar and Surround Sound
- Shaker Style Cabinet Doors w/ Recessed Hinges
- Stainless Steel Appliances
- Dometic 8 CU FT Double Door Refrigerator w/ Stainless Fronts
- 6 Gallon Gas/Electric DSI Hot Water Heater
- Skylight Over Shower
- 60 X 80 Residential Size Queen Bed
- Theater Seating (278RLDS & 293RLTS)

### EXTERIOR LUXURY PACKAGE

- 15K BTU Air Conditioner
- Carefree Electric Awning w/LED Light Bar
- Detachable Power Cord/Cable and Satellite Prep
- Electric Stabilizer Jacks
- Electric Front Landing Gear
- Outside Shower/Black Tank Flush
- 12V Battery Disconnect Switch
- Outside Stereo Speakers/Large Folding Assist Handle
- Slam Latch Baggage Doors
- Built in Utility Center
- Exterior TV Bracket



# Surveyor

by Forest River



**PRE-DELIVERY INSPECTION FACILITY**  
20,000 square feet of quality assurance. The bare essentials for a premium product. This state-of-the-art facility gives immediate daily feedback to production for quality assurance in every unit built.

## 24/7 EMERGENCY ROADSIDE ASSISTANCE

For a worry-free ownership experience Forest River includes one year of Coach-Net RV Technical & Roadside Assistance with each RV purchase. Whether new to the RV lifestyle or an experienced RV enthusiast, Forest River owners have 24/7 access to technical, operational and emergency road service coverage throughout the US & Canada. Coach-Net's fast, dependable service is just a phone call away.

### Coach-Net®

RV Technical & Roadside Assistance



Forest River, Inc. encourages our customers to purchase their Forest River products from a local dealership whenever possible for the following reasons:

- 1) Forest River, Inc. dealers are independently owned and operated businesses so priority service and scheduling is at their discretion and is often provided to customers that purchased their unit at that dealership.
- 2) Purchasing locally allows customers to establish meaningful relationships with a dealer, enhancing the RV experience through assistance with product questions, user tips or RV regulations for your state or country, and much more!
- 3) Canadian customers must meet requirements to bring an RV purchased out of the country to their home. These requirements may involve additional inspections and certifications, taxes and fees. Your local Canadian Dealer is a professional at meeting these requirements.
- 4) Scheduling timely warranty repairs and adjustments through a local dealership provides far greater flexibility and convenience to you, the customer!

It is the goal of Forest River, Inc. that all of our RV owners fully enjoy the RV experience and that customer satisfaction meets or exceeds their expectations!

**FREE MEMBERSHIP**  
to Forest River Owners' Group

[www.forestriverfrog.com](http://www.forestriverfrog.com)



**Learn More**  
Scan this barcode using a QR Reader on your smart phone to learn more about Forest River.



A Berkshire Hathaway company.

Forest River, Inc.  
2405 Century Dr.  
Goshen, IN 46528  
(574) 642-3119  
[www.forestriverinc.com/surveyor](http://www.forestriverinc.com/surveyor)  
[www.forestriveraccessories.com](http://www.forestriveraccessories.com)

**YOUR LOCAL SURVEYOR DEALER**

All information contained in this brochure is believed to be accurate at the time of publication. However, during the model year, it may be necessary to make revisions and Forest River, Inc. reserves the right to make changes without notice, including prices, colors, materials, equipment and specifications as well as the addition of new models and the discontinuance of models shown in this brochure. Therefore, please consult with your Forest River, Inc. dealer and confirm the existence of any material, design or specifications that are material to your purchase decision.