

WOLF PACK



WOLF PACK

TRAVEL TRAILERS & TOY HAULERS





F305WP

SAND

The Wolf Pack by Cherokee is engineered with impeccable quality, distinctive features, superior comfort and remarkable affordability. Wolf Pack offers our customers a chance to escape the ordinary and relax, to enjoy family and friends and to see nature in all its beauty and wonder. These special life moments are the reasons we take such pride in all we do.



21WP120

NATURAL

Unique designs like the 21WP offers customers different storage options to fit their needs. Many customers prefer to keep toys outside their living space and the front deck series of trailers allows customers to do just that. This design also makes clean up easy with it's open grate designed deck customers do not need to remove their toys to clean them off after each use.

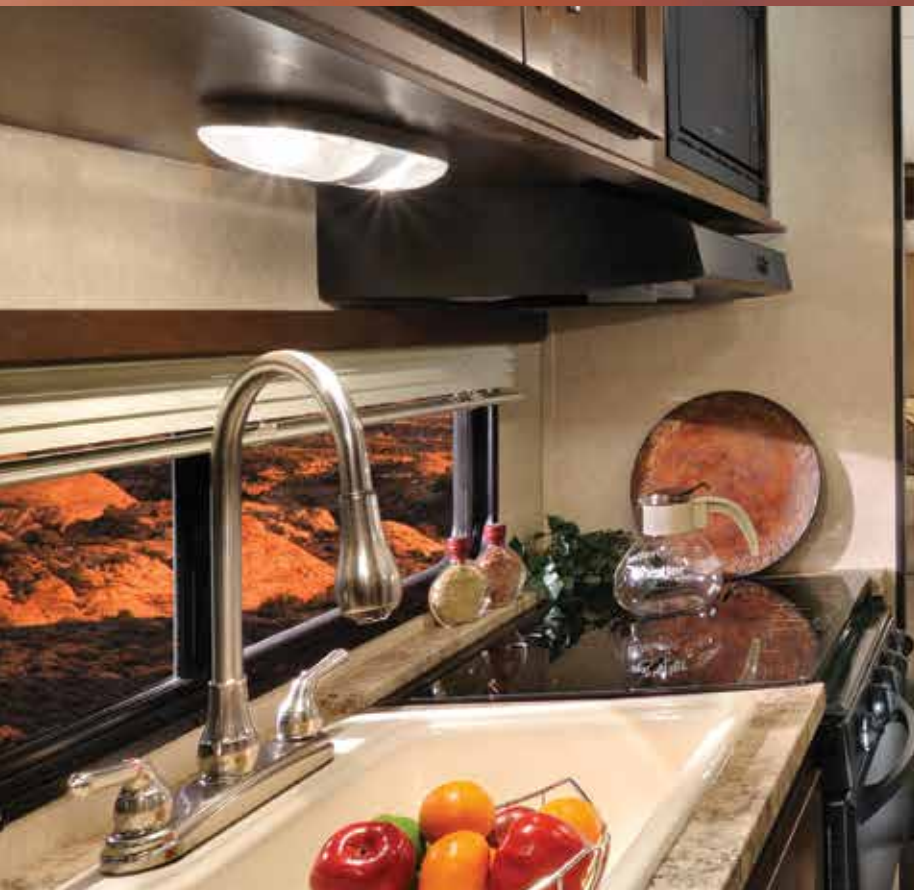

WOLF PACK

INTERIOR FEATURES



A Each Wolf Pack is equipped with ample storage that easily converts to living space once you arrive at your destination.

B Each Wolf Pack is designed with storage in mind. The 28WP floor plan offers a separate room for storage. Like many of our floor plans, this design makes it possible to store outside toys away from your living area. Many Wolf Pack storage areas can be converted from storage to living space with features like drop down power beds, rear screen rooms, and patio deck enclosure systems.

C Large single bowl sinks add style and function offering plenty of room to wash dishes making cleanup a breeze.

D Our smooth roller glide drawers fully extend to make access easy. Each Wolf Pack also includes solid wood drawers. No cheap particle board that will peel back and warp over time.

E Large bathroom sink with large vanity mirror. While many of our competitors like to offer small sinks and small mirrors glued to the wall at Wolf Pack we feel storage, style and space matters.

WOLF PACK

EXTERIOR FEATURES

- I** Wolf Pack's Power Awning, found in our optional Limited Package, provides an easy way to shade the exterior patio area with just a push of a button.
- J** The large, optional exterior scare light gives you a sense of security by illuminating the door and patio area.
- K** The elegant LED strip lighting under the awning rail is offered in the optional Limited Package. This beautiful accent lighting provides a warm and inviting glow to your patio area.
- L** The heavy duty tongue jack found in the optional Limited Package provides you an easy way to load your trailer with a push of a button. (Travel Trailers only)
- M** The radial tires also found in the optional Limited Package provide a smooth ride as you head out on your outdoor excursion.



The graphics on the Wolf Pack are very attractive and are an eye catcher, while the lower, front diamond plate helps prevent stone chips.

WOLF PACK FLOORPLANS

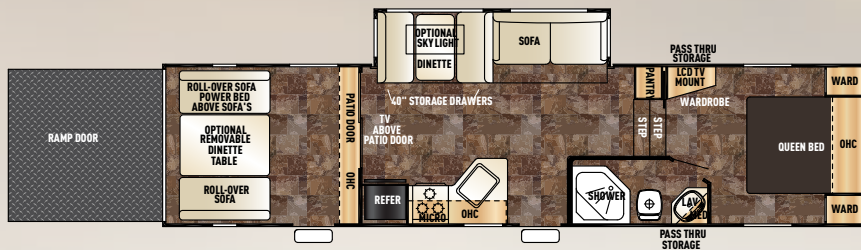
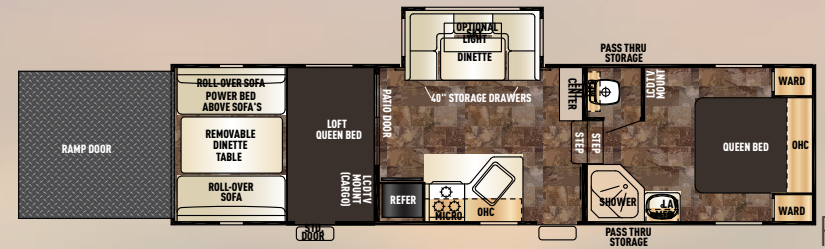
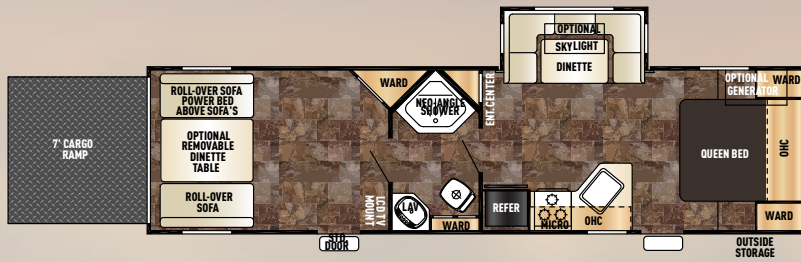
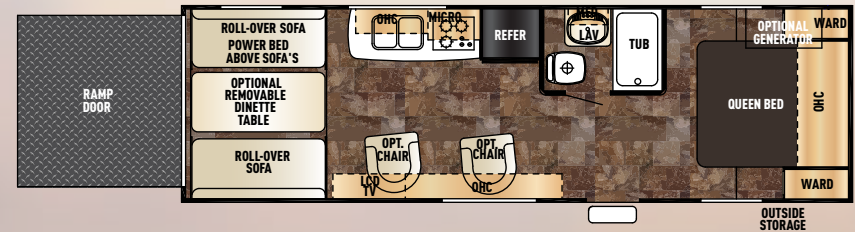
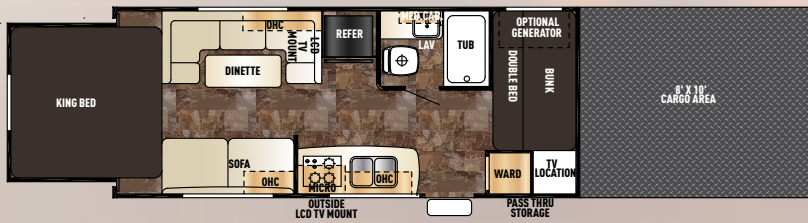
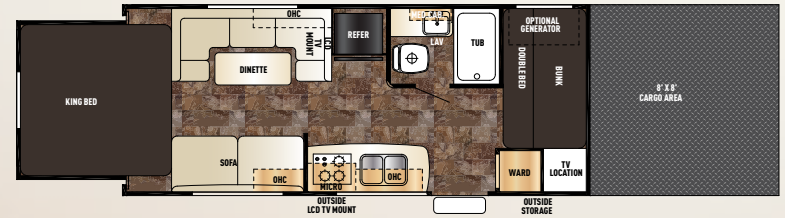
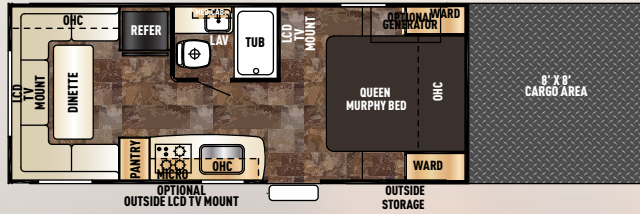

WOLF PACK STANDARDS & OPTIONS

STANDARD EQUIPMENT

- Antenna and hookup
- Power Bath Vent
- 6 Gallon gas water heater
- 13.5K A/C
- Microwave
- Double Door Refer
- Porch Light
- Outside GFI Outlet
- Double Steps/Triple Step (5th Wheel)
- 15" Tires
- 3/8" walkable roof decking
- 5/8" tongue and grove plywood floor decking
- Radius truss roof rafters
- Powder coated frame
- Duel LP Bottles
- Extra Large Safety Glass Windows
- Water heater bypass
- LP Leak Detector
- Carbon Monoxide Detector
- Happy-Jack Bed Lift

OPTIONAL EQUIPMENT

- Full Extension drawer guides
- Wood drawers and drawer fronts
- Large single bowl kitchen sink.
- Spice rack (where available)
- 15k Air Conditioner In Place Of 13.5k Standard
- Axle and Wheel Upgrade (5200)(TT ONLY)
- Detachable Coil Spray Hose
- Industrial Garage Rubber Floor
- Ducted A/C (Std on FW's)
- Enclosed Underbelly
- Gas Pump Fuel Station
- Gel Coat Sidewalls
- Power Bed
- Range Cover
- Screen Wall / Tent Wall
- Sink Cover
- Sky Light Over Tub (mandatory on 19WP)
- Spare Tire

OPTIONAL XL PACKAGE

- Large Exterior Folding Assist Grab Handle
- RVQ Quick Connect
- Bathroom Fantastic Vent Fan
- Night Shades
- Pull Out Kitchen Faucet
- Outside Shower With Hot And Cold Water
- Sky Light Over Tub
- Oven
- 6 Gallon Gas/Electric DSI Water Heater
- Scare Light

LIMITED

OPTIONAL WOLF PACK LIMITED PACKAGE

(See participating dealers for details)

- Power Awning
- Power Tongue Jack (TT Only)
- Drop in Cooktop with Glass Cover
- Enclosed Tanks (Most Models)
- Faux Rock Wall at Entertainment Center (Most Models)
- Under Mount Sink
- Internal LED Light Strip Above Slide Out
- External LED Light Strip Under Awning
- Radial Tires
- Outside TV Bracket and Hook Ups
- High Gloss Seamless Counter Tops

WEIGHTS & MEASURES

TRAVEL TRAILERS

| | T20WP | T21WP | T21WP120 | T27WP | T28WP |
|-------------------------|----------|----------|----------|----------|----------|
| DRY HITCH WEIGHT | 645 LBS | 604 LBS | 650 LBS | 850 LBS | 980 LBS |
| UNLOADED VEHICLE WEIGHT | 5898 LBS | 5993 LBS | 6272 LBS | 6275 LBS | 7418 LBS |
| GVWR W/BRAKES | 7645 LBS | 7604 LBS | 7650 LBS | 7850 LBS | 9985 LBS |
| CARGO CARRYING CAPACITY | 1709 LBS | 1611 LBS | 1378-LBS | 1575 LBS | 2567 LBS |
| EXTERIOR LENGTH | 34' | 34' | 35'-10" | 31' | 34' 8" |
| EXTERIOR HEIGHT W/ AC | 11'-3" | 11'-3" | 11'-3" | 12'-4" | 12'-4" |
| EXTERIOR WIDTH | 102" | 102" | 102" | 102" | 102" |
| BEDROOM INTERIOR HEIGHT | 78" | NA | 78" | 78" | 78" |
| GREY CAPACITY | 38-GAL | 38-GAL | 38-GAL | 38-GAL | 38-GAL |
| BLACK CAPACITY | 38-GAL | 38-GAL | 38-GAL | 28-GAL | 38-GAL |
| FRESH CAPACITY | 50GAL | 50GAL | 50GAL | 50GAL | 50GAL |
| CARGO AREA SIZE-OFF DS | 96" | 96" | 120" | 84" | 120" |
| CARGO AREA SIZE-DS | 96" | 96" | 120" | 269" | 120" |
| STORAGE HEIGHT | NA | NA | NA | 93" | 93" |

FIFTH WHEELS

| | F305WP | F315WP | F375WP |
|-------------------------|-----------|-----------|--------|
| DRY HITCH WEIGHT | 1950 LBS | 2210 LBS | TBA |
| UNLOADED VEHICLE WEIGHT | 9502 LBS | 10197 LBS | TBA |
| GVWR W/BRAKES | 12110 LBS | 12370 LBS | TBA |
| CARGO CARRYING CAPACITY | 2570 LBS | 2135 LBS | TBA |
| EXTERIOR LENGTH | 34' 4" | 36'-11" | TBA |
| EXTERIOR HEIGHT W/ AC | 13' 5" | 13' 5" | TBA |
| EXTERIOR WIDTH | 102" | 102" | TBA |
| BEDROOM INTERIOR HEIGHT | 76" | 76" | TBA |
| GREY CAPACITY | 38-GAL | 38-GAL | TBA |
| BLACK CAPACITY | 38-GAL | 38-GAL | TBA |
| FRESH CAPACITY | 104GAL | 104GAL | TBA |
| CARGO AREA SIZE-OFF DS | 126" | 120" | TBA |
| CARGO AREA SIZE-DS | 126" | 120" | TBA |
| REAR STORAGE HEIGHT | 102" | 102" | TBA |



EXPERIENCE THE FUN WITH WOLF PACK.



Forest River, Inc. encourages our customers to purchase their Forest River products from a local dealership whenever possible for the following reasons:

- 1) Forest River, Inc. dealers are independently owned and operated businesses so priority service and scheduling is at their discretion and is often provided to customers that purchased their unit at that dealership.
- 2) Purchasing locally allows customers to establish meaningful relationships with a dealer, enhancing the RV experience through assistance with product questions, user tips or RV regulations for your state or country, and much more!
- 3) Canadian customers must meet requirements to bring an RV purchased out of the country to their home. These requirements may involve additional inspections and certifications, taxes and fees. Your local Canadian Dealer is a professional at meeting these requirements.
- 4) Scheduling timely warranty repairs and adjustments through a local dealership provides far greater flexibility and convenience to you, the customer!

It is the goal of Forest River, Inc. that all of our RV owners fully enjoy the RV experience and that customer satisfaction meets or exceeds their expectations!



PRE-DELIVERY INSPECTION FACILITY

20,000 square feet of quality assurance. The bare essentials for a premium product. This state-of-the-art facility gives immediate daily feedback to production for quality assurance in every unit built.



Learn More

Scan this barcode using a QR Reader on your smart phone to learn more about Forest River.



A Berkshire Hathaway company.



YOUR WOLF PACK DEALER

All illustrations and specifications contained in this literature are based on the latest product information at time of publication. Forest River reserves the right to make changes in prices, colors, materials, equipment and specifications at anytime without notice and assumes no responsibility for any error in this literature. All units are shipped F.O.B. Goshen, Indiana. CONSULT YOUR LOCAL DEALER FOR WARRANTY INFORMATION. LITHO: U.S.A. FOR 1210