

# HYPER LITE XLR

## Toyhaulers

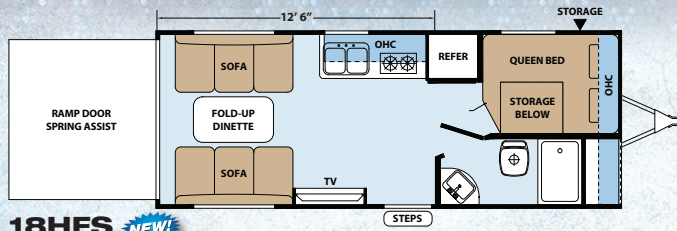

**18HFS** **NEW!**

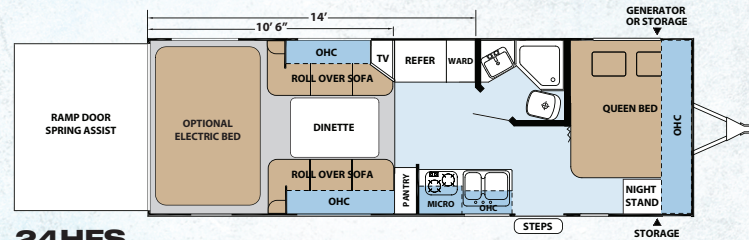

**24HFS**

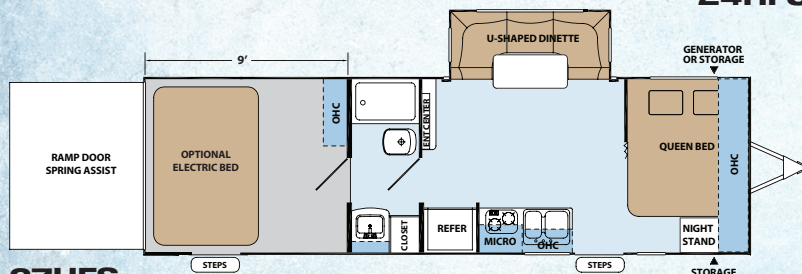

**27HFS**



**3 Recliner Sofa Opt**

Available on 27HFS, 29HFS, and 30HDS

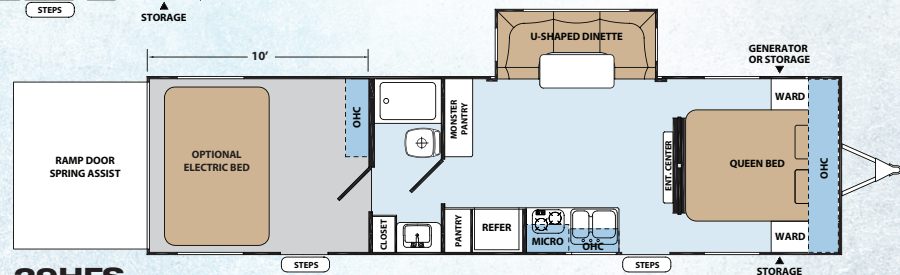

**29HFS**

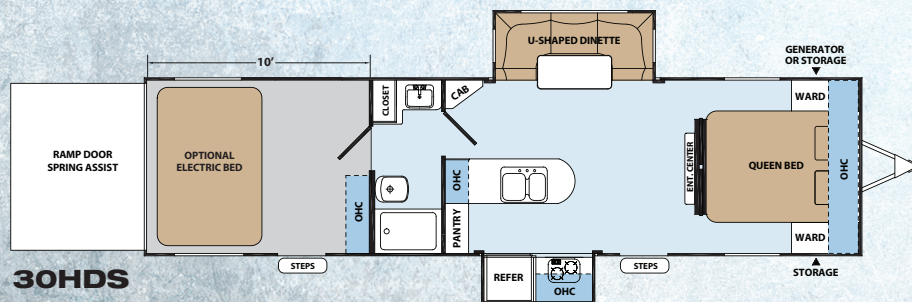

**30HDS**

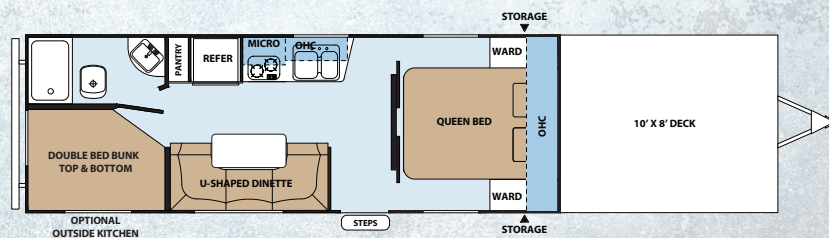

**31FDK**

# XLR Hyper Lite Standards & Options

## Interior Standards

- Professionally Designed Interiors – Chestnut, Raven
- New Vinyl Flooring – Birch Wood Grain
- Espresso Cabinetry Shaker Style (Glass Inserts Where Applicable)
- Brushed Nickel Hardware
- LED Lighting
- Bedroom USB Charging Station
- AM/FM/CD/DVD/Bluetooth Stereo
- Interior Speakers
- Dual Ram Air Vents
- Laminated Countertops
- 2-Burner Cooktop
- Microwave
- High Rise Kitchen Faucet
- Stainless Steel Double Sink with Sink Covers
- Rounded Shower Rod w/Designer Shower Curtain
- Dometic 6 Cu. Ft. Double Door Refrigerator
- Gas/Electric/DSI Water Heater (6 Gallon)
- Porcelain Foot Flush Toilet
- Ducted Heat & A/C
- 12V Battery Disconnect
- Plywood Decking
- Full Height Ceilings
- Rear Cargo Friction Hinge Entry Door
- 5,000 lb. Steel Reinforced Tie Downs
- TV Antenna with Booster
- Night Shades in Living Room and Bedroom
- Shower/Tub Surround
- Skylight over Shower/Tub
- Gas/Oil Resistant Flooring in Cargo Area

## Exterior Standards

- Reverse Activated Rear LED Flood Lights
- Framed Tinted Safety Glass Windows
- LED Lighting
- Radius Friction Hinge Entry Door
- Secure Utility Convenience Center
- Front Diamond Plate Rock Guard
- Radius Baggage Doors
- Dexter E-Z Lube® Axles
- NitroFill™ Radial Tires
- 30 AMP Service
- Dual 20 lb. LP Bottles with Cover
- Four Corner Manual Stabilizer Jacks
- 96" Wide Construction
- 8" Powder Coated, I-Beam Chassis
- ¾" Grade Plywood Flooring
- Vacuum Bonded Sidewalls with Block Foam Insulation
- 7" Insulated Spring Assist Ramp Door
- Enclosed Underbelly
- Radiant Foil Insulation (Roof/Floor)
- Full Walk On Roof
- Rain Gutter Spouts
- Exterior Marine Grade Speakers
- Cargo Entry Door (Select Models)
- Hot/Cold Outside Shower/Spray Port
- Black Tank Flush
- Grey Rubber Roof (One Piece)
- Satellite Prep

## Options

- **Kick Start Package: (Mandatory)**  
13.5K BTU Ducted A/C, Spare Tire, Black Diamond Plate, Premium Graphics, Beauflor Birch Wood Panel Vinyl Flooring, Two Tone Grey Fiberglass, Electric Awning with LED Lights, Aluminum Wheels, LED Lighting, Black Tank Flush, LP Quick Disconnect (31FDK only with outside kitchen option), Equa-Flex Suspension Enhancement, Friction Hinge Entry Door, Solar Charger Input, Exterior TV Bracket, Hide-N-Screen (N/A 31FDK), 35K BTU Furnaces (N/A 18HFS, 24HFS, 31FDK)
- **2016 Adrenaline Package:**  
NEO Blue Lights Under Entry Steps, Hidden Hinges on Cabinetry, Wainscoting in Garage, Stainless Steel Appliances, Radiant Roof/Floor/Slide Out Floor/Front Insulation (R-38 @ 80°F), Shaker Style Passage Doors
- **Extreme Weather Package:**  
Dual Pane Windows, 12V Heated Holding Tanks,
- **Off Grid Prep:**  
Generator Prep, Mobile Fuel Station
- **Off Grid Package:**  
4.0 Onan Gas Generator, Generator Prep, Mobile Fuel Station, 30 Gal. Tank
- **Additional Options**
  - Power Tongue Jack
  - 15K BTU A/C IPO 13.5K
  - 32" LED TV (Living, Bedroom, Garage)
  - Recliner Sofa IPO U-Dinette (27HFS, 29HFS, 30HDS)
  - Electric Bed(s)
  - Max Clearance Pass Thru Dinette
  - Electric Bed w/ Max Clearance Pass-thru Dinette
  - VIP Party Deck (No Awning)
  - Outdoor Kitchen (31FDK only)

MODEL	18HFS	24HFS	27HFS	29HFS	30HDS	31FDK
Hitch Weight	960	577	992	1032	1314	629
UVW	5123	5526	5728	6759	7631	6284
Cargo Capacity	4637	3792	3947	3014	2445	3157
Exterior Length	24' 1"	27' 5"	30' 0"	33' 11"	35' 8"	38' 7"
Exterior Height	11' 2"	11' 2"	11' 2"	11' 2"	11' 2"	11' 2"
Exterior Width	96	96	96	96	96	96
Fresh Water	54	54	54	54	54	54
Grey Water	30	57	57	57	57	86
Black Water	30	32	32	32	32	32

**GVWR (Gross Vehicle Weight Rating)** - is the maximum permissible weight of the unit when fully loaded. It includes all weights, inclusive of all fluids, cargo, optional equipment and accessories. For safety and product performance do NOT exceed the GVWR.

**GAWR (Gross Axle Weight Rating)** - is the maximum permissible weight, including cargo, fluids, optional equipment and accessories that can be safely supported by a combination of all axles.

**UVW (Unloaded Vehicle Weight)\*** - is the typical weight of the unit as manufactured at the factory. It includes all weight at the unit's axle(s) and tongue or pin and LP Gas. The UVW does not include cargo, fresh potable water, additional optional equipment or dealer installed accessories.

**CCC (Cargo Carrying Capacity)\*\*** - is the amount of weight available for fresh potable water, cargo, additional optional equipment and accessories. CCC is equal to GVWR minus UVW. Available CCC should accommodate fresh potable water (8.3 lbs. per gallon). Before filling the fresh water tank, empty the black and gray tanks to provide for more cargo capacity.

\*Estimated Average based on standard build optional equipment. \*\*Estimated average based on standard build optional equipment.

Each Forest River RV is weighed at the manufacturing facility prior to shipping. A label identifying the unloaded vehicle weight of the actual unit and the cargo carrying capacity is applied to every Forest River RV prior to leaving our facilities.

The load capacity of your unit is designated by weight, not by volume, so you cannot necessarily use all available space when loading your unit.



Learn More  
Scan this barcode using  
a QR Reader on your  
smart phone to learn  
more about Forest River.



A Berkshire Hathaway company

#XLRtoys haulers



## XLR by Forest River

2421 Century Drive ■ Goshen, IN 46528  
E-mail: [XLRinfo@forestriverinc.com](mailto:XLRinfo@forestriverinc.com)  
Phone: 574-642-0438 ■ Fax: 574-343-5909  
[www.forestriverinc.com/XLR](http://www.forestriverinc.com/XLR)  
[www.forestriveraccessories.com](http://www.forestriveraccessories.com)



Actual towing capacity is dependent on your particular loading and towing circumstances, which includes GVWR, GAWR and GCWR, as well as adequate trailer brakes. Please refer to the Owners Manual of your vehicle for further information. All information contained in this brochure is believed to be accurate at the time of publication. However, during the model year, it may be necessary to make revisions and Forest River, Inc., reserves the right to make all such changes without notice, including prices, colors, materials, equipment and specifications as well as the addition of new models and the discontinuance of models shown in this brochure. Therefore, please consult with your Forest River dealer and confirm the existence of any materials, design or specifications that are material to your purchase decision. ©2015 XLR a Division of Forest River, Inc., a Berkshire Hathaway company. All Rights Reserved. 1/16