

*Camping... a Genuine Classic*



# A GENUINE CLASSIC

# Rpod

BY FOREST RIVER

*Camping...  
a Genuine Classic*





RP-179  
Seaglass Interior

## *Take the fun with you.*

Your practical side will appreciate R•pod's affordable luxury at the lowest tow weight in its class. Your adventurous side will love R•pod's unique shape and construction.





# Where form follows function

The R•pod comes standard with a 4.2 cubic foot 3-way refrigerator that provides you with enough space for all those extended camping vacations.

R•pod's interior comes equipped with residential cabinetry, hardwood drawers and expandable cargo netting for additional storage wherever possible.



RP-180  
Latte Interior

# Features Galore

- 1 Aluminum Wheels, Torsion Axle and Self Adjusting Brakes 2 Black Tank Flush  
 3 Diamond Plate 4 LED Lights/Spoiler and 1-piece Fiberglass Roof  
 5 Spare Tire 6 Fantastic Fan 7 Large Folding Grab Handle  
 8 Collapsible Hanging Rod 9 Automatic Flip Foot

MODEL	RP-171	RP-172	RP-176	RP-176T	RP-177	RP-178	RP-179	RP-180	RP-182G	RP-183G
UNLOADED VEHICLE WEIGHT	2224	2147	2564	2724	2437	2554	2649	2618	2785	2765
HITCH WEIGHT	225	244	286	291	245	257	285	290	379	300
CARGO CARRYING CAPACITY	1001	1097	1222	1067	1308	1203	1136	1172	1094	1035
EXTERIOR LENGTH W/O SPARE TIRE	184"	184"	200"	200"	188"	200"	200"	200"	200"	200"
EXTERIOR POD WIDTH	65"	65"	65"	65"	65"	65"	65"	65"	65"	65"
EXTERIOR OVERALL WIDTH	8'0"	8'0"	8'0"	8'0"	8'0"	8'0"	8'0"	8'0"	8'0"	8'0"
EXTERIOR HEIGHT	8'7"	8'7"	8'8"	8'8"	8'8"	8'8"	8'8"	8'8"	8'8"	8'8"
EXTERIOR HEIGHT W/ A/C	9'6"	9'6"	9'7"	9'7"	9'7"	9'7"	9'7"	9'7"	9'7"	9'7"
LP CAPACITY (LBS.)	20	20	20	20	20	20	20	20	20	20
FRESH WATER (GAL.)	36	36	36	36	36	36	36	36	36	36
GREY WATER (GAL.)	35	35	30	30	30	30	30	30	30	30
BLACK WATER (GAL.)	35	35	30	30	30	30	30	30	30	30

GVWR (Gross Vehicle Weight Rating) - is the maximum permissible weight of the unit when fully loaded. It includes all weights, inclusive of all fluids, cargo, optional equipment and accessories. For safety and product performance do NOT exceed the GVWR.

GAWR (Gross Axle Weight Rating) - is the maximum permissible weight, including cargo, fluids, optional equipment and accessories that can be safely supported by a combination of all axles. UVW (Unloaded Vehicle Weight) - is the typical weight of the unit as manufactured at the factory. It includes all weight at the unit's axle(s) and tongue or pin and LP Gas. The UVW does not include cargo, fresh potable water, additional optional equipment or dealer installed accessories.

\*Estimated Average based on standard build optional equipment.

CCC (Cargo Carrying Capacity)\*\* - is the amount of weight available for fresh potable water, cargo, additional optional equipment and accessories. CCC is equal to GVWR minus UVW. Available CCC should accommodate fresh potable water (8.3 lbs per gallon). Before filling the fresh water tank, empty the black and gray tanks to provide for more cargo capacity.

\*\* Estimated average based on standard build optional equipment.

Each Forest River RV is weighed at the manufacturing facility prior to shipping. A label identifying the unloaded vehicle weight of the actual unit and the cargo carrying capacity is applied to every Forest River RV prior to leaving our facilities. The load capacity of your unit is designated by weight, not by volume, so you cannot necessarily use all available space when loading your unit.

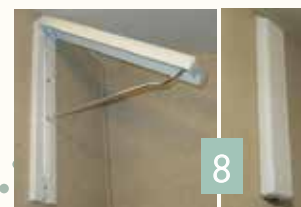
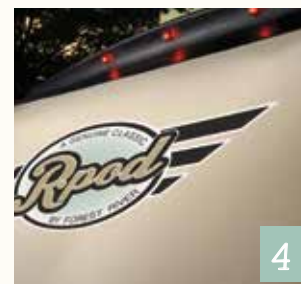
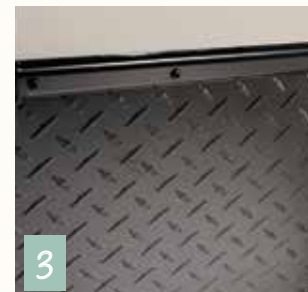



ST - STORAGE PT - PASS THRU

# Floorplans & Specs

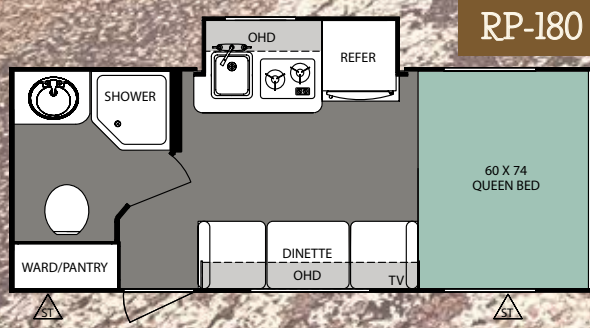
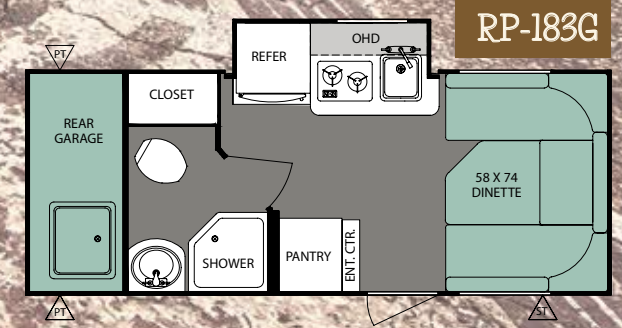
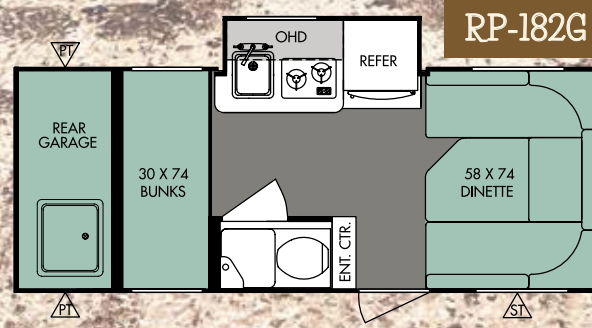
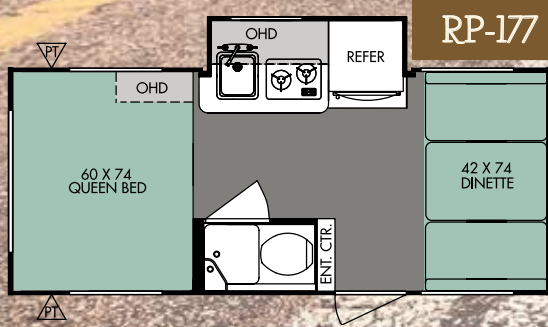
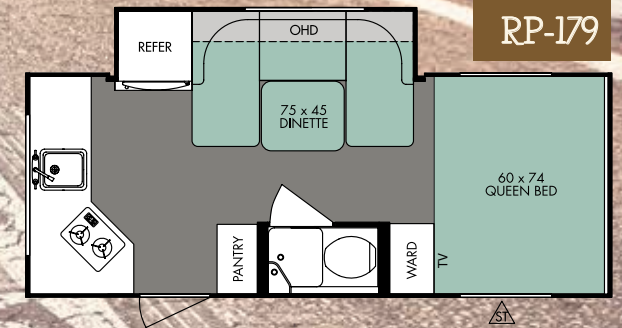
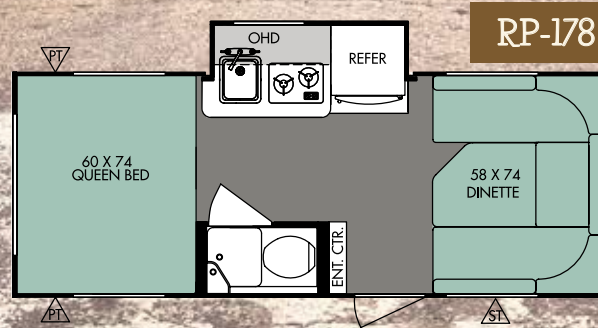
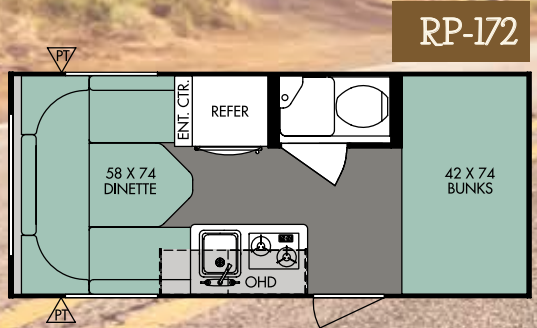
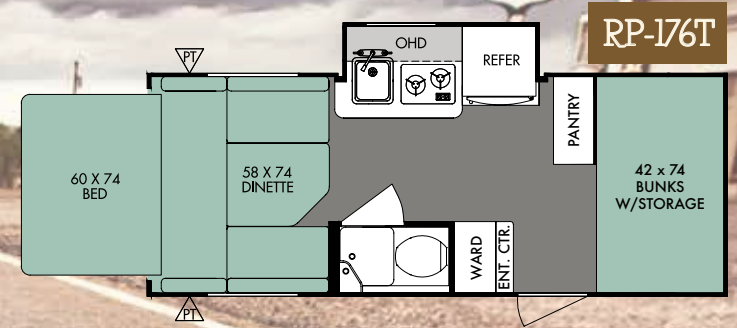
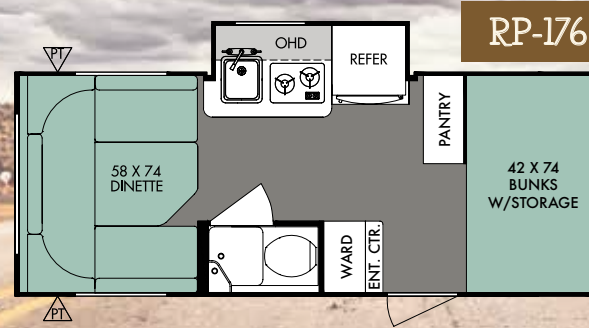
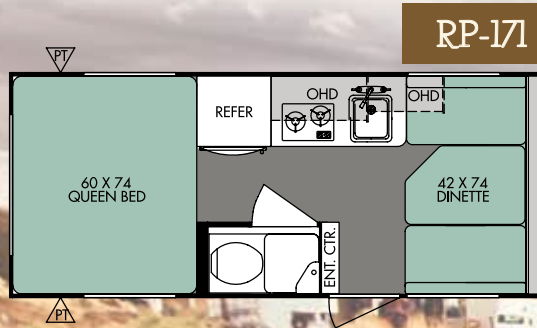





RP-183G  
Seaglass Interior



RP-176 T  
Seaglass Interior



## *Break away from ordinary.*

R•pod's rear garage models with outside entertainment center lets you enjoy the great outdoors. Each garage model comes standard with a 19" flat screen TV, (2) marine grade speakers, and a free standing gas grill. Garage models are equipped with the exclusive Versa-Trac™ sliding storage system with removable wire baskets and hooks. There are also cargo storage nets and an adjustable hanging pocket organizer. The built-in sink with 15' detachable sprayer hose makes clean up a breeze.

## R-POD STANDARDS

### CHASSIS /RUNNING GEAR

- Powder coated steel frame
- 2" coupler
- Self-adjusting electric brakes
- LED taillights
- Independent torsion axle
- Aluminum split spoke wheels
- 205/75/R14 radial tires
- 235/75/R15 off road tires (Hood River Edition only)
- Spare tire
- Super-lube hubs
- Stabilizer jacks (4)
- Dual battery rack
- Rotocast holding tanks
- Rotocast fresh water tank
- Nitrogen filled tires

### APPLIANCES/EQUIPMENT

- Gas/Electric DSI Hot Water Heater
- Water heater by-pass system
- 3-Way refrigerator - 4.2 cu. ft.
- Two burner range top
- 20,000 BTU furnace
- 12 volt water pump
- Monitor panel
- 55 amp converter w/ charger
- Detachable power cord - 28'
- Air conditioner ready
- 3 speed Fantastic Fan
- Thetford® toilet

### SAFETY

- Breakaway switch
- Fire extinguisher
- LP detector
- Smoke detector
- CO detector
- Safety chains
- Dead-bolt door lock
- Ground fault protected electrical circuit

### INSULATION

- Sidewalls R-7
- Floor R-9
- Roof R-9

### BIKE RACK

- R-Pods only authorized
- 2 place bike rack. (optional)

### INTERIOR

- 6' 6" interior height
- Wet bath w/ integrated toilet & sink
- Dry Bath (180 & 183G only)
- No-wax seamless vinyl flooring
- Solid lumber core cabinet fronts assembled with screws
- Grey shaker style cabinetry
- Hardwood drawer fronts w/ full extension ball bearing drawer guides
- Decorative window treatments
- Decorative shower curtain w/ tieback
- Mini blinds (where applicable)
- Pleated night shades (where applicable)
- Collapsible clothes hanger (where applicable)
- Bathroom pocket organizers
- AM/FM/CD/DVD Stereo
- Bluetooth stereo (N/A 182G & 183G)
- Wood slideout fascia

### EXTERIOR

- Custom tinted safety glass windows
- 20# LP tank w/ cover
- Patio light w/ amber lens
- Exterior 120 volt recept
- License plate holder w/ light
- Welded aluminum sidewalls & floor
- Laminated sidewalls, floor & roof
- Seamless fiberglass roof
- Radius entrance and baggage doors
- Folding assist grab handle
- Entry door step
- Black tank flush
- Rear spoiler w/ L.E.D. clearance lights
- TV antenna
- Black powder coated fender skirts w/LED lights
- Magnetic baggage door catches
- 2-tone gel-coated exterior fiberglass
- Outside speakers
- Schwintek™ slide out system

## CAMPER-FRIENDLY PACKAGE

- Solar panel charge port
- Outside shower
- Automatic flip foot front jack
- LED lighting
- Seamless kitchen countertops w/ stainless steel under mount sink
- Recessed sink cover
- EZ glide dinette table

## R-POD POPULAR FEATURES

- One piece seamless fiberglass roof
- 6' 6" interior height
- Large 30-35 gallon holding tanks
- 20,000 BTU furnace
- 6 gallon G/E DSI water heater
- Independent torsion axle
- Grey shaker style cabinetry
- LED interior lighting
- Aluminum rims
- Tinted safety glass windows
- 3-speed Fantastic Fan
- 4.2 cu. ft. refrigerator
- LED taillights
- Large folding assist grab handle
- Detachable power cord
- Black tank flush
- (4) scissor stabilizer jacks

## R-POD OPTIONS

- 13.5K BTU low profile air conditioner 95 LBS
- Convection microwave 51 LBS
- 19" LCD flat screen TV (STD. RP182G & 183G) 15 LBS
- R-dome awning with screen room 20 LBS
- Bike carrier (2 bikes) 13 LBS
- Hood River Edition (Raised axle & 15" off road tires) (West Coast Production Only)

## R-POD TENT

The R-pod is a perfect example of "form follows function," with its breakthrough tent design featuring the Aqualon™ vinyl. Aqualon™ is a durable and breathable tent material that remains flexible in all climates and is resistant to mildew. Sleeping in a tent never felt so good.



Bike Rack (2 bikes) Optional



## R-POD INTERIOR COLORS



SEAGLASS 1 2



SLATE 1 2



LATTE 1 2

1 = Main  
2 = Secondary







### PRE-DELIVERY INSPECTION FACILITY

20,000 square feet of quality assurance. The bare essentials for a premium product. This state-of-the-art facility gives immediate daily feedback to production for quality assurance in every unit built.



Forest River, Inc. encourages our customers to purchase their Forest River products from a local dealership whenever possible for the following reasons:

- 1) Forest River, Inc. dealers are independently owned and operated businesses so priority service and scheduling is at their discretion and is often provided to customers that purchased their unit at that dealership.
- 2) Purchasing locally allows customers to establish meaningful relationships with a dealer, enhancing the RV experience through assistance with product questions, user tips or RV regulations for your state or country, and much more!
- 3) Canadian customers must meet requirements to bring an RV purchased out of the country to their home. These requirements may involve additional inspections and certifications, taxes and fees. Your local Canadian Dealer is a professional at meeting these requirements.
- 4) Scheduling timely warranty repairs and adjustments through a local dealership provides far greater flexibility and convenience to you, the customer!

It is the goal of Forest River, Inc. that all of our RV owners fully enjoy the RV experience and that customer satisfaction meets or exceeds their expectations!

### 24/7 EMERGENCY ROADSIDE ASSISTANCE

For a worry-free ownership experience

Forest River includes one year of Coach-Net RV Technical & Roadside Assistance with each RV purchase. Whether new to the RV lifestyle or an experienced RV enthusiast, Forest River owners have 24/7 access to technical, operational and emergency road service coverage throughout the US & Canada. Coach-Net's fast, dependable service is just a phone call away.

## Coach-Net®

RV Technical & Roadside Assistance

Forest River owners have 24/7 access to technical, operational and emergency road service coverage throughout the US & Canada. Coach-Net's fast, dependable service is just a phone call away.



Optional R-Dome

## FREE MEMBERSHIP

to Forest River Owners' Group

[www.forestriverfrog.com](http://www.forestriverfrog.com)



R-pod Division  
Forest River, Inc.  
2405 Century Dr.  
Goshen, IN 46528  
(574) 642.3119

[www.forestriverinc.com/rpod](http://www.forestriverinc.com/rpod)  
[www.forestriveraccessories.com](http://www.forestriveraccessories.com)



#### Learn More

Scan this barcode using a QR Reader on your smart phone to learn more about Forest River.



A Berkshire Hathaway company.

All information contained in this brochure is believed to be accurate at the time of publication. However, during the model year, it may be necessary to make revisions and Forest River, Inc., reserves the right to make all such changes without notice, including prices, colors, materials, equipment and specifications as well as the addition of new models and the discontinuance of models shown in this brochure. Therefore, please consult with your Forest River dealer and confirm the existence of any materials, design or specifications that are material to your purchase decision. 03/16

©Copyright 2016 Forest River Inc – All Rights Reserved.

Your local r-pod dealer