

XLR THUNDERBOLT

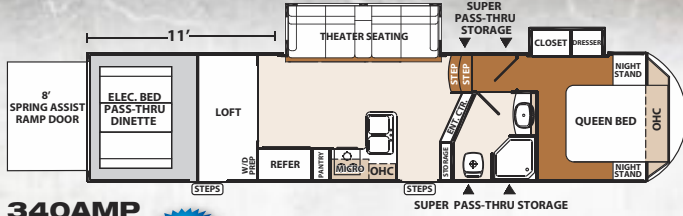

340AMP *NEW!*

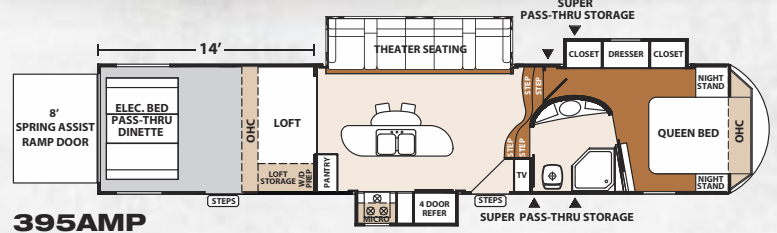

395AMP

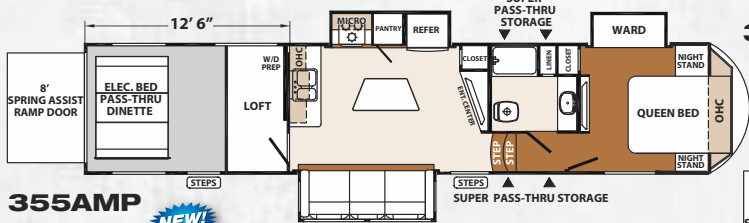

355AMP *NEW!*

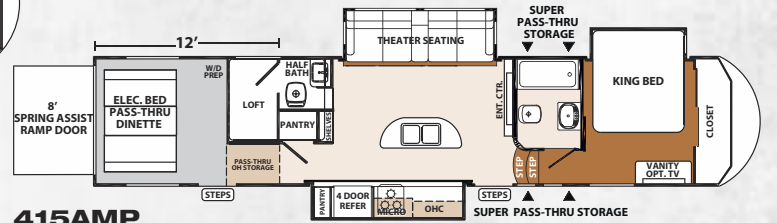

415AMP

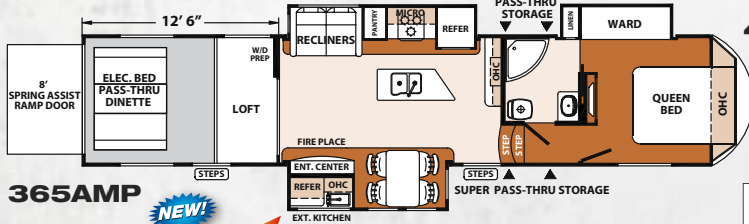

365AMP *NEW!*

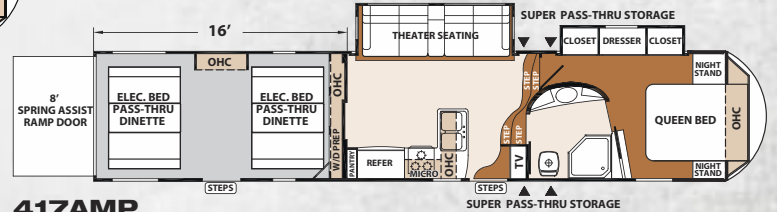

417AMP

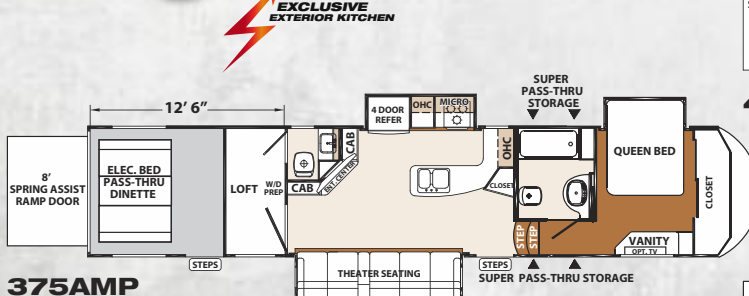

375AMP

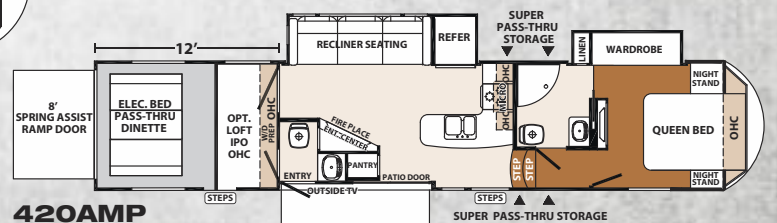

420AMP

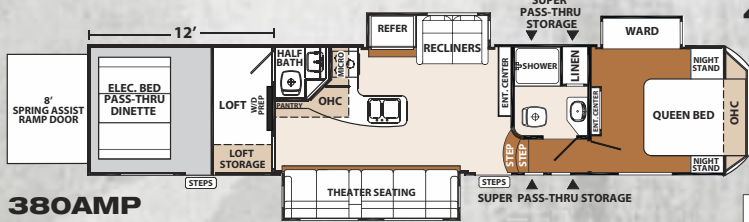

380AMP

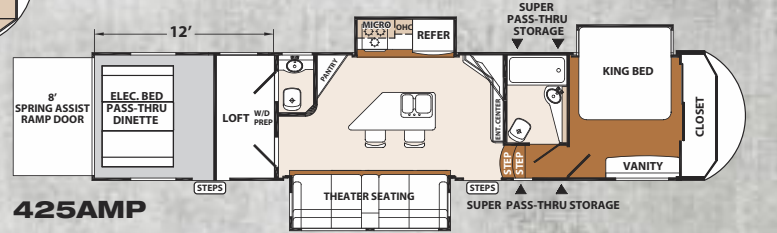

425AMP

EXCLUSIVE EXTERIOR KITCHEN

XLR Thunderbolt Standards And Options

Interior Standards

- Professionally Designed Interiors – Onyx, Saddle, Walnut
- New Vinyl Flooring – Birch Wood Grain
- Premium Shaker Passage Doors (Glass Inserts Where Applicable)
- Espresso Cabinetry w/ Hidden Hinges and Opaque Glass Inserts (Glass Inserts Where Applicable)
- Dark Espresso Wood Wainscoting in Garage
- LG Solid Surface Countertops
- Pop-Up Kitchen Counter Power Station
- Residential Kitchen Back Splash
- 12 Cubic Foot Gas/Electric Refrigerators
- Porcelain Foot Flush Toilet
- Large Residential Microwave
- Stainless Steel 60/40 Deep Bowl Kitchen Sink
- Crown Molding Throughout
- Black Out Roller Shades
- Living Room LCD HDTV
- Multi Zone Entertainment
- Zero Wall Recliner Theater Seating
- 15K BTU Air Conditioner w/ Own Digital Thermostats
- Bathroom Fantastic Fan
- LED Shower Light
- 12 Gallon Gas/Electric/DSI Water Heater
- Washer/Dryer Prep
- Retractable Hid-N-Screen Wall
- Heated Garage
- Insulated Garage Floor
- 42,000 BTU Furnace
- Dovetail Storage Box
- 5/8" Tongue and Groove Plywood Floor
- 100 Amp Converter

Exterior Standards

- 102" Wide Body Construction
- 21K GVWR Hitch Pin (Select Models)
- Steel Powder Coated I-Beam Chassis
- Front Hydraulic Landing Gear
- Electric Awning w/ LED Strip
- Vacuum-Bonded Aluminum Framed Construction

- Gel Coated Sidewalls
- Gel Coat Radius Front Cap w/ LED Lights
- Exterior LED Brake Lights and Marker Lights
- Reverse Activated Rear LED Flood Lights
- NitroFill™ Radial Tires
- Convenience Center for Utilities
- 50 AMP Service
- Attic Ventilation System
- Exclusive Fiberglass Hitch Pin Cover
- 5,000 lb. Flush Mount Steel Reinforced Tie Downs
- Front Hydraulic Landing Gear
- 8' Ramp Door Rated 3,000 Lbs.
- Generator Ready w/ Fuel Tank – 18 Gal.
- Ultra View Frameless Windows
- Electric Awning w/ LED Lights
- Slam Latch Baggage Doors
- Bolted to Frame Fuel Tanks
- Collapsible Exterior Ladder
- Large Assist Handles on all Entry Doors
- Hydraulic Flush-Floor Main Slide
- Black Laminated Slide-Out End Walls
- Hot/Cold Outside Shower
- Heated and Enclosed Underbelly
- Enclosed Termination Valves
- Black Tank Flush
- 30# LP Tanks

Mandatory Options

2016 Accelerator Package:

LED Lighted Countertops In Galley and Main Bath, Alumi-Tread Entry Steps, 6-Point Hydraulic Auto Level System, SONY Super Sound Package (SONY Double Din Touch Screen Stereo w/ DVD & Bluetooth, SONY 10" Super Powered Subwoofer, Rockford Fosgate Amp, SONY 8) Speaker Upgrade for Interior and Exterior

2016 Lightning Package:

Front Cap LED Strip Lighting, 7,000 lb. Dexter Axles, 7'6" Main Slide Height, Wide Stance Frame Upgrade, Spare Tire, Stainless Steel Appliances, Satellite Prep Interior Pass Thru Compartment, Dyson Cordless

- Vacuum, Premium Upgrade Mattress, Equa-Flex Suspension Enhancement, Friction Hinge Entry Doors, Solar Charger Input, Black Out Roller Shades in Living Area and Bedroom Area, Radiant Insulation Roof/Floor/Slide Out Floor/Front R38 @ 80°F
- 5.5 Onan CARB EVAP Gas Generator
- Mobile Fuel Station w/ Fuel Tank (30 gal.)
- Electric Bed w/ Max Clearance Pass-through Dinette

Optional Packages

Extreme Weather Package:

Ultra-view Frameless Dual Pane Windows, 12V Heated Holding Tanks, and Ducted Heat

Intensity Package:

Black Painted Cap, Black Painted Hitch Cover, Grey Gel-Coated Sidewalls, Upgraded Graphics

Additional Options

- Multiplex Control System
- Garmin GPS Display and Back-up Camera
- Keyless Main Entry Door
- 32" Flat Screen TV (Bedroom, Garage)
- 110 Volt Residential Refrigerator w/ Inverter (N/A 380AMP, 395AMP, 425AMP)
- Convection Microwave
- 12 Volt/160 Watt Solar Kit (Up To 3 Panels)
- Second Air Conditioner in Bedroom or Garage
- Third Air Conditioner w/ Energy Management System
- Girard 3.0 On Demand Water Heater – All Models
- Euro Style Chair – Single
- Three Season Door IPO Hid-N-Screen
- Multi-function Wireless Remote
- Plush, Removable Cargo Carpet Kit
- Improved VIP Party Deck w/ Electric Awning and (2) Zero Gravity Chairs (Accommodates Detachable Steps)
- VIP Steps for Garage and Side Patios
- Cargo Shower Upgrade (415AMP deletes loft)
- Second Power Awning w/ LED Lights
- Custom Full Body Paint

Model	340AMP	355AMP	365AMP	375AMP	380AMP	395AMP	415AMP	417AMP	420AMP	425AMP
Hitch Weight	2640	3498	3202	3595	2881	2932	2331	3266	2537	3045
UVW	11618	14777	15253	15238	15302	15113	13660	14188	14657	15377
Cargo Capacity	3938	6164	5747	5703	5639	5828	5236	6753	6284	5564
Exterior Length	38' 0"	43' 0"	44' 1"	42' 4"	42' 3"	42' 2"	42' 1"	43' 2"	43' 3"	41' 8"
Exterior Height	13' 4"	13' 4"	13' 4"	13' 4"	13' 4"	13' 4"	13' 4"	13' 4"	13' 4"	13' 4"
Exterior Width	102"	102"	102"	102"	102"	102"	102"	102"	102"	102"
Fresh Water	92	150	158	150	150	150	150	154	158	150
Grey Water	64	83	116	97	104	108	100	97	144	100
Black Water	32	50	50	97	104	54	108	97	97	82

GVWR (Gross Vehicle Weight Rating) - is the maximum permissible weight of the unit when fully loaded. It includes all weights, inclusive of all fluids, cargo, optional equipment and accessories. For safety and product performance do NOT exceed the GVWR.

GAWR (Gross Axle Weight Rating) - is the maximum permissible weight, including cargo, fluids, optional equipment and accessories that can be safely supported by a combination of all axles.

UVW (Unloaded Vehicle Weight)* - is the typical weight of the unit as manufactured at the factory. It includes all weight at the unit's axle(s) and tongue or pin and LP Gas. The UVW does not include cargo, fresh potable water, additional optional equipment or dealer installed accessories.

CCC (Cargo Carrying Capacity)** - is the amount of weight available for fresh potable water, cargo, additional optional equipment and accessories. CCC is equal to GVWR minus UVW. Available CCC should accommodate fresh potable water (8.3 lbs. per gallon). Before filling the fresh water tank, empty the black and grey tanks to provide for more cargo capacity.

*Estimated Average based on standard build optional equipment. **Estimated average based on standard build optional equipment.

Each Forest River RV is weighed at the manufacturing facility prior to shipping. A label identifying the unloaded vehicle weight of the actual unit and the cargo carrying capacity is applied to every Forest River RV prior to leaving our facilities.

The load capacity of your unit is designated by weight, not by volume, so you cannot necessarily use all available space when loading your unit.



Learn More
Scan this barcode using a QR Reader on your smart phone to learn more about Forest River.



A Berkshire Hathaway company.
#XLRtoylhaulers



XLR by Forest River

2421 Century Drive ■ Goshen, IN 46528
E-mail: XLRinfo@forestriverinc.com
Phone: 574-642-0438 ■ Fax: 574-343-5909
www.forestriverinc.com/XLR
www.forestriveraccessories.com



Actual towing capacity is dependent on your particular loading and towing circumstances, which includes GVWR, GAWR and GCWR, as well as adequate trailer brakes. Please refer to the Owners Manual of your vehicle for further information. All information contained in this brochure is believed to be accurate at the time of publication. However, during the model year, it may be necessary to make revisions and Forest River, Inc., reserves the right to make all such changes without notice, including prices, colors, materials, equipment and specifications as well as the addition of new models and the discontinuance of models shown in this brochure. Therefore, please consult with your Forest River dealer and confirm the existence of any materials, design or specifications that are material to your purchase decision. ©2015 XLR a Division of Forest River, Inc., a Berkshire Hathaway company. All Rights Reserved. 2/16