

Wildcat

Maxx

LITE

Options Include:

- Fantastic Fan
- Wood Plank Flooring
- Rear Ladder
- 15K Btu Roof A/C With Heat Pump
- Heated Strips – 12Volt Holding Tanks
- Stainless Steel Appearance Appliances – Mandatory
- Complete interior & exterior LED Lighting
- 2" Vacuum Bonded Aluminum Walls
- 80" Interior Height
- LP Gas Quick Connect for BBQ
- 22" Oven
- Trekk® Residential Flooring
- 40" HDTV

Maxx Lite Package Includes:

- Electric Tongue Jack
- Upgraded 60" X 80" Premium Mattress
- Am/Fm/Dv/Cd/Hdmi/Bluetooth Stereo W/ Outside Speakers
- Battery Disconnect
- Maxx-Bright Complete Coach Led Package
- Maxx-Bright Awning Led Lighting
- Maxx Coat Rack
- Portable Solar Prep
- Drop-In Cooktop With Glass Cover
- Seamless Countertop With Under-Mount Sink & High-Rise Pullout Faucet
- Black Tank Flush

All Season Construction:

- 30,000 Btu Ducted Furnace
- Vented Attic
- USB Port package
- Enclosed Underbelly W/R-7 Fiberglass + Reflective Astrofoil Insulation
- 30,000 Btu Ducted Furnace
- 2" Vacuum Bonded Walls W/R-10 High Density Block Foam Insulation
- 2" Vacuum Bonded Slide Out Walls & Ceiling W/R-10 High Density Block Foam Insulation
- Slide Floor Includes 1" Plywood With Astrofoil Insulation
- Floor Insulation Includes R-7 Fiberglass + Reflective Astrofoil Insulation
- Ceiling, Front & Rear Walls Include 2 Layers Of R-7 Fiberglass Insulation + Reflective Astrofoil Insulation
- Optional 12 Volt Heat Strips On All Holding Tanks

	T265BHX	T255RLX
EXTERIOR LENGTH	31' 8"	29' 5"
HITCH WEIGHT (LBS.)	828	620
UNLOADED VEHICLE WEIGHT (LBS.)	6496	5712
GVWR (LBS.)	7828	7620
CARGO CAPACITY (LBS.)	1332	1870
FRESH WATER (GAL.)	61	61
BLACK WATER (GAL.)	32	32
GALLEY TANK (GAL.)	32	32
GREY TANK (GAL.)	32	32
AWNING SIZE	16'	17'

COMING SOON

T245RGX

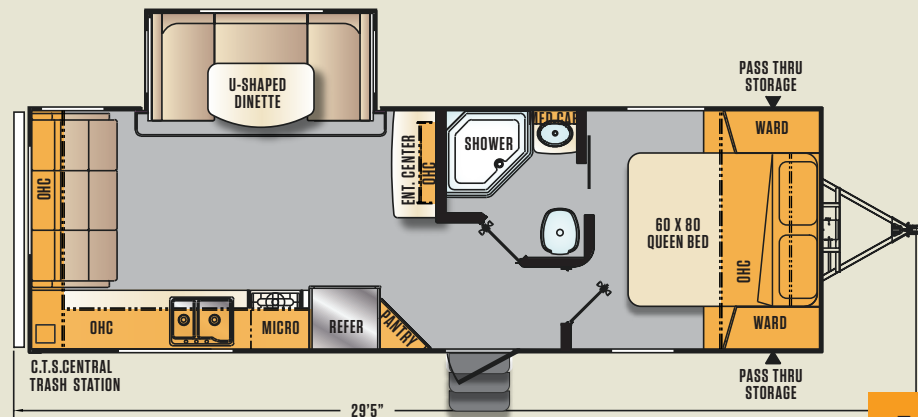

T255BHX

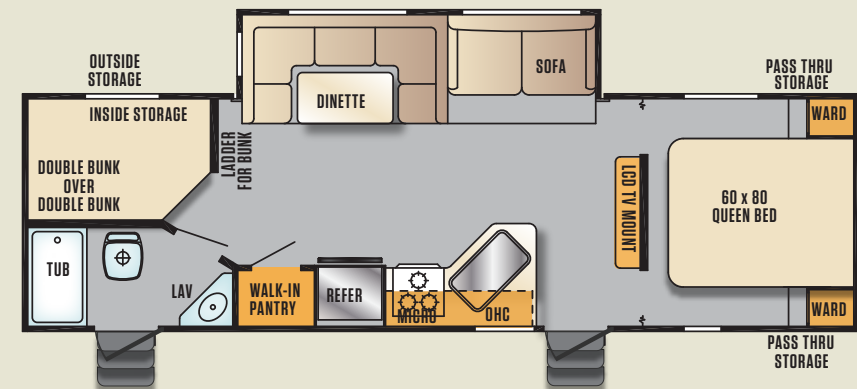

T265BHX



PRE-DELIVERY INSPECTION FACILITY

20,000 square feet of quality assurance. The bare essentials for a premium product. This state-of-the-art facility gives immediate daily feedback to production for quality assurance in every unit built.



Forest River, Inc. encourages our customers to purchase their Forest River products from a local dealership whenever possible for the following reasons:

- 1) Forest River, Inc. dealers are independently owned and operated businesses so priority service and scheduling is at their discretion and is often provided to customers that purchased their unit at that dealership.
- 2) Purchasing locally allows customers to establish meaningful relationships with a dealer, enhancing the RV experience through assistance with product questions, user tips or RV regulations for your state or country, and much more!
- 3) Canadian customers must meet requirements to bring an RV purchased out of the country to their home. These requirements may involve additional inspections and certifications, taxes and fees. Your local Canadian Dealer is a professional at meeting these requirements.
- 4) Scheduling timely warranty repairs and adjustments through a local dealership provides far greater flexibility and convenience to you, the customer!

It is the goal of Forest River, Inc. that all of our RV owners fully enjoy the RV experience and that customer satisfaction meets or exceeds their expectations!

24/7 EMERGENCY ROADSIDE ASSISTANCE

For a worry-free ownership experience

Forest River includes one

year of Coach-Net RV Technical & Roadside Assistance with each RV purchase. Whether new to the RV lifestyle or an experienced RV enthusiast, Forest River owners have 24/7 access to technical, operational and emergency road service coverage throughout the US & Canada.

Coach-Net's fast, dependable service is just a phone call away.

Coach-Net[®]
RV Technical & Roadside Assistance



Wildcat Maxx

Specification Definitions

GVWR (Gross Vehicle Weight Rating) - is the maximum permissible weight of the unit when fully loaded. It includes all weights, inclusive of all fluids, cargo, optional equipment and accessories. For safety and product performance do NOT exceed the GVWR.

GAWR (Gross Axle Weight Rating) - is the maximum permissible weight, including cargo, fluids, optional equipment and accessories that can be safely supported by a combination of all axles.

UVW (Unloaded Vehicle Weight)** - is the typical weight of the unit as manufactured at the factory. It includes all weight at the unit's axle(s) and tongue or pin and LP Gas. The UVW does not include cargo, fresh potable water, additional optional equipment or dealer installed accessories.

*Estimated average based on standard build optional equipment.

CCC (Cargo Carrying Capacity)** - is the amount of weight available for fresh potable water, cargo, additional optional equipment and accessories. CCC is equal to GVWR minus UVW. Available CCC should accommodate fresh potable water (8.3 lbs per gallon). Before filling the fresh water tank, empty the black and gray tanks to provide for more cargo capacity.

**Estimated average based on standard build optional equipment

Each Forest River RV is weighed at the manufacturing facility prior to shipping. A label identifying the unloaded vehicle weight of the actual unit and the cargo carrying capacity is applied to every Forest River RV prior to leaving our facilities.

The load capacity of your unit is designated by weight, not by volume, so you cannot necessarily use all available space when loading your unit.



Learn More

Scan this barcode using a QR Reader on your smart phone to learn more about Forest River.



A Berkshire Hathaway company.

1429 SE UGLOW AVE, DALLAS, OREGON 97338
WWW.FORESTRIVERINC.COM/WILDCATMAXX
(503) 831-1200

YOUR ROCKWOOD DEALER

All information contained in this brochure is believed to be accurate at the time of publication. However, during the model year, it may be necessary to make revisions and Forest River, Inc., reserves the right to make all such changes without notice, including prices, colors, materials, equipment and specifications as well as the addition of new models and the discontinuance of models shown in this brochure. Therefore, please consult with your Forest River, Inc., dealer and confirm the existence of any materials, design or specifications that are material to your purchase decision. Litho. U.S.A P / W: 2014.09.05