

VIBE
EXTREME_{LITE}
FOREST RIVER

VIBE
EXTREME_{LITE}
FOREST RIVER



WE'VE GONE TO THE EXTREME!

VIBE OFFERS THE MOST EXTREME LIGHTWEIGHT LINEUP IN THE INDUSTRY.

IF YOU'RE LOOKING FOR EXTREME EFFICIENCY, EXTREME VALUE AND EXTREME FUN
THEN GOOD VIBES ARE JUST OVER THE NEXT HILL.

FLOORPLANS START AT 4400 LBS. AND MAX OUT AT 6100 LBS.







224RLS Back to Front View | Marble Decor

COUPLES COACH/NON-BUNK LINE-UP

Looking for a lightweight towable that won't break the bank or your tow vehicle? Welcome to the VIBE Extreme Lite series. Every floorplan is designed for maximum comfort and convenience. Constructed with high end finishes like stainless steel appliances, LED lighting and flat screen TV's previously only available at much higher price points, the VIBE Extreme Lite delivers exactly what you have been looking for in a lightweight and easy to tow coach. Great amenities at a great price.



224RLS Front to Back View | Marble Decor





258RKS Back to Front View | Marble Decor

MORE STORAGE
MORE SPACE
MORE VALUE...
LESS WEIGHT!



258RKS Bathroom



258RKS Bedroom





277RLS Bathroom



277RLS Pantry

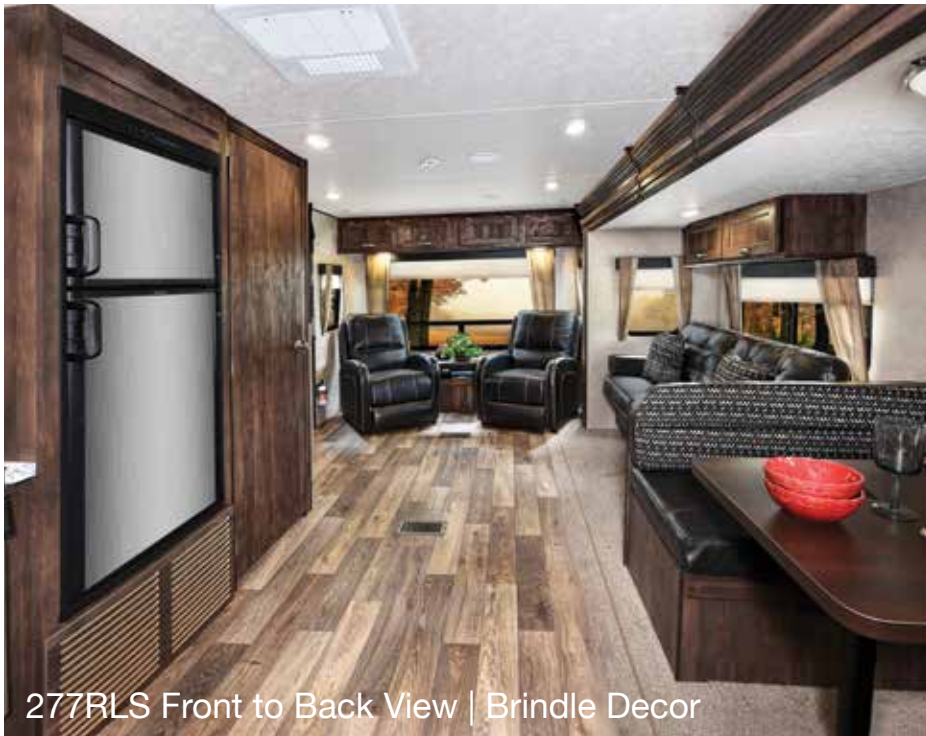

277RLS Front to Back View | Brindle Decor

COUPLES COACH/NON-BUNK FLOORPLANS

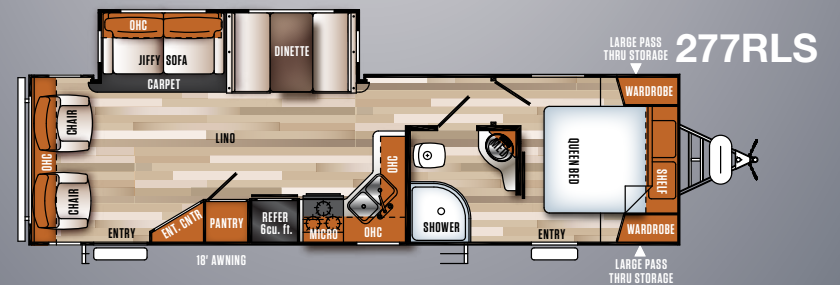
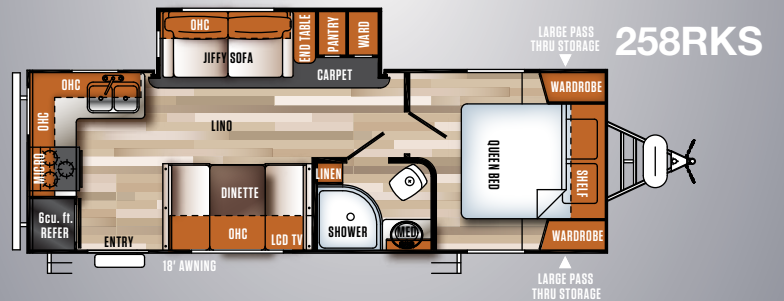
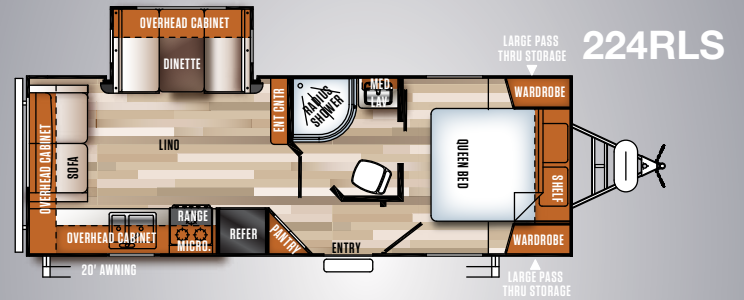
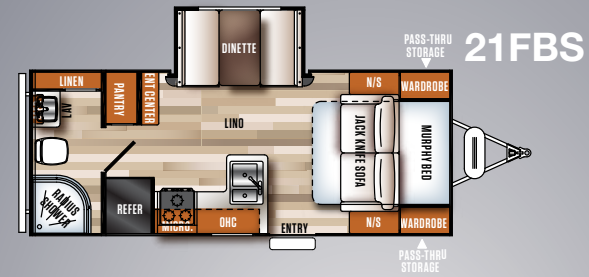

BUNKHOUSE FLOORPLANS



243BHS Back to Front View | Brindle Decor



243BHS Front to Back View



315BHK Front to Back View | Brindle Decor



315BHK Bunkroom



287QBS Back to Front View | Marble Decor

287QBS Bedroom



287QBS Bunkroom



287QBS/315BHK Bath

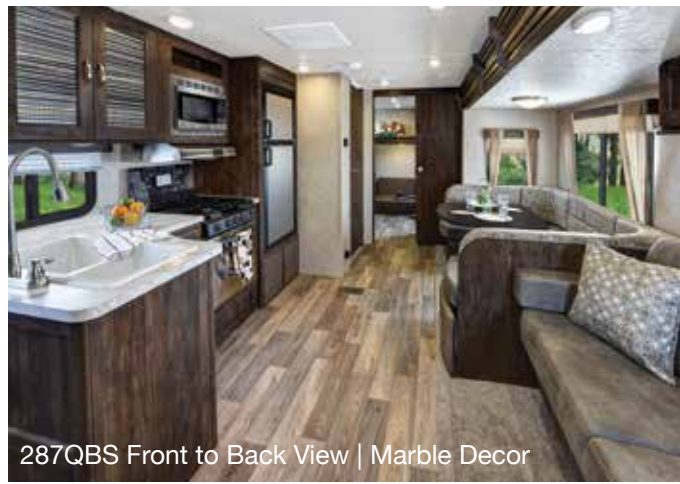

287QBS Front to Back View | Marble Decor



Exterior Kitchen Available on all Bunkhouse Floorplans

BUNKHOUSE FLOORPLANS

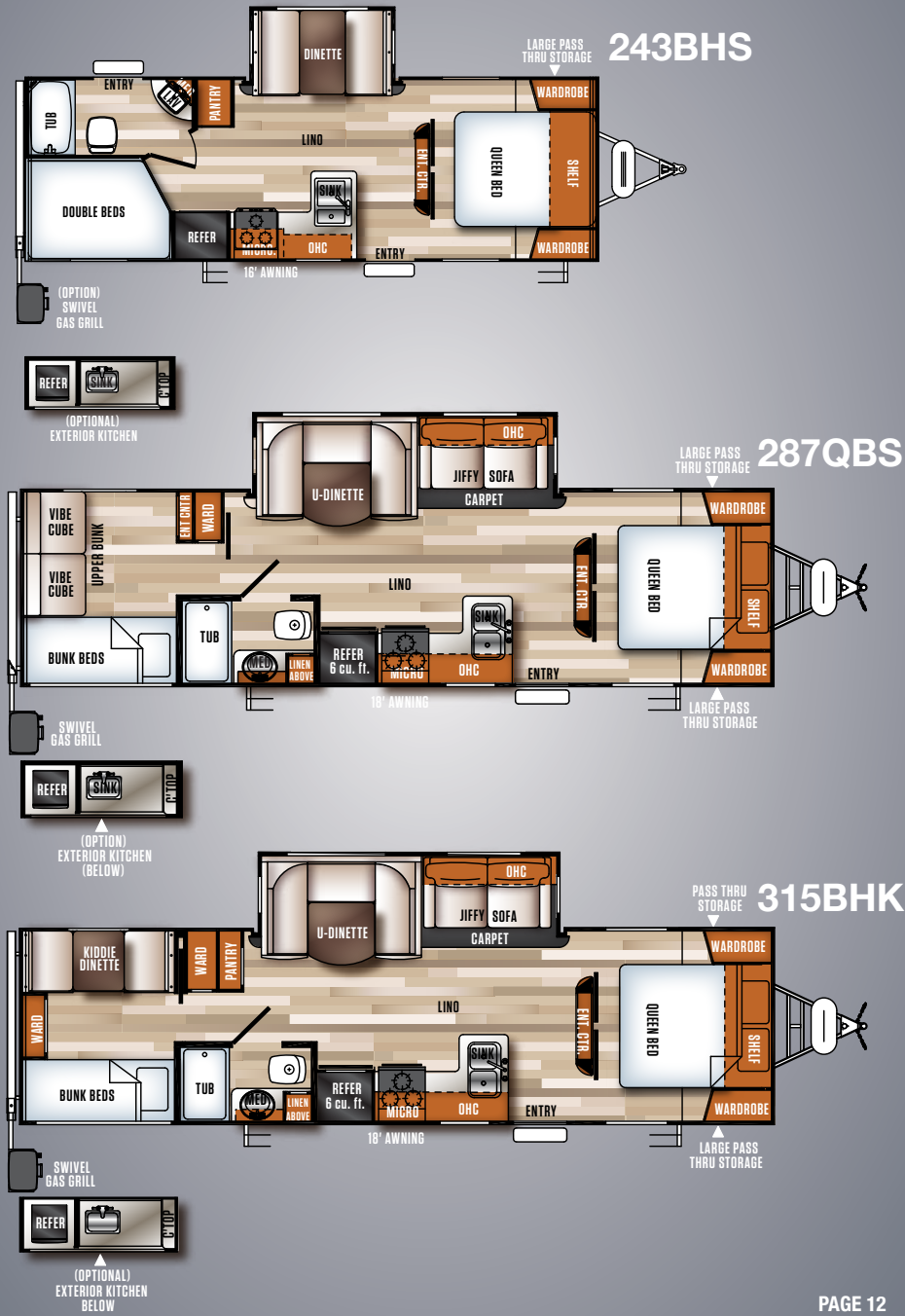

STANDARDS/OPTIONS/FEATURES

EXTERIOR STANDARD FEATURES

- HYPER LYTE CONSTRUCTION - AMAZINGLY LIGHT!!
- TRI-TONE GEL COAT FIBERGLASS W/ UPGRADED GRAPHICS PACKAGE
- VACUUM BONDED "ALUMA FRAME" SIDE WALLS AND 2" LAMINATED FLOOR
- HIGH GLOSS ROLLED FIBERGLASS FRONT END
- DUCTED 13.5 BTU AIR CONDITIONING
- HIGH EFFICIENCY A/C COOLING SYSTEM (LARGER DUCT WORK)
- CABLE & SATELLITE PREP
- DIGITAL TV ANTENNA W/ BOOSTER
- EXTRA LARGE, ALUMINUM FRAMED, PASS THRU STORAGE
- ONE TOUCH ELECTRIC AWNING
- LED GROUND EFFECT LIGHTING
- LED LIGHTED EXTERIOR SPEAKERS (2)
- XL GRAB HANDLE
- COACH-NET ROADSIDE ASSISTANCE
- RADIAL TIRES FILLED W/ NITROGEN
- HEATED AND ENCLOSED UNDERBELLY
- STABILIZER JACKS
- 2- 20# LP BOTTLES
- 30" FRICTION HINGE ENTRY DOOR

INTERIOR STANDARD FEATURES

- REEDED GLASS IN KITCHEN CABINETS
- 3-BURNER COOK TOP W/ STAINLESS STEEL 22" OVEN
- LARGE DOUBLE BOWL KITCHEN SINK
- DOMETIC DOUBLE DOOR 6 cu. ft. GAS/ELECTRIC REFRIGERATOR W/ STAINLESS FRONT
- 6 GAL. G/E DSI WATER HEATER
- DOMETIC PEDAL FLUSH TOILET
- SOLID SURFACE KITCHEN COUNTERTOPS
- DELUXE WOOD BOOTH TABLE TOP
- CATHEDRAL (BARRELED) CEILING
- HARD DOORS TO BEDROOMS FOR PRIVACY (NOT CURTAINS)
- DECORATIVE KITCHEN BACKSPLASH
- LARGE TRASH CAN W/ DESIGNATED OUT OF THE WAY AREA
- UPGRADED RESIDENTIAL STYLE CARPET
- FULL EXTENSION BALL BEARING DRAWER GUIDES
- STAINLESS STEEL KITCHEN PACKAGE
- POT & PAN DRAWER UNDER DINETTE SEAT
- STAINLESS STEEL ROLL UP SINK COVER
- BLUETOOTH MP3/DVD/CD/FM W/ SURROUND SOUND
- TEDDY BEAR SERIES BUNK MATS

OPTIONS

- ALUMINUM WHEELS
- SPARE TIRE
- OUTSIDE KITCHEN (BUMPER MOUNTED GRILL, FRIDGE, SINK W/DRAIN, METAL COUNTERTOP 243BHS, 287QBS, 315BHK)
- SKYLIGHT OVER TUB/SHOWER
- 32" FLAT SCREEN TV (21FBS, 258RKS, 277RLS)
- 40" FLAT SCREEN TV
- OUTSIDE SHOWER
- 15K BTU DUCTED A/C IPO 13.5K
- 50 AMP SERVICE W/ WIRE & BRACE FOR 2ND A/C
- 2ND 13.5K A/C IN BEDROOM (REQUIRES 50 AMP)

LIMITED SHOWSTOPPER FEATURES

- HIGH RISE FAUCET W/ PULL OUT SPRAYER
- BLACK TANK FLUSH
- SOLAR PANEL PREP
- POWER TONGUE JACK
- POWER STABILIZER JACKS
- COLORED LED AWNING LIGHT
- TOUCH SCREEN REMOTE
- RECESSED STOVE W/GLASS COVER
- DECORATIVE WINDOW TREATMENTS (LIVING ROOM ONLY)
- NIGHT SHADES (LIVING ROOM ONLY)

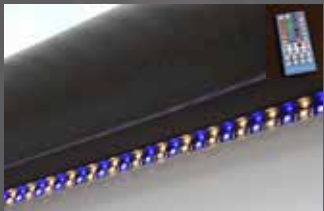

COLORED LED AWNING LIGHT WITH REMOTE



UNDER COUNTER LED LIGHTING



UNDER BOOTH DINETTE STORAGE



LED GROUND EFFECT LIGHTING



RESIDENTIAL WINDOW TREATMENTS



POWER TONGUE JACK



6 SPOKE ALUMINUM RIMS



HIGH RISE FAUCET WITH PULL OUT SPRAYER



WALK AROUND QUEEN BED AND BEDSPREAD



POWER STAB JACKS



LARGEST OVEN IN ITS CLASS



BLUETOOTH MP3/DVD/CD/FM W/ SURROUND SOUND

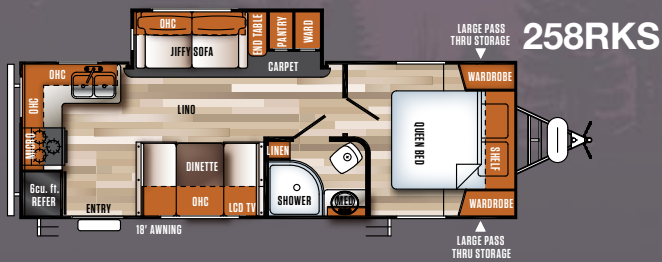
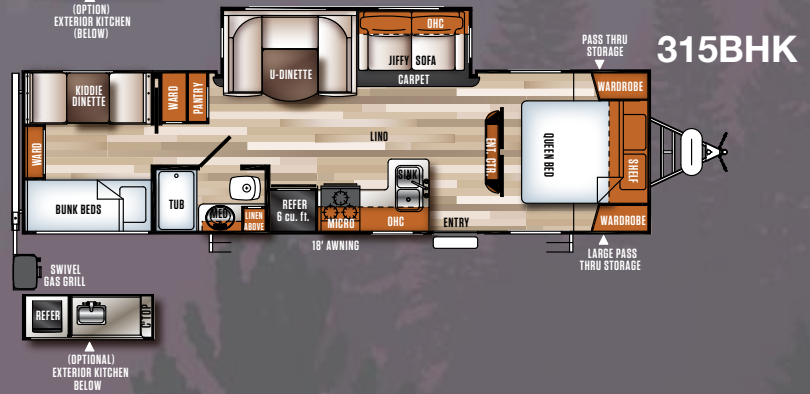
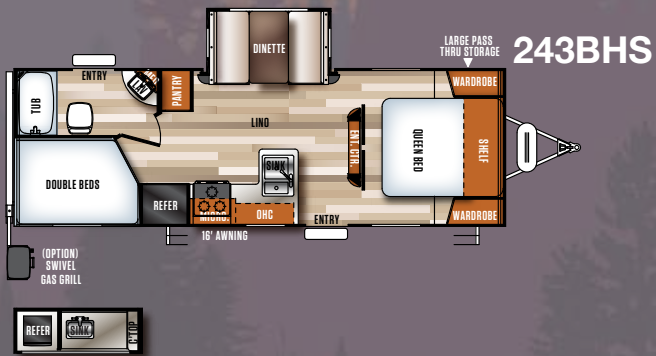
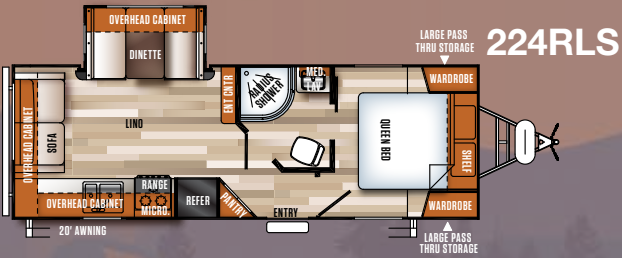
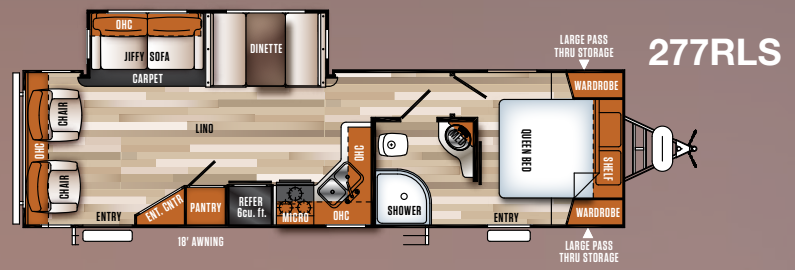
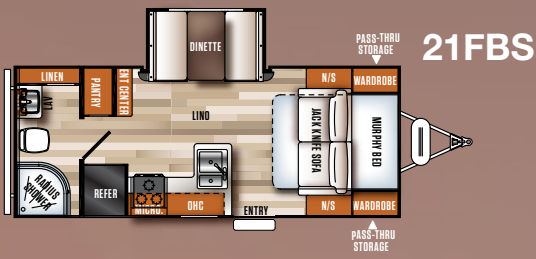

SPECIFICATIONS

MODEL	21FBS	224RLS	243BHS	258RKS	277RLS	287QBS	315BHK
HITCH WEIGHT	507	567	630	498	615	772	719
AXLE WEIGHT	3926	4281	4398	4406	5292	4987	5125
UVW	4471	4886	5066	4942	5945	5797	5882
CCC (CARGO CAP.)	1833	1833	1833	1800	1670	1867	1867
EXTERIOR LENGTH	24' 9"	28' 4"	29' 4"	28' 11"	34' 7"	34' 9"	34' 9"
EXTERIOR HEIGHT	11' 0"	11' 0"	11' 0"	11' 0"	11' 0"	11' 0"	11' 0"
FRESH WATER (gal.)	46	46	46	46	46	46	44
BLACK WATER (gal.)	32	32	32	32	30	32	30
GREY WATER (gal.)	64	64	64	64	60	60	60
AWNING SIZE	14'	18'	18'	20'	20'	18'	18'
TIRE SIZE	14"	14"	15"	15"	15"	15"	15"



PRE-DELIVERY INSPECTION FACILITY

20,000 square feet of quality assurance. The bare essentials for a premium product. This state-of-the-art facility gives immediate daily feedback to production for quality assurance in every unit built.

GVWR (Gross Vehicle Weight Rating) - is the maximum permissible weight of the unit when fully loaded. It includes all weights, inclusive of all fluids, cargo, optional equipment and accessories. For safety and product performance do NOT exceed the GVWR.

GAWR (Gross Axle Weight Rating) - is the maximum permissible weight, including cargo, fluids, optional equipment and accessories that can be safely supported by a combination of all axles.

UVW (Unloaded Vehicle Weight)* - is the typical weight of the unit as manufactured at the factory. It includes all weight at the unit's axle(s) and tongue or pin and LP Gas. The UVW does not include cargo, fresh potable water, additional optional equipment or dealer installed accessories.

*Estimated Average based on standard build optional equipment.

CCC (Cargo Carrying Capacity)** - is the amount of weight available for fresh potable water, cargo, additional optional equipment and accessories. CCC is equal to GVWR minus UVW. Available CCC should accommodate fresh potable water (8.3 lbs per gallon). Before filling the fresh water tank, empty the black and gray tanks to provide for more cargo capacity.

** Estimated average based on standard build optional equipment

Each Forest River RV is weighed at the manufacturing facility prior to shipping. A label identifying the unloaded vehicle weight of the actual unit and the cargo carrying capacity is applied to every Forest River RV prior to leaving our facilities.

The load capacity of your unit is designated by weight, not by volume, so you cannot necessarily use all available space when loading your unit.

All information contained in this brochure is believed to be accurate at the time of publication. However, during the model year, it may be necessary to make revisions and Forest River, Inc., reserves the right to make all such changes without notice, including prices, colors, materials, equipment and specifications as well as the addition of new models and the discontinuance of models shown in this brochure. Therefore, please consult with your Forest River dealer and confirm the existence of any materials, design or specifications that are material to your purchase decision.



Forest River, Inc. encourages our customers to purchase their Forest River products from a local dealership whenever possible for the following reasons:

- 1) Forest River, Inc. dealers are independently owned and operated businesses so priority service and scheduling is at their discretion and is often provided to customers that purchased their unit at that dealership.
- 2) Purchasing locally allows customers to establish meaningful relationships with a dealer, enhancing the RV experience through assistance with product questions, user tips or RV regulations for your state or country, and much more!
- 3) Canadian customers must meet requirements to bring an RV purchased out of the country to their home. These requirements may involve additional inspections and certifications, taxes and fees. Your local Canadian Dealer is a professional at meeting these requirements.
- 4) Scheduling timely warranty repairs and adjustments through a local dealership provides far greater flexibility and convenience to you, the customer!

It is the goal of Forest River, Inc. that all of our RV owners fully enjoy the RV experience and that customer satisfaction meets or exceeds their expectations!

24/7 EMERGENCY ROADSIDE ASSISTANCE

For a worry-free ownership experience Forest River includes one year of Coach-Net RV Technical & Roadside Assistance with each RV purchase. Whether new to the RV lifestyle or an experienced RV enthusiast, Forest River owners have 24/7 access to technical, operational and emergency road service coverage throughout the US & Canada. Coach-Net's fast, dependable service is just a phone call away.

Coach-Net®



Learn More
Scan this barcode using a QR Reader on your smart phone to learn more about Forest River.



A Berkshire Hathaway company.

VIBE/Forest River Inc.
411 CR 15
Elkhart, IN 46516
(574)-296-2084
www.forestriverinc.com
www.forestriveraccessories.com