



Capture the memories.







## More for your Money.

The 27DBK and all Wildwood models offer more value for your money. Over the last 6 years, this has helped make Wildwood the value buyers choice. The beautiful interiors are one reason. Wildwoods look like an RV costing \$5,000 - \$10,000 more. The kitchen countertop, slide-out treatments, cabinet storage, window appointments, wood grain linoleum, bedspreads, shower curtains, and the finishes on appliances, cabinets and hardware, are major elements to our success. See for yourself. Compare and make the wise and obvious choice to own a Wildwood RV by Forest River, Inc.

- 1 Extra large shoe cubby under master bed
- 2 Wildwood master bedroom includes full walkaround bed, dual hanging wardrobes, and private entertainment center
- 3 Exceptionally large walk in pantry / storage room



**27DBK**

DÉCOR COLOR:

*Tiffany Leather*

**6,418 LBS**

Shown with  
Standard Beauflor®  
Plank Wood Linoleum



**27RKSS**

DÉCOR COLOR:

*Onyx*

**6,798 LBS**

Shown with  
Standard Beauflor®  
Plank Wood Linoleum

# We never cut corners.

## COMMITTED TO QUALITY

Wildwood doesn't skimp on windows, drawers, solid interior doors, cabinets or other features. We are committed to manufacturing quality built products.

- 1 Full extension ball bearing drawer guides with cabinet-grade plywood drawer sides.
- 2 Two recliners are standard equipment on the T27RKSS & T27RLSS.
- 3 This upgraded glass radius shower is available on the 21RBS, 23RBS, 25RKS, 27REIS, 27RBSS, 27RKSS and 27RLSS.
- 4 "Double Deep" kitchen overhead cabinets provide a kitchen with the best storage space in the business.
- 5 We have added a new high quality vinyl coated back splash in the kitchen that is wonderfully wrinkle-free and heat-resistant.
- 6 LED lighting is a popular standard feature.
- 7 Recent redesigns have brought more space into the bedroom at the foot of the bed. Our customers love it!



Access door for the laundry chute





16" x 24" Stained Glass Cabinets and Base Shelves (Where applicable)

New Dhalia Cherry Mouldings and Accents Throughout

LED Lights

Night Shades

Decorative Curtain Rods and Curtains

80" CEILING HEIGHT

WILDWOOD  
*Interior Features*  
SOME FEATURES HAVE LIMITED AVAILABILITY

Stainless Steel Appliance Package

LG® Solid Surface Countertops

Full Extension, Extra-Deep Pot and Pan Drawer

Beauflor® Linoleum Scratch, Tear, and Cold, Crack Resistant Flooring

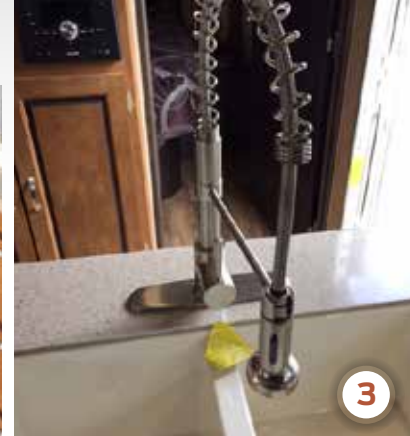

# Popular Features

## MORE REASONS WHY PEOPLE CHOOSE WILDWOOD OVER OTHER BRANDS

- 1 Solid Surface Countertops with Undermount Sink
- 2 Hinged 1/2 Barrel Storage (Most Models)
- 3 High Rise Faucet and 60/40 Sink
- 4 Extra Large Pass-Through Storage
- 5 Beauflor® One Piece Plank Wood Linoleum Flooring
- 6 Full Extension Ball Bearing Drawer Guides
- 7 Bluetooth FM Radio, DVD Player w/ MP3 Hookup (Limited Time Options\*)
- 8 Free Standing Gas Grill (Outside Kitchen Models Only)
- 9 Swivel Entertainment Center with Solid Doors to Bedroom (Shown with Customer-supplied TV)
- 10 16" x 24" Stained Glass Cabinets and Base Shelves (Where applicable)
- 11 LED Awning Lights
- 12 Shoe Nook (Most Models)
- 13 Aerodynamic Front Profile



WILDWOOD

# Construction

- 1 Radius entry Steps
- 2 2" x 3" floor joists 12" on center
- 3 One piece 5/8" Dyna Span flooring with a minimum 25 year warranty
- 4 2" wall studs 16" or less on center
- 5 30" fiberglass radius entry door
- 6 .024 aluminum siding
- 7 5" bowed truss roof rafters
- 8 One piece seamless roof (12 yr. warranty)
- 9 R-7 fiberglass insulation throughout
- 10 Extra large full pass-thru storage w/ 20" x 30" Door (per floorplan)
- 11 Smooth rolled skirting
- 12 In floor ducted heat
- 13 Diamond plate rockguard
- 14 3/8" roof decking (full walk-on roof)
- 15 LP bottle cover w/ easy access
- 16 13.5K ducted roof, high output AC w/ quick cool
- 17 Hitch light & 0.40 aluminum front cap
- 18 Stain resistant carpet
- 19 One piece plank wood look linoleum flooring
- 20 Safety glass windows
- 21 Polystyrene foam insulated A/C duct work
- 22 "Darco" anti-puncture underbelly wrap



## FORM FOLLOWS FUNCTION.

At Wildwood your satisfaction is serious business and it shows. Our commitment to your satisfaction includes:

- A. Extra large pass-thru storage
- B. Heated and enclosed fresh water tank
- C. 6 gallon Gas/Electric DSI water heater with Quick Recovery
- D. New Centralized Command Center

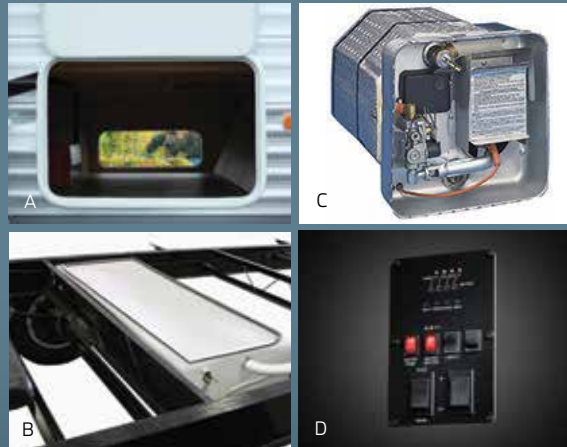



# Standards & Options

## CONSTRUCTION & EXTERIOR

- **One-piece 5/8" DynaSpan® flooring with a minimum 25 year warranty**
- Dacor Diflex II™ TPO roofing with limited 12 year warranty
- Extra large full pass through storage (per floorplan)
- Cold crack and mildew resistant vinyl patio awning
- Safety glass windows
- **Metal framed 30" smooth radius corner fiberglass main entry door**
- Cambered chassis
- **Enclosed fresh water tank in a heated compartment**
- 16-gal. per hour Gas/Electric quick recovery DSI water heater
- Water heater by-pass
- 2" wall construction, 16" (or less) on center
- R-7 fiberglass insulation throughout
- 13 ply cross micro-laminated beam header above slide out
- **Triple seal slide out system**
- Electric slide out systems (flush floor)
- Swing arm entry assist handle
- Two marine grade exterior speakers
- **Aerodynamic front radius**
- Smooth aluminum front cap

## KITCHEN

- Dometic® double door refrigerator (2 yr. warranty)
- High rise faucet
- Undermount style sink
- Stainless steel finish microwave w/ carousel
- 3-Burner, high output range with oven (2 yr. warranty) Stainless steel finish on door

- Stainless steel finish range hood w/ 12-volt exhaust fan and light
- One piece Beauflor® vinyl flooring
- Taller overhead cabinets (kit)
- Wood drawers w/ furniture-grade plywood sides
- Full extension ball bearing drawer guides
- **Shelving** in overhead cabinets in kitchen
- Central switch location for command center
- Brushed stainless finish hardware
- Abundant cabinet storage
- **Large pots and pans drawer under dinette**

## LIVING ROOM

- 80" interior height in travel trailers
- Ducted 13,500 BTU roof air conditioner w/ quick cool
- **Huge storage drawer under jiffy sofa**
- Booth dinette w/ large storage drawer (most models) (U-shaped dinette, some models)
- Large dinette picture window
- Winegard® antenna with booster
- Bluetooth FM stereo CD/DVD and four cubed speakers
- Decorative wall light
- 25K BTU suburban forced air DSI furnace w/ digital thermostat (2 yr. warranty)
- In-floor ducted heat
- Flip TV mount (most models)
- Cable TV hookup living room and bedroom
- **Wall switch controls for ceiling lights at key locations**
- **BEDROOM**
- Plush comforter and headboard

- **Strut lifted storage area under bed (master bedroom)**
- Bedside mirrored wardrobes w/ shelf above bed
- Bedside 110-volt power outlets (2)
- **Increased space at the foot of the bed (most models)**
- Solid bedroom privacy doors (most models)
- Storage shelf above bed
- Bedside hamper access (most models)

## BATHROOM

- 12-volt power bath roof exhaust vent
- Wooden medicine cabinet w/ mirrored door
- Foot flush toilet
- Tooth brush holder and towel ring
- Vinyl tub surround (neo-angle showers have an enclosure) (select floorplans)
- One-piece slip-resistant Beauflor® vinyl flooring

## SECURITY AND SAFETY

- LP leak detector
- Smoke detector
- Carbon monoxide detector
- Fire extinguisher
- Hitch light (travel trailers)
- Welded heavy duty safety chains (travel trailers)
- Electric brakes (all wheels)
- GFI receptacles
- ANSI 119.2 certified
- Meets all national highway administration specifications
- RVIA approved product
- Beauflor® vinyl floor with "SafetyGrip"
- Undermount kitchen sink

## WILDWOOD OPTIONS

- Stabilizer jacks [travel trailer (4)]
- Skylight over tub
- 30-lb LP bottles w/ cover and auto change over (travel trailers)
- 12v power four corner stabilizer jacks
- Power awning with LED light
- 15,000 BTU ducted air w/ quick cool
- Remote control for slide outs and power awning
- Radial tires (Mandatory option)

Contact your Wildwood dealer for a complete list of options.



Power awning with LED light



High Rise Spring Faucet

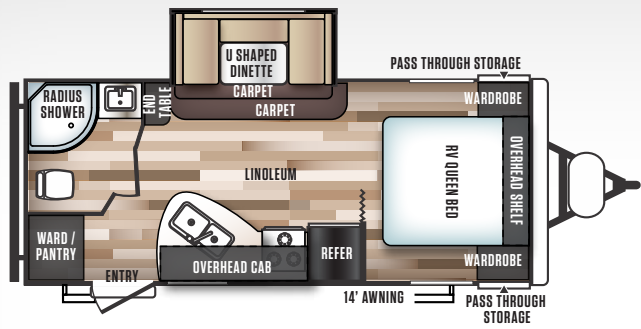

**21RBS**  
4,853  
DRY WEIGHT

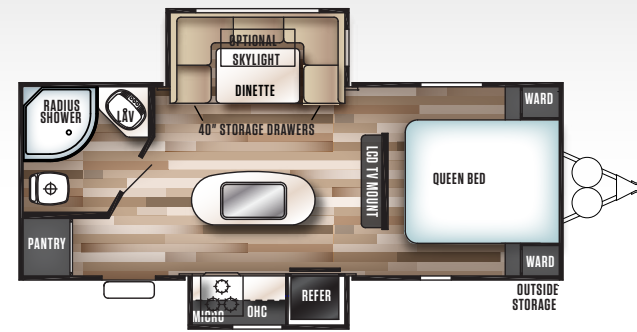

**23RBS**  
6,030  
DRY WEIGHT

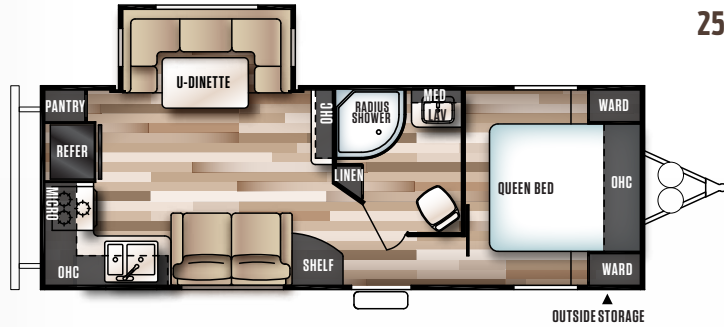

**25RKS**  
5,794  
DRY WEIGHT

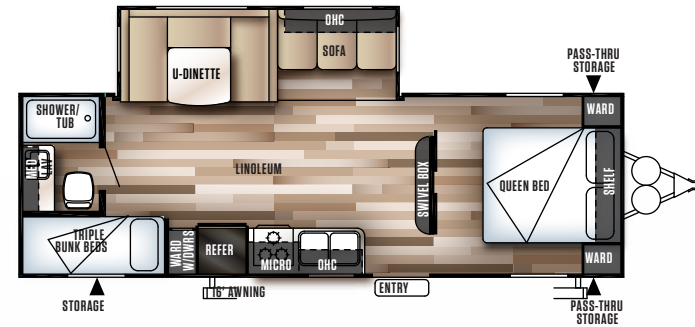

**26TBUD**  
6,310  
DRY WEIGHT

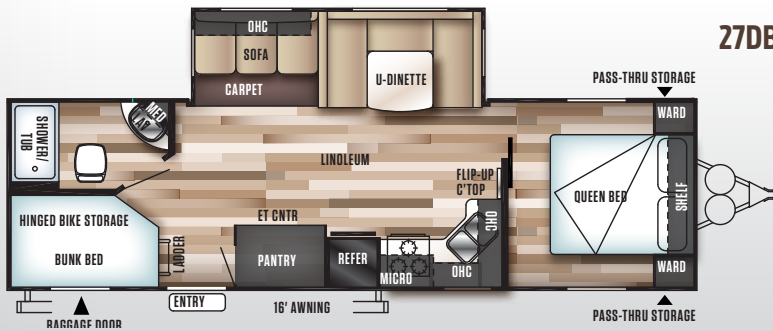

**27DBK**  
6,898  
DRY WEIGHT

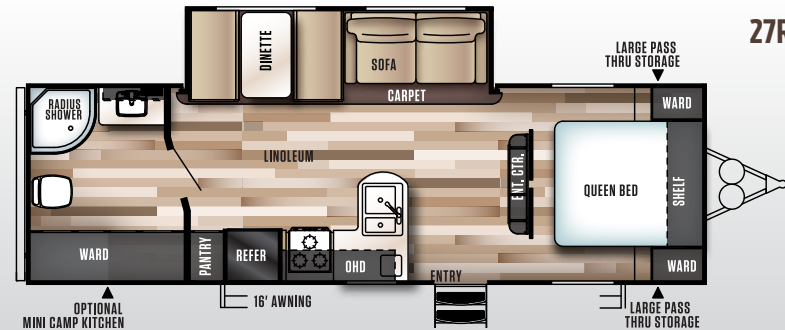

**27RBSS**  
6,552  
DRY WEIGHT

WILDWOOD  
*Travel Trailers*

	T21RBS	T23RBS	T25RKS	T26TBUD	T27DBK	T27RBSS
HITCH WEIGHT (LBS.)	515	898	578	800	688	834
DRY SHIP WEIGHT (LBS.)	4853	6030	5794	6310	6898	6552
CARGO CARRYING CAPACITY (LBS.)	2662	1830	1784	1452	2590	3082
EXTERIOR LENGTH	25'4"	28'5"	29'2"	29'5"	32'4"	31'6"
EXTERIOR HEIGHT	11'3"	11'3"	11'3"	11'3"	11'4"	11'3"
FRESH WATER CAPACITY (GAL.)	61	61	61	61	61	61
BLACK WATER CAPACITY (GAL.)	32	32	42	33	28	32
GREY WATER CAPACITY (GAL.)	28	28	66	28	64	74
AWNING SIZE (FT.)	14'	15'	16'	16'	17'	16'

**27REIS** TBD  
DRY WEIGHT

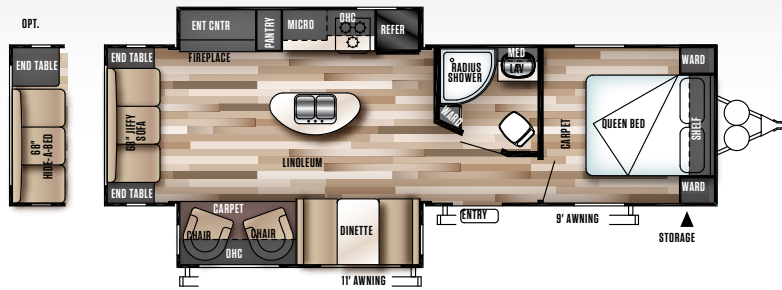

**27RKSS** 6,798  
DRY WEIGHT

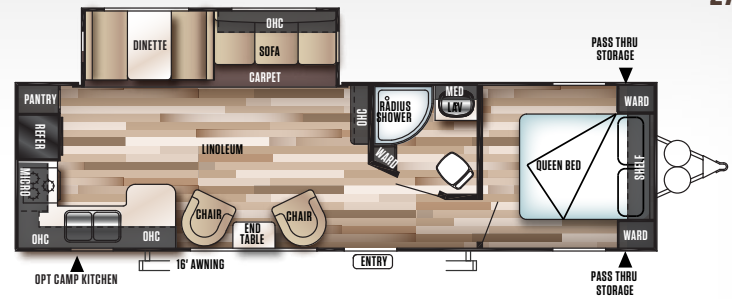

**27RLSS** 6,722  
DRY WEIGHT

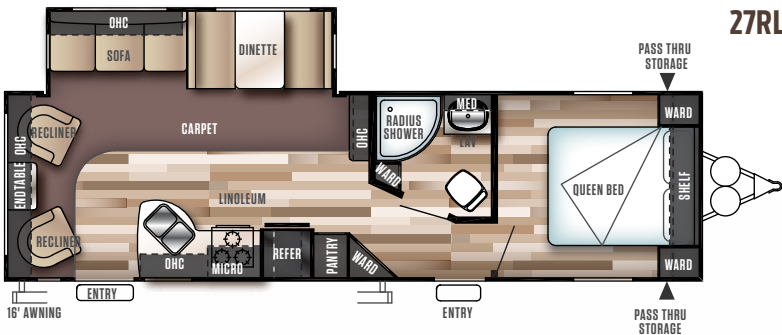

**27TDSS** 7,162  
DRY WEIGHT

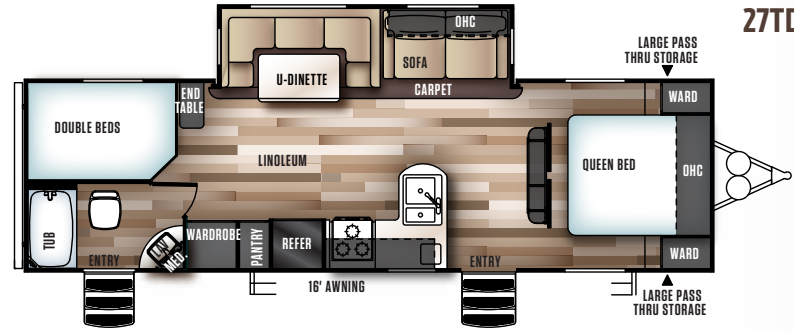

**28CKDS** TBD  
DRY WEIGHT

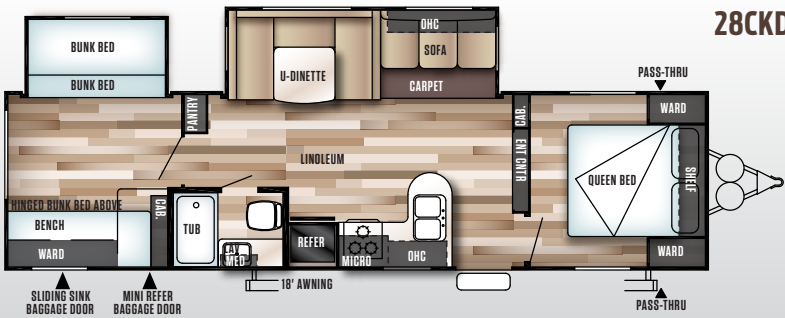

**32BHDS** 8,283  
DRY WEIGHT

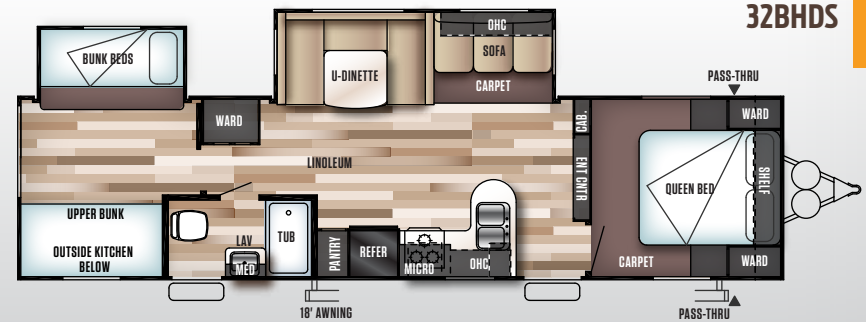

	T27REIS	T27RKSS	T27RLSS	T27TDSS	T28CKDS	T32BHDS
HITCH WEIGHT (LBS.)	TBD	860	678	810	TBD	910
DRY SHIP WEIGHT (LBS.)	TBD	6798	6722	7162	TBD	8283
CARGO CARRYING CAPACITY (LBS.)	TBD	2862	2756	2448	TBD	2787
EXTERIOR LENGTH	TBD	33'8"	32'8"	32'8"	TBD	36'7"
EXTERIOR HEIGHT	TBD	11'3"	11'3"	11'3"	TBD	11'5"
FRESH WATER CAPACITY (GAL.)	TBD	61	61	61	TBD	61
BLACK WATER CAPACITY (GAL.)	TBD	42	42	32	TBD	32
GREY WATER CAPACITY (GAL.)	TBD	66	66	74	TBD	32
AWNING SIZE (FT.)	TBD	16'	16'	16'	TBD	18'

WILDWOOD  
**Floorplan Key**

Pillows and blankets shown on beds and bunks are for demonstration purposes only and do not come with your new coach.

- OHC OVERHEAD CABINET
- WARD WARDROBE
- WARDROBE
- MICRO MICROWAVE
- LAV BATHROOM SINK

# The Wildwood product lineup



WILDWOOD



X-LITE



HERITAGE GLEN



DLX | LODGE

## CUSTOMER SATISFACTION



[www.ForestRiverBuyLocal.com](http://www.ForestRiverBuyLocal.com)

**FREE MEMBERSHIP**  
to Forest River Owners' Group

[www.forestriverfrog.com](http://www.forestriverfrog.com)



**Learn More**  
Scan this barcode using a QR Reader on your smart phone to learn more about Forest River.



A Berkshire Hathaway company.

FOREST RIVER, INC. 55470 C.R. 1 ELKHART, IN 46515 | (574) 533-5934  
[WWW.FORESTRIVERINC.COM/WILDWOOD](http://WWW.FORESTRIVERINC.COM/WILDWOOD) | [WWW.FORESTRIVERACCESSORIES.COM](http://WWW.FORESTRIVERACCESSORIES.COM)

## 24/7 EMERGENCY ROADSIDE ASSISTANCE

For a worry-free ownership experience

Forest River includes one

year of Coach-Net RV Technical & Roadside

Assistance with each RV purchase. Whether

new to the RV lifestyle or an experienced RV enthusiast,

Forest River owners have 24/7 access to technical,

operational and emergency road service

coverage throughout the US & Canada.

Coach-Net's fast, dependable

service is just a phone

call away.

**Coach-Net®**

RV Technical & Roadside Assistance



## PRE-DELIVERY INSPECTION FACILITY

20,000 square feet of quality assurance. The bare essentials for a premium product. This state-of-the-art facility gives immediate daily feedback to production for quality assurance in every unit built.

## Specification Definitions

**GVWR (Gross Vehicle Weight Rating)** - is the maximum permissible weight of the unit when fully loaded. It includes all weights, inclusive of all fluids, cargo, optional equipment and accessories. For safety and product performance do NOT exceed the GVWR.

**GAWR (Gross Axle Weight Rating)** - is the maximum permissible weight, including cargo, fluids, optional equipment and accessories that can be safely supported by a combination of all axles.

**UVW (Unloaded Vehicle Weight)\*** - is the typical weight of the unit as manufactured at the factory. It includes all weight at the unit's axle(s) and tongue or pin and LP Gas. The UVW does not include cargo, fresh potable water, additional optional equipment or dealer installed accessories.

\*Estimated average based on standard build optional equipment.

**CCC (Cargo Carrying Capacity)\*\*** - is the amount of weight available for fresh potable water, cargo, additional optional equipment and accessories. CCC is equal to GVWR minus UVW. Available CCC should accommodate fresh potable water (8.3 lbs per gallon). Before filling the fresh water tank, empty the black and gray tanks to provide for more cargo capacity.

\*\*Estimated average based on standard build optional equipment

Each Forest River RV is weighed at the manufacturing facility prior to shipping. A label identifying the unloaded vehicle weight of the actual unit and the cargo carrying capacity is applied to every Forest River RV prior to leaving our facilities.

The load capacity of your unit is designated by weight, not by volume, so you cannot necessarily use all available space when loading your unit.

All information contained in this brochure is believed to be accurate at the time of publication. However, during the model year, it may be necessary to make revisions and Forest River, Inc., reserves the right to make all such changes without notice, including prices, colors, materials, equipment and specifications as well as the addition of new models and the discontinuance of models shown in this brochure. Therefore, please consult with your Forest River dealer and confirm the existence of any materials, design or specifications that are material to your purchase decision. Litho. U.S.A. FOR 1398 P/W: 2017.01.16

YOUR WILDWOOD DEALER

2017