

WOLF PACK

GARAGE FIFTH WHEELS & GARAGE TRAVEL TRAILERS

CHEROKEE



# WOLF PACK

GARAGE FIFTH WHEELS & GARAGE TRAVEL TRAILERS



**“YOUR HOUSE HAS A GARAGE. WHY SHOULDN’T YOUR RV?”**



**315PACK12**

**Limited package:**

- \*Not all items available on all models
- 1/2 Convection Oven
- 15K Air Conditioner
- 100 Gallon Fresh Water Capacity
- Aluminum Wheels
- Back Up Camera Ready
- Bathroom Fantastic Fan
- Detachable Coil Spray Hose
- Drop In Cooktop w/Glass Cover
- Wolf Pack Stable Step
- External Fuel Cells w/Pump (30 Gal)\*
- Dual Purpose Backsplash/Cutting Board
- Electric Jacks (Fifth Wheels Only)\*
- Fireplace (Not available on all models)\*
- Friction Hinge Entry Door
- Generator Prep\*
- Happijac Bed Lift System\*
- Industrial Garage Rubber Floor (Separate Garage Models Only)\*
- Internal Accent LED Strip Lighting\*
- Outside TV Bracket and Hook Ups
- Power Awning w/ LED Accent Lighting
- Power Tongue Jack (TT only)\*
- Premium Teddy Bear Bunk Mats
- Pull Out Kitchen Faucet
- Roller Shades
- RVQ Quick Connect
- Roof Ladder
- Sink Cover
- Solar Prep and Wiring
- Screen Wall/Tent Wall
- Spare Tire
- Tire Pressure Monitors
- Upgraded Entertainment Sofa

(not available on all models)\*

- Upgraded Hypoallergenic Evergreen Mattress
- Upgraded Kitchen Appliance Package
- USB Charging Stations (Beds, Bunks, Table where Applicable)
- Ultracold Weather Heated Holding Tank
- 12V Pads
- Wolf Pack King Bed
- Washer/Dryer Prep (Fifth Wheels Only)\*

**Standards**

- 30 Amp Service\* (Travel Trailers Only)
- 50 Amp Service\* (Fifth Wheels Only)
- 35,000 BTU Forced Air Ducted Furnace
- 6 Gallon Gas/Electric DSI Water Heater
- 11 Cubic Foot Residential Refrigerator with 1000 Watt Inverter
- Black Tank Flush
- Detachable Power Cord
- Ducted A/C
- Heated/Enclosed/Insulated Tanks
- External LED Loading and Scare Lights
- Large Exterior Folding Assist Grab Handle
- LED Interior Lights
- Outside Shower With Hot And Cold Water
- Radial Tires
- Real Wood Cabinet Doors and Drawers
- Seamless Countertop
- Sky Light Over Bath
- Tongue and Groove Plywood Floors
- Undermount Sink
- Widebody design



**23PACK15**



**BEDROOM**



## Fifth Wheel Options

- 8 Cubic Ft Gas/Electric Refrigerator
- 5.5 Onan Generator
- Premium Oversize Party Sofa with Recliners (F295PACK13 & F325PACK13 only)
- Premium Recliner Sofa and Sleeper Sofa Combo (315PACK12 Only)
- Ramp Door Patio System
- Second 15k Air Conditioner

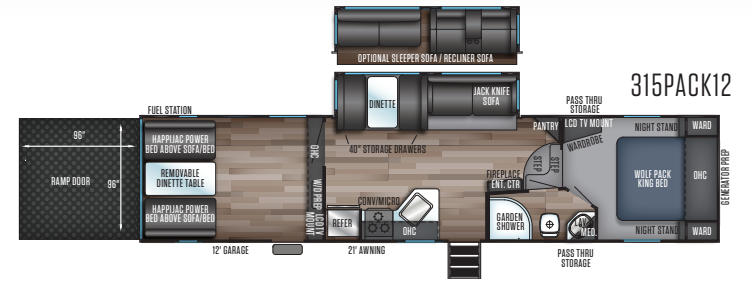
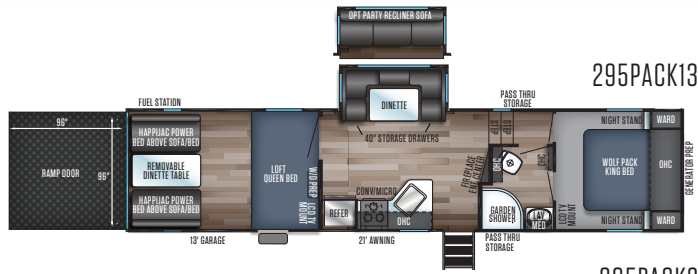

## Travel Trailer Options

- 8 Cubic Ft Gas/Electric Refrigerator
- 4.0 Onan Generator
- Black Euro Recliner Chair
- 2nd Black Euro Recliner Chair
- Electric Jacks (N/A 24PACK14)
- Premium Oversize Party Sofa (25PACK12+ Only)
- Ramp Door Patio System

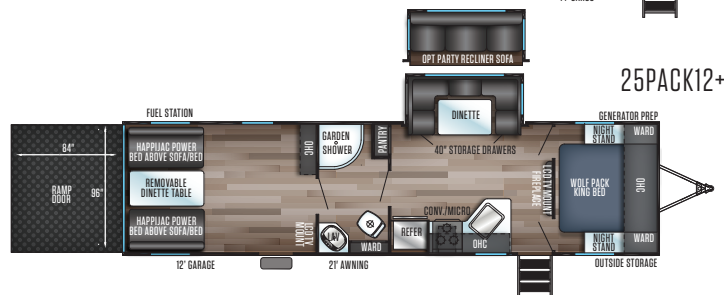
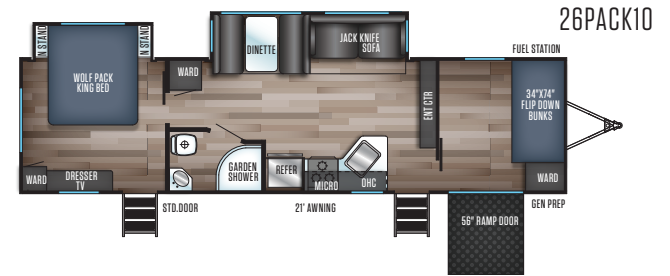
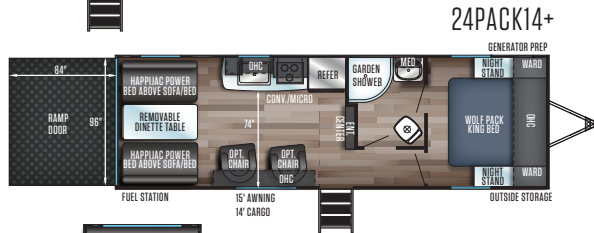
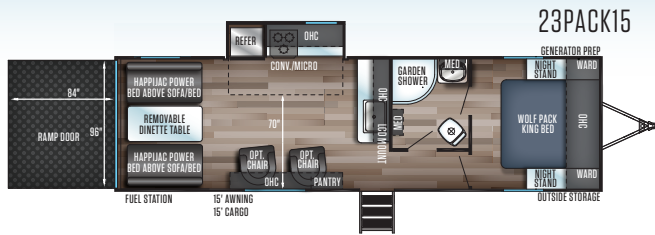



**CUSTOMER SATISFACTION**



[www.ForestRiverBuyLocal.com](http://www.ForestRiverBuyLocal.com)

**FIFTH WHEELS**

	295PACK13	305PACK22	315PACK12	325PACK13	365PACK16
AXLE WEIGHT	8244	TBD	8688	9252	9516
HITCH WEIGHT	2538	TBD	2036	2200	2825
UVW	10820	TBD	10762	11497	12443
CCC	3718	TBD	3274	3999	4382
EXTERIOR LENGTH	38'6"	38'3"	39'3"	40'5"	43'7"
EXTERIOR HEIGHT	13'5"	13'5"	13'5"	13'5"	13'5"
EXTERIOR WIDTH	102	102	102	102	102
FRESH WATER	100	100	100	100	100
GREY WATER	38	38	38	38	76
BLACK WATER	38	38	38	76	76
AWNING	21'	21'	21'	24'	24'

**TRAVEL TRAILERS**

23PACK15	24PACK14+	25PACK12+	26PACK10	27PACK10
6264	5320	7466	TBD	TBD
994	1015	1142	TBD	TBD
7296	6373	8646	TBD	TBD
3612	3898	2696	TBD	TBD
32'11"	31'0"	37'7"	37'3"	TBD
12'5"	12'5"	12'5"	12'5"	12'5"
102	102	102	102	TBD
100	100	100	100	100
38	38	38	38	TBD
38	38	38	38	TBD
15'	15'	21'	21'	TBD



**PRE-DELIVERY INSPECTION FACILITY**

20,000 square feet of quality assurance. The bare essentials for a premium product. This state-of-the-art facility gives immediate daily feedback to production for quality assurance in every unit built.

**FREE MEMBERSHIP**  
to Forest River Owners' Group

[www.forestriverfrog.com](http://www.forestriverfrog.com)

FIND OUT MORE AT:

[HTTP://WWW.FORESTRIVERINC.COM/FIFTH-WHEELS/WOLFPACK](http://WWW.FORESTRIVERINC.COM/FIFTH-WHEELS/WOLFPACK)

YOUR WOLF PACK DEALER



**Learn More**  
Scan this barcode using a QR Reader on your smart phone to learn more about Forest River.



All information contained in this brochure is believed to be accurate at the time of publication. However, during the model year, it may be necessary to make revisions and Forest River, Inc., reserves the right to make all such changes without notice, including prices, colors, materials, equipment and specifications as well as the addition of new models and the discontinuance of models shown in this brochure. Therefore, please consult with your Forest River, Inc., dealer and confirm the existence of any materials, design or specifications that are material to your purchase decision. Litho. U.S.A. FOR 1438 P/W: 2019.03.06



**24/7 EMERGENCY  
ROADSIDE ASSISTANCE  
WITH VEHICLE PURCHASE\***

TOWING  
JUMP-STARTS  
TIRE CHANGES  
FLUID DELIVERY  
LOCKOUT  
SERVICE

WINCH-OUT  
MOBILE MECHANIC  
TECHNICAL  
SUPPORT  
DEALER LOCATOR  
SERVICES



\*VALID FOR 1 YEAR FROM DATE OF PURCHASE

**Specification Definitions**

**GVWR (Gross Vehicle Weight Rating)** - is the maximum permissible weight of the unit when fully loaded. It includes all weights, inclusive of all fluids, cargo, optional equipment and accessories. For safety and product performance do NOT exceed the GVWR.

**GAWR (Gross Axle Weight Rating)** - is the maximum permissible weight, including cargo, fluids, optional equipment and accessories that can be safely supported by a combination of all axles.

**UVW (Unloaded Vehicle Weight)\*** - is the typical weight of the unit as manufactured at the factory. It includes all weight at the unit's axle(s) and tongue or pin and LP Gas. The UVW does not include cargo, fresh potable water, additional optional equipment or dealer installed accessories.

\*Estimated average based on standard build optional equipment.

**CCC (Cargo Carrying Capacity)\*\*** - is the amount of weight available for fresh potable water, cargo, additional optional equipment and accessories. CCC is equal to GVWR minus UVW. Available CCC should accommodate fresh potable water

(8.3 lbs per gallon). Before filling the fresh water tank, empty the black and gray tanks to provide for more cargo capacity.

\*\* Estimated average based on standard build optional equipment

Each Forest River RV is weighed at the manufacturing facility prior to shipping. A label identifying the unloaded vehicle weight of the actual unit and the cargo carrying capacity is applied to every Forest River RV prior to leaving our facilities.

The load capacity of your unit is designated by weight, not by volume, so you cannot necessarily use all available space when loading your unit.