

AMERICA'S PARK CABINS



PREMIUM CABIN SERIES



285 Living Area
(TV not included. Optional items vary by model.)



PREMIUM CABIN SERIES
QUALITY, DURABILITY AND VERSATILITY YOUR
INVESTMENT DEMANDS AND YOUR GUESTS EXPECT YEAR
AFTER YEAR.

The rustic elegance of Forest River Premium Rental Cabins offer guests memorable camping experiences they'll want to share with their family and friends again and again. A wide variety of floorplans are available, from studio cabins to cabins with sleeping accommodations for up to 8 guests. Forest River Premium Cabins will not only meet but will exceed your expectations.

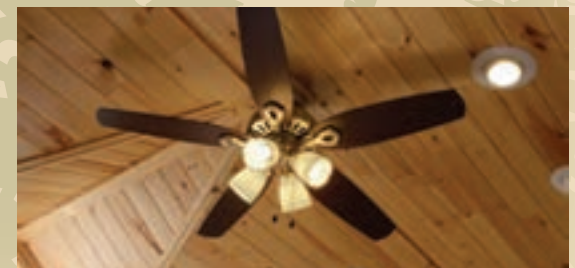

PREMIUM CABIN SERIES STANDARDS AND OPTIONS

EXTERIOR

- WHITE THERMOPANE WINDOWS W/LOW-E GLASS
- 12" FRONT & REAR OVERHANGS
- 8" SIDEWALL EAVES
- GREEN METAL ROOF
- PRE-FINISHED CEMENT LAP SIDING-MAHOGANY COLOR
- 36" WHITE EXTERIOR FRONT DOOR W/INTERNAL BLIND
- "CABIN" STYLE PORCH LIGHT @ EXTERIOR DOOR
- EXTERIOR GFI RECEPTACLE
- 5/4 COMPOSITE DECKING ON PORCH MODELS
- PORCH SUPPORTS/ RAILINGS PAINTED TO MATCH TRIM

INTERIOR

- HARDWOOD INTERIOR PASSAGE/POCKET DOORS
- LEVER DOOR HANDLES
- 90 INCH SIDEWALL HEIGHT
- 1" X 6" T&G PINE WALLS/CEILING
- 1" PINE TRIM THROUGHOUT
- CATHEDRAL CEILINGS (EXCEPT LOFT)
- VAULTED GABLE W/PENT WNDW (PER MODEL)
- 2" WHITE FAUX WOOD WINDOW BLINDS
- VINYL PLANK FLOORING
- BRUSHED SATIN FIXTURES THROUGHOUT
- VINYL MOP BOARD THROUGHOUT
- PREP FOR WALL MOUNT TV - MAIN AREAS
- CEILING FAN W/LIGHT KIT - MAIN AREAS
- DOUBLE SWITCHES FOR CEILING FAN
- WOOD DINETTE TABLE & 4 CHAIRS
- 2 CUSHION HIDE A BED SOFA
- QUEEN MATTRESS W/BOX SPRINGS
- 2-BUNK MATTRESSES IN BUNK ROOM (PER PLAN)
- POWDER COATED STEEL BUNK RAIL & LADDER
- SMOKE DETECTOR ON CEILING
- LP GAS-LEAK DETECTOR
- FIRE EXTINGUISHER

BATHROOM & KITCHEN

- HIGH-DEFINITION LAMINATE COUNTERTOPS
- 3" LAMINATE BACKSPLASHES
- STAINLESS STEEL KITCHEN SINK
- COMPOSITE BATH SINK W/OVERFLOW
- LIGHTED BATH EXHAUST FAN
- CURVED SHOWER ROD W/CURTAIN
- 1 PC. FIBERGLASS TUB/SHOWER OR SHOWER STALL
- SINGLE LEVER FAUCET - KITCHEN & BATH
- DOUBLE OVERHEAD WOOD SHELVES IN KITCHEN
- CONCEALED HINGES ON CABINET DOORS
- "DESIGNER" CABINET DOOR PULLS
- APPLIANCE PACKAGE (PER PLAN)

UTILITIES/ INSULATION

- R-14 BATTEN INSULATION IN FLOOR
- R-11 BATTEN INSULATION IN WALLS
- R-22 BATTEN INSULATION IN ROOF
- OSB EXT. SHEATHING W/HOUSEWRAP WIND BARRIER
- RADIANT HEAT W/INDIVIDUAL THERMOSTATS
- 50 AMP ELECTRICAL SERVICE W/POWER CORD
- 20 GALLON ELECTRIC WATER HEATER
- THRU-WALL AC UNIT(S) - PER PLAN
- ILLUMINATED LIGHT SWITCHES - PER LOCATION
- ROCKER STYLE LIGHT SWITCHES - THROUGHOUT
- BLACK IRON GAS PIPING
- PEX WATER LINES W/LOW POINT DRAIN
- IN-LINE WATER SHUT OFF VALVES @ TOILET & SINKS

CONSTRUCTION FEATURES

- SOLID STEEL DUAL I-BEAM CHASSIS
- DETACHABLE HITCH
- POLY-WOVEN SIMPLEX UNDERBELLY MATERIAL
- 2" X 6" DOUBLE PERIMETER FLOOR JOISTS
- 2" X 6" FLOOR JOISTS - 16" O.C.

CONSTRUCTION FEATURES (CONTINUED)

- 2" X 4" SIDEWALL STUDS - 16" O.C.
- T & G FLOOR DECKING
- RAFTERS - 16" O.C.
- INTEGRATED STEEL STRAPPING CONSTRUCTION
- RVIA/ANSI 119.5 SEAL

POPULAR OPTIONS

- LP FURNACE W/HEAT DUCTS
- GLASS-TOP ELECTRIC 2 BURNER COOKTOP
- GAS 2 BURNER COOKTOP W/AUTO- IGNITE
- OVERHEAD KITCHEN CABINET IPO SHELVES
- 30 AMP ELECTRICAL SERVICE
- NO SIDE EAVES (CREDIT)
- ADDITIONAL 8,000 BTU THRU-WALL AC UNIT
- METAL UNDERBELLY



EVERGREEN

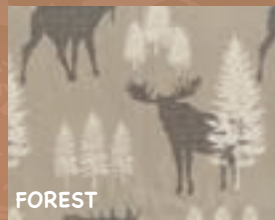

FOREST

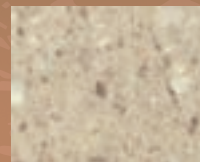

CLASSIC ROCK
COUNTERTOP



PLANK LINOLEUM
FLOORING



TONGUE AND GROOVE
PINE WALL PANEL

DECOR OPTIONS

PREMIUM CABIN FLOORPLANS

NON-LOFT FLOORPLANS

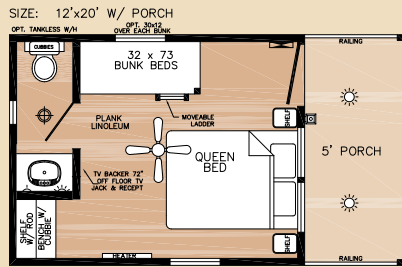

APC PC 15FP

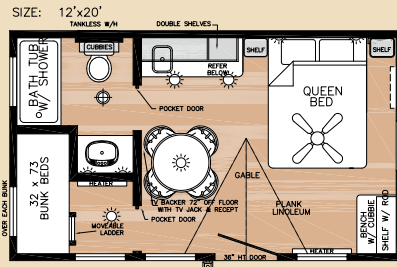

APC PC 20C

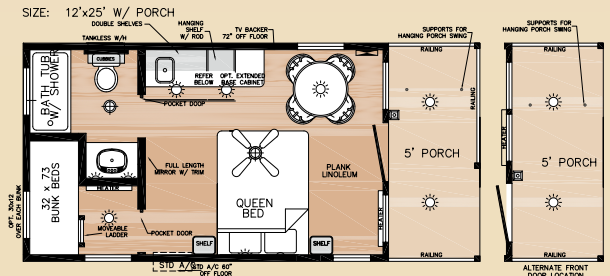

APC PC 20FP

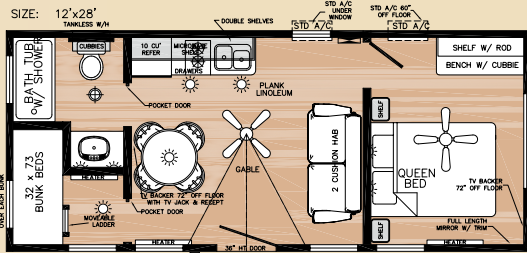

APC PC 28S

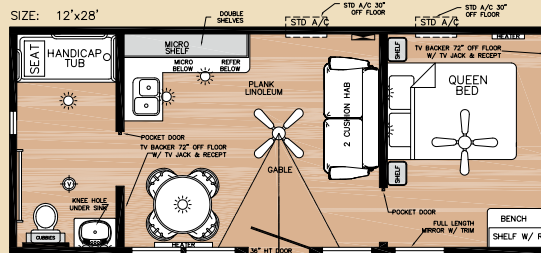

APC PC 28SH

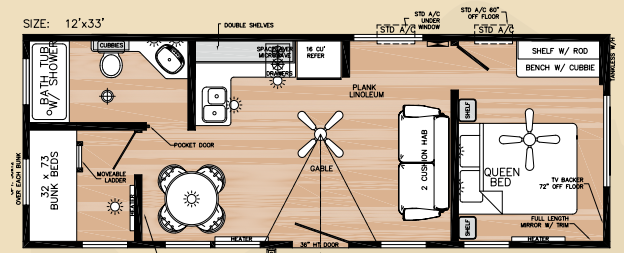

APC PC 33S

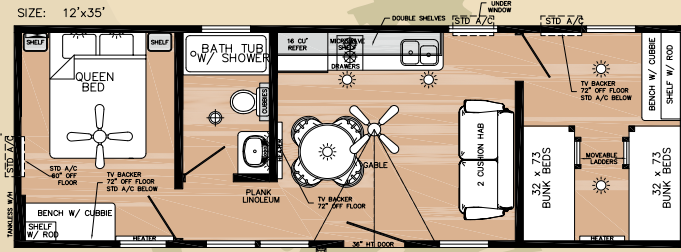

APC PC 35S

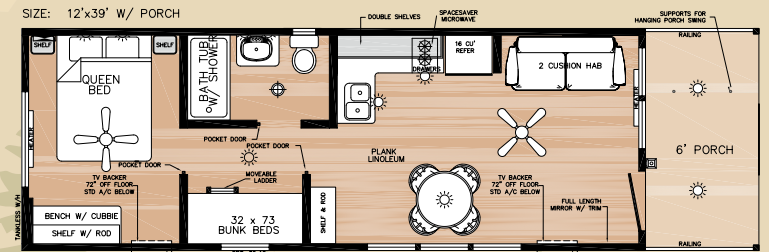

APC PC 33FP

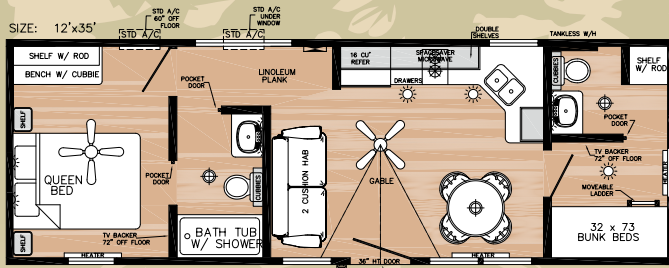

APC PC 35SKG

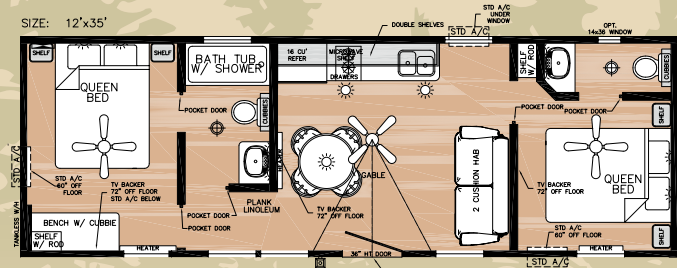

APC PC 35SKQH

LOFT FLOORPLANS

SIZE: 12'x22' W/ PORCH

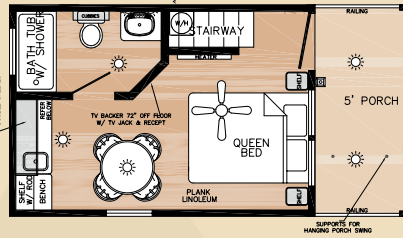
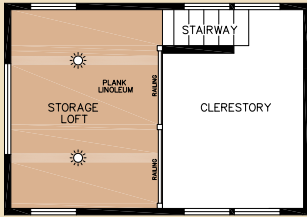

APC PC 17FP

SIZE: 12'x28'

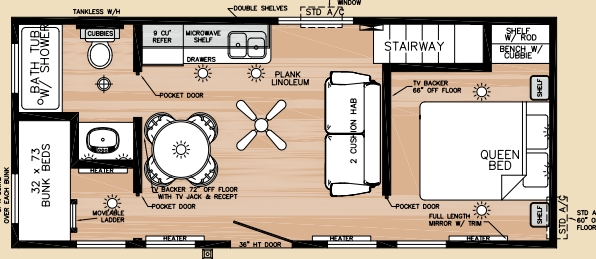
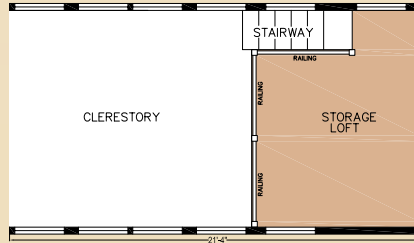

APC PC 28SL

SIZE: 12'x28'

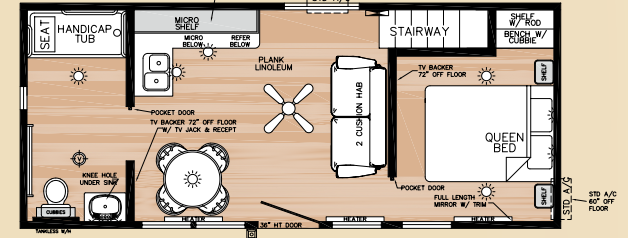
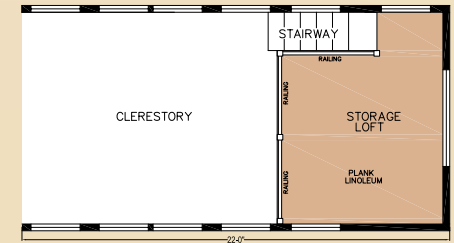

APC PC 28SHL

SIZE: 12'x33'

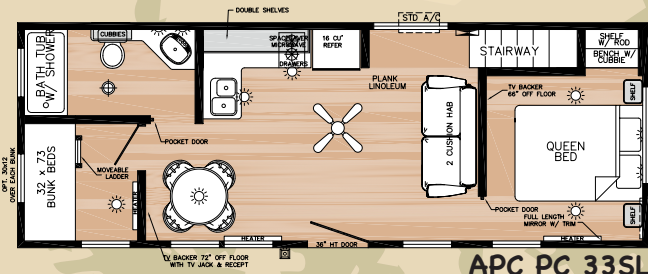
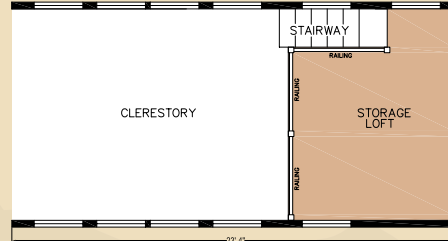

APC PC 33SL

SIZE: 12'x35'

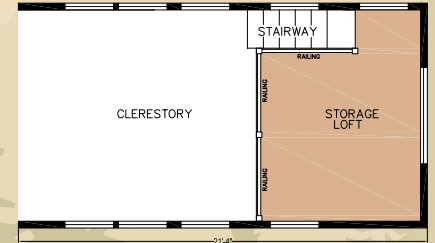

SIZE: 12'x33'

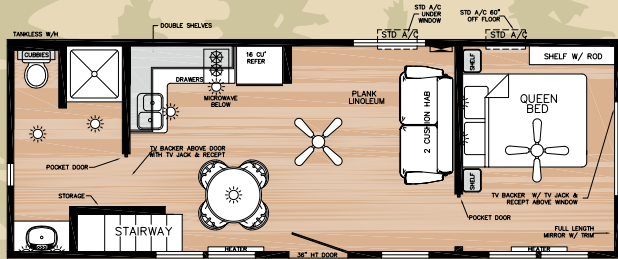
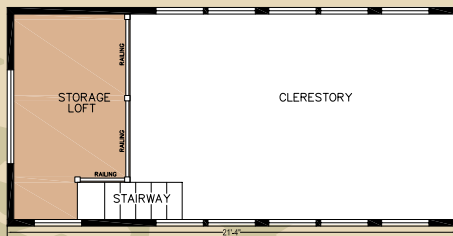

APC PC 33SHPL

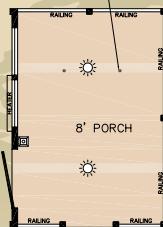

OPTIONAL 8' PORCH

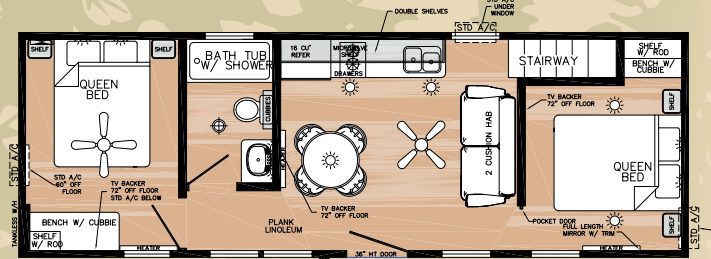

APC PC 35SL



Forest River, Inc. Park Model Division
28936 Phillips St.
Elkhart, IN 46514
Phone: (574) 264-7163
Fax: (574) 264-7364
www.forestriverinc.com
www.forestriveraccessories.com



Learn More
Scan this barcode using
a QR Reader on your
smart phone to learn
more about Forest River.



A Berkshire Hathaway company.

All information contained in this brochure is believed to be accurate at the time of publication. However, during the model year, it may be necessary to make revisions and Forest River, Inc., reserves the right to make all such changes without notice, including prices, colors, materials, equipment and specifications as well as the addition of new models and the discontinuance of models shown in this brochure. Therefore, please consult with your Forest River dealer and confirm the existence of any materials, design or specifications that are material to your purchase decision. All units are shipped F.O.B. Elkhart, IN CONSULT YOUR LOCAL DEALER FOR WARRANTY INFORMATION

© 2019- America's Park Cabins- a division of Forest River Inc.
A Berkshire Hathaway company