

CHEROKEE

TRAVEL TRAILERS, FIFTH WHEELS, DESTINATION TRAILERS

CHEROKEE

TRAVEL TRAILERS, FIFTH WHEELS, DESTINATION TRAILERS



WHEN THE OPEN ROAD BECKONS AND THE
WANDERLUST STIRS, CHEROKEE, BY FOREST
RIVER, WILL HELP YOU ANSWER THE CALL.

Cherokee travel trailers and fifth wheels are built to give you better comfort, style and value, so you can enjoy your travels to the fullest. Our destination trailers are a luxurious end-of-the-journey in themselves – all available for you.







264DBH

SHOWN IN NATURAL

Designed with impeccable quality, distinctive features, superior comfort and remarkable affordability, the 304 BS stands above the rest. This model features a large super slide and dual slide outs in the rear bunk room for extra space and additional sleeping. The entertainment center with a beautiful fireplace showcases this great floorplan.





264DBH

274VFK

SHOWN IN NATURAL



The 274 DBH is the ultimate family camper. This unit features a double entry and access to the bath from the outdoors. The double bed bunk with ladder allows extra sleeping room for kids and adults as well. Amenities such as the custom kitchen with a large undermount stainless sink, glass cover cook-top and stainless oven, range hood and microwave highlight the cooking area. Our oversized full pantry gives you more than enough storage for groceries and outdoor gear. Also featured is our oversized U-shaped dinette with 2 full length drawers for more room for eating and additional sleeping.





274VFK



274VFK

214JT

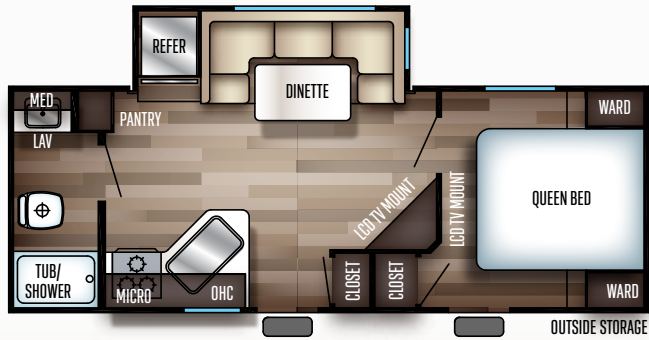

234VFK

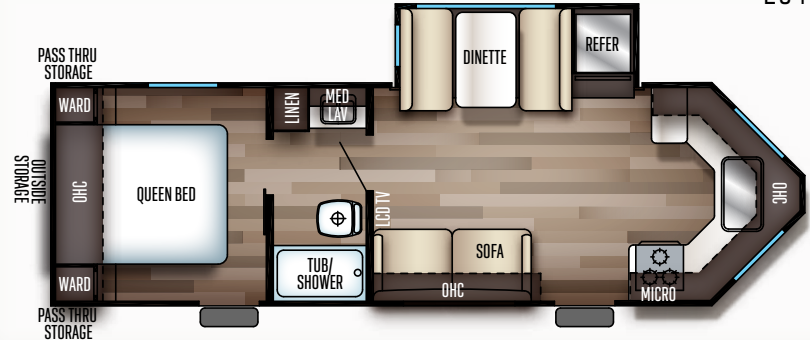

264CK

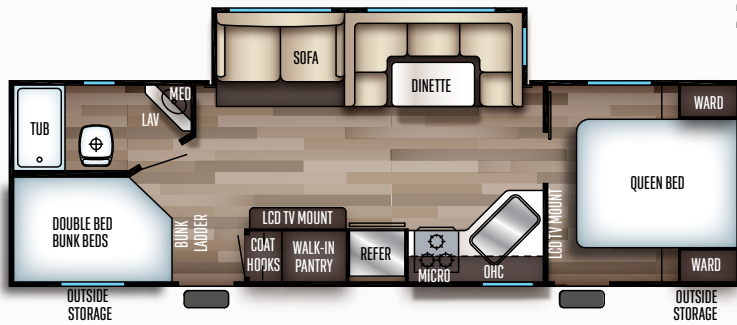

264DBH

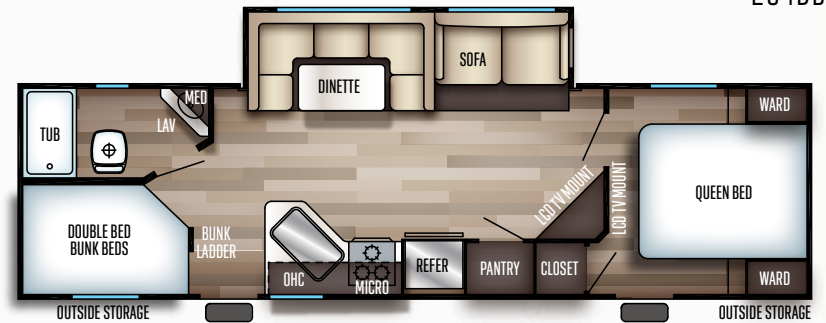

	T214JT	T234VFK	T264CK	T264DBH
DRY HITCH WEIGHT (LBS.)	630-LBS.	823-LBS	885-LBS.	884-LBS.
UNLOADED VEHICLE WEIGHT (LBS.)	5195-LBS.	5917-LBS	6455-LBS.	6760-LBS.
AXLE WEIGHT (LBS.)	4527-LBS.	5056-LBS	5532-LBS.	5838-LBS.
SHIP WEIGHT (LBS.)	5157-LBS.	5879-LBS	6417-LBS.	6722-LBS
CARGO CARRYING CAPACITY (LBS.)	2435-LBS.	1906-LBS	1430-LBS.	1725-LBS.
EXTERIOR LENGTH	26'-4"	29'-0"	32'-0"	33'-0"
EXTERIOR HEIGHT W/ AC	11'-1"	11'-1"	11'-1"	11'-1"
GREY CAPACITY (GAL)	38-GAL	38-GAL	38-GAL	38-GAL
BLACK CAPACITY (GAL)	28-GAL.	38-GAL	38-GAL	28-GAL
FRESH CAPACITY (GAL)	46 GAL	46 GAL	46 GAL	46 GAL

264RL

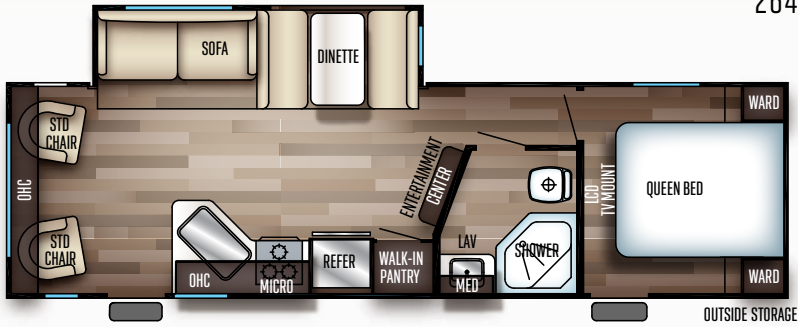

274DBH



274RK

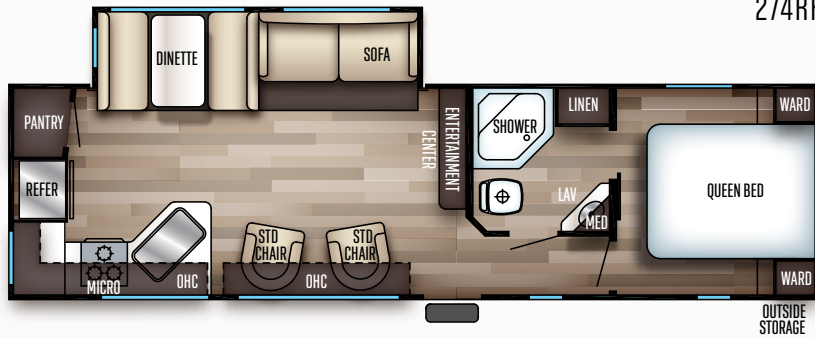

274VFK

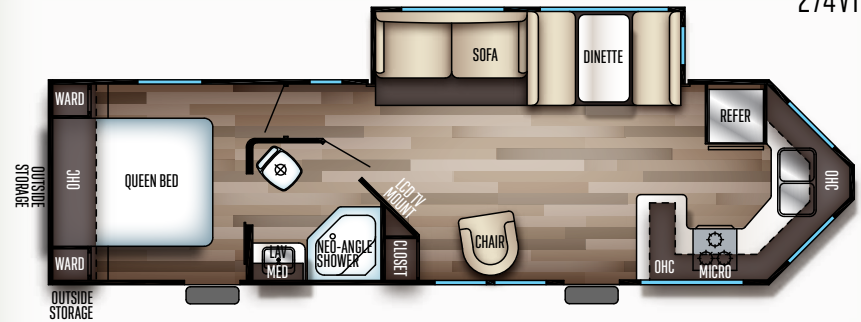

	T264RL	T274DBH	T274RK	T274VFK
DRY HITCH WEIGHT (LBS.)	800-LBS.	732-LBS.	860-LBS.	985-LBS.
UNLOADED VEHICLE WEIGHT (LBS.)	6308-LBS.	6243-LBS.	6742-LBS.	7047-LBS.
AXLE WEIGHT (LBS.)	5508-LBS.	5473-LBS.	5882-LBS.	6024-LBS.
SHIP WEIGHT (LBS.)	6270-LBS.	6202-LBS.	6704-LBS.	7009-LBS.
CARGO CARRYING CAPACITY (LBS.)	3677-LBS.	1489-LBS.	3238-LBS.	2938-LBS.
EXTERIOR LENGTH	32'-5"	31'-8"	33'-7"	33'-7"
EXTERIOR HEIGHT W/ AC	11'-1"	11'-1"	11'-1"	11'-1"
GREY CAPACITY (GAL)	38-GAL	38-GAL	38-GAL	38-GAL
BLACK CAPACITY (GAL)	38-GAL	28-GAL	38-GAL	38-GAL
FRESH CAPACITY (GAL)	46 GAL	46 GAL	46 GAL	46 GAL

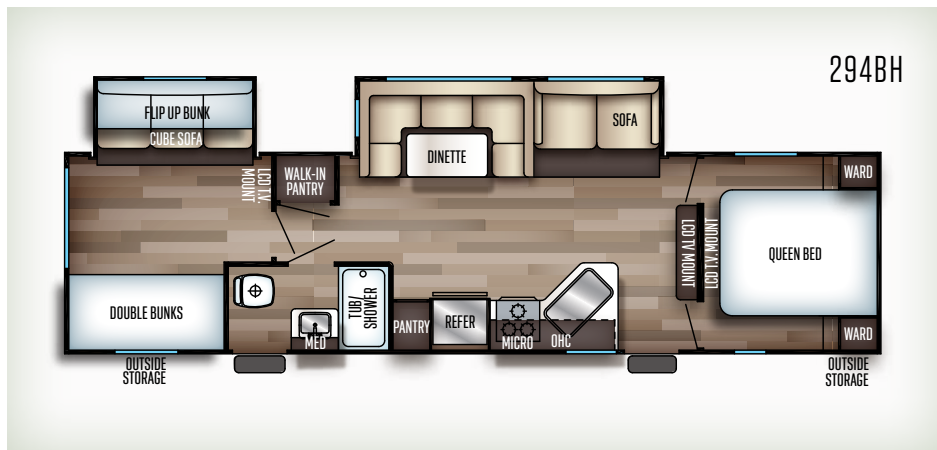
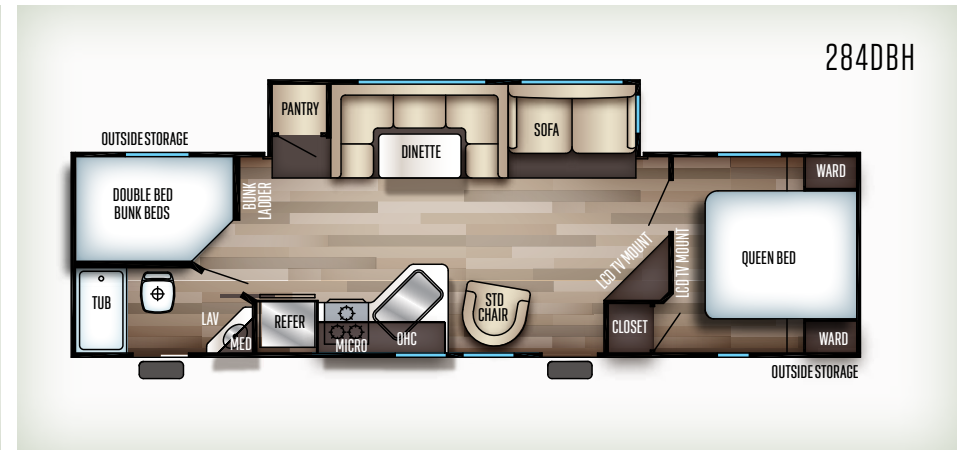
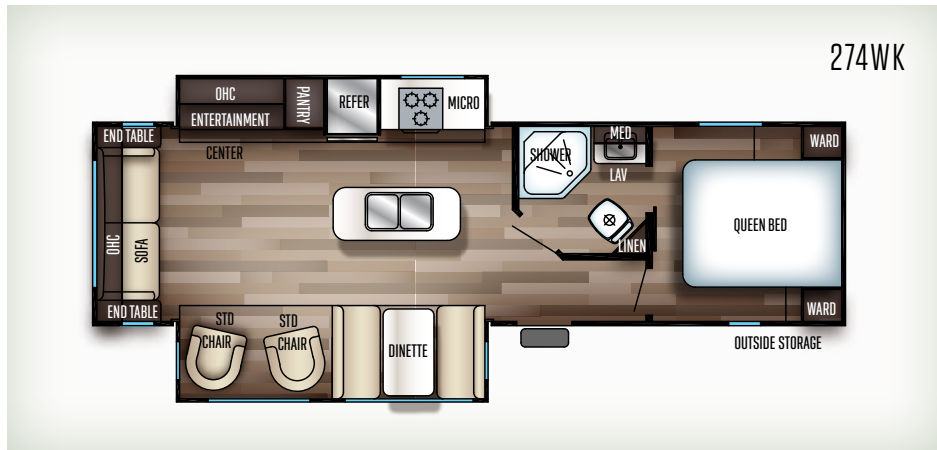

	T274WK	T284DBH	T294BH	T294DBH
DRY HITCH WEIGHT (LBS.)	895-LBS.	TBD	953-LBS	800-LBS.
UNLOADED VEHICLE WEIGHT (LBS.)	7143-LBS.	TBD	7929-LBS.	7133-LBS.
AXLE WEIGHT (LBS.)	6210-LBS.	TBD	6938-LBS.	6295-LBS.
SHIP WEIGHT (LBS.)	7105-LBS.	TBD	7891-LBS.	7095-LBS.
CARGO CARRYING CAPACITY (LBS.)	2842-LBS.	TBD	2056-LBS.	2852-LBS.
EXTERIOR LENGTH	33'-0"	34'-8"	35'-11"	36'-0"
EXTERIOR HEIGHT W/ AC	11'-1"	11'-1"	11'-1"	11'-1"
GREY CAPACITY (GAL)	38-GAL	38-GAL	38-GAL	38-GAL
BLACK CAPACITY (GAL)	38-GAL	38-GAL	38-GAL	38-GAL
FRESH CAPACITY (GAL)	46 GAL	46 GAL	46 GAL	46 GAL

304BH

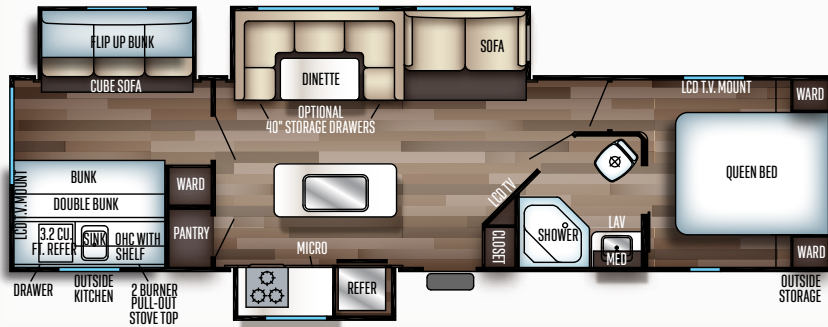

304BS

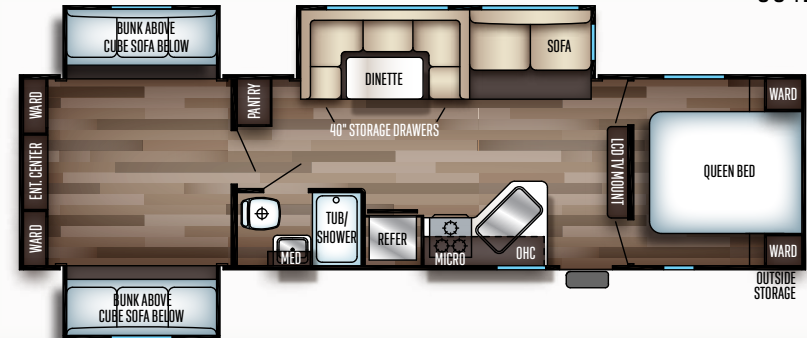

304R

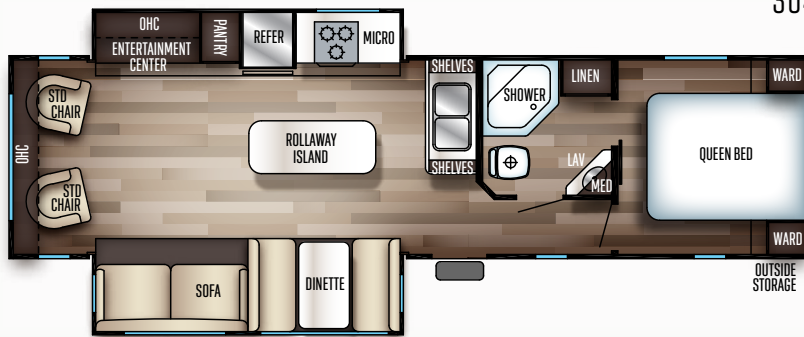

304VFK

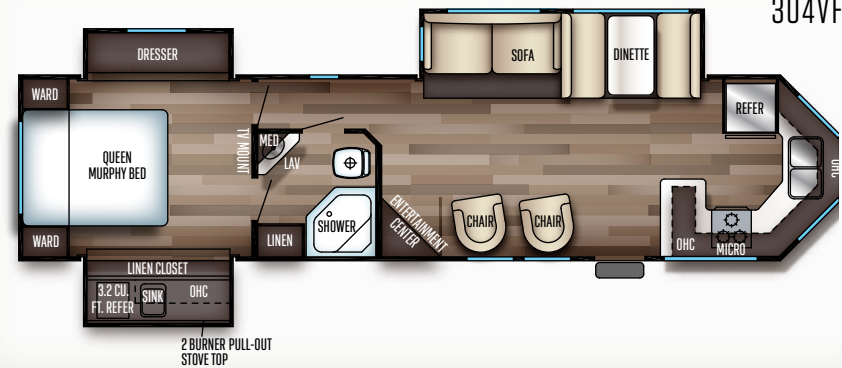

	T304BH	T304BS	T304R	T304VFK
DRY HITCH WEIGHT (LBS.)	1015-LBS.	1015-LBS.	860-LBS.	1154-LBS.
UNLOADED VEHICLE WEIGHT (LBS.)	8688-LBS.	8688-LBS.	7792-LBS.	8822-LBS.
AXLE WEIGHT (LBS.)	7635-LBS.	7635-LBS.	6894-LBS.	7630-LBS.
SHIP WEIGHT (LBS.)	8650-LBS.	8650-LBS.	7754-LBS.	8784-LBS.
CARGO CARRYING CAPACITY (LBS.)	2527-LBS.	2527-LBS.	3268-LBS.	2535-LBS.
EXTERIOR LENGTH	37'-1"	37'-1"	35'-0"	38'-1"
EXTERIOR HEIGHT W/ AC	11'-1"	11'-1"	11'-1"	11'-1"
GREY CAPACITY (GAL)	38-GAL	38-GAL	38-GAL	76-GAL
BLACK CAPACITY (GAL)	38-GAL	38-GAL	38-GAL	38-GAL
FRESH CAPACITY (GAL)	46 GAL	46 GAL	46 GAL	46 GAL



39CA

SHOWN IN NATURAL

The 274 RK features a super slide with a full length sofa with lighted cup holders along with dual oversized recliners. The rear kitchen features abundant counter top space for cooking as well as a full pantry. Extra large windows allow for great views of the outdoors as well as letting more natural light in. A large radius glass door shower and queen walk around bed round out the beauty of the great unit.



39CA

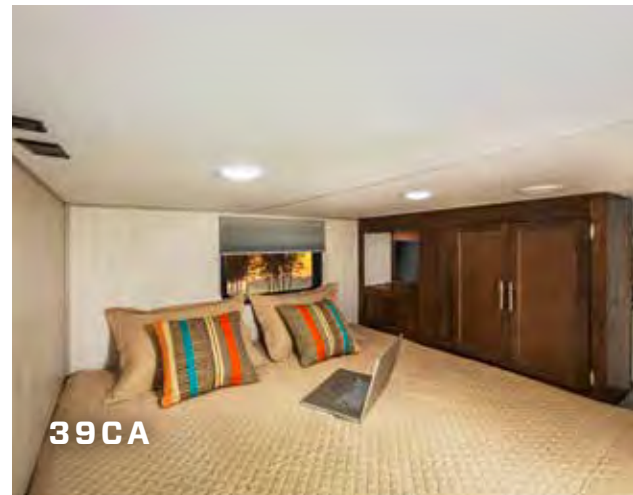

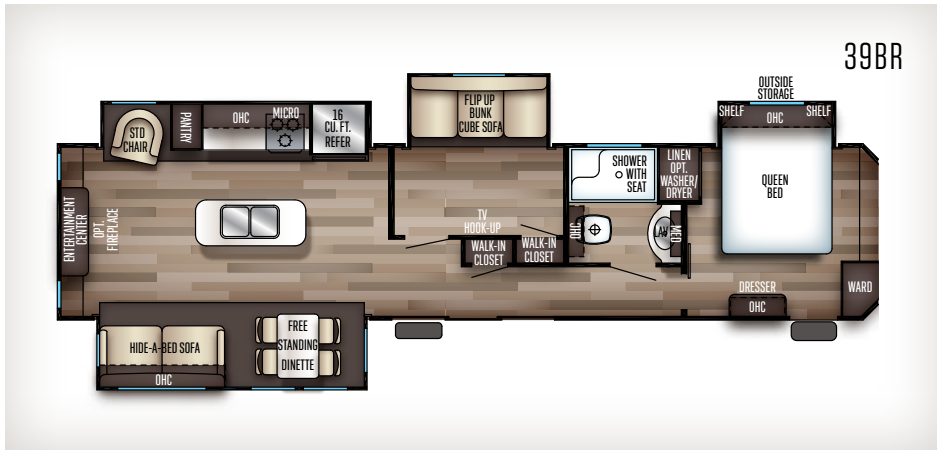

39BR

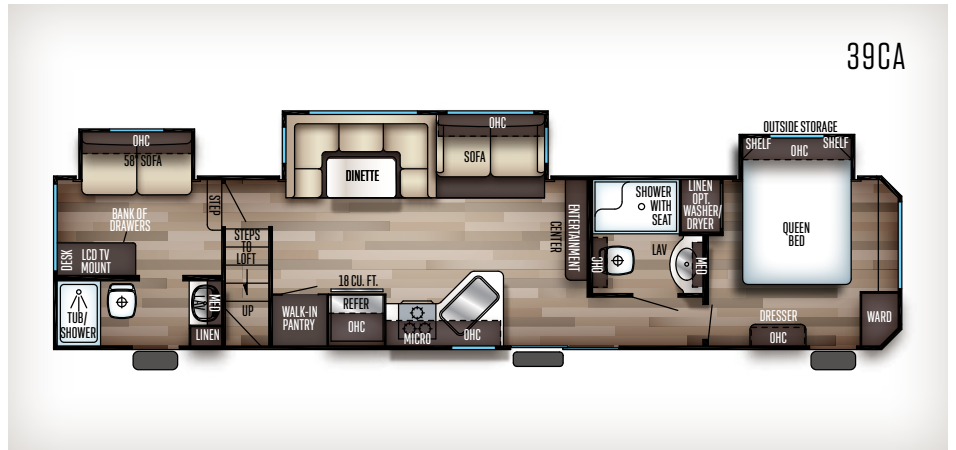

39CA

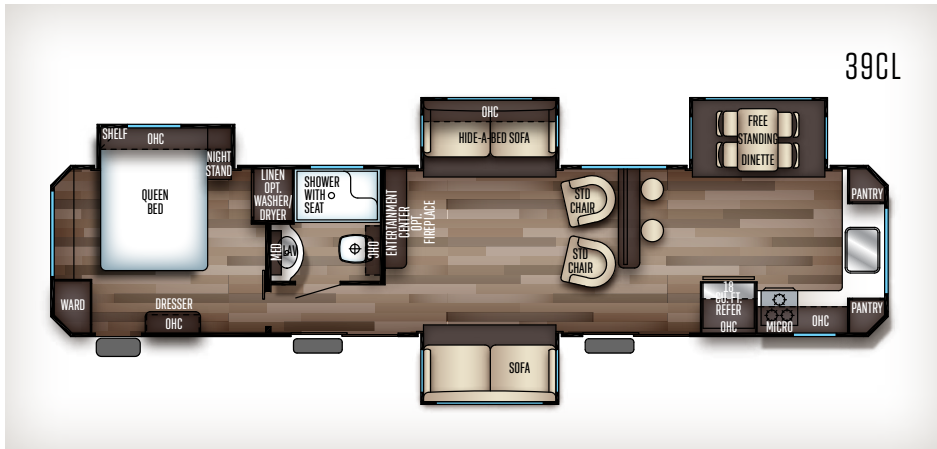

39CL

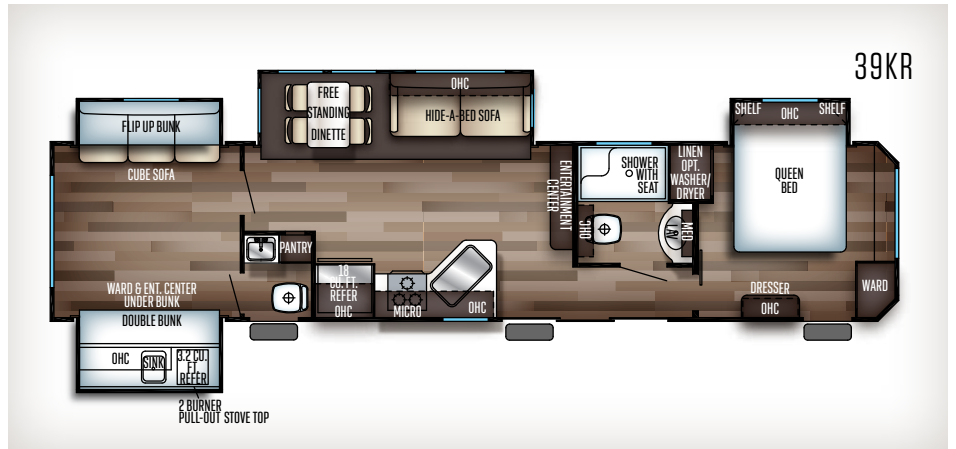

39KR



	T39BR	T39CA	T39CL	T39KR
DRY HITCH WEIGHT (LBS.)	1490-LBS.	1230-LBS.	1342-LBS.	1608-LBS
UNLOADED VEHICLE WEIGHT (LBS.)	10443-LBS.	10523-LBS.	10621-LBS.	10346-LBS
AXLE WEIGHT (LBS.)	8915-LBS.	9255-LBS.	9241-LBS.	8700-LBS.
SHIP WEIGHT (LBS.)	10405-LBS.	10485-LBS.	10583-LBS.	10308-LBS
CARGO CARRYING CAPACITY (LBS.)	1247-LBS.	2707-LBS.	921-LBS.	1462-LBS
EXTERIOR LENGTH	41'-6"	42'-2"	42'-3"	41'-11"
EXTERIOR HEIGHT W/ AC	12'-10"	13'-4"	12'-10"	12'-10"
GREY CAPACITY (GAL)	38-GAL	76-GAL	38-GAL	38-GAL
BLACK CAPACITY (GAL)	38-GAL	66-GAL	38-GAL	66-GAL
FRESH CAPACITY (GAL)	46 GAL	46 GAL	46 GAL	46 GAL

39RESE

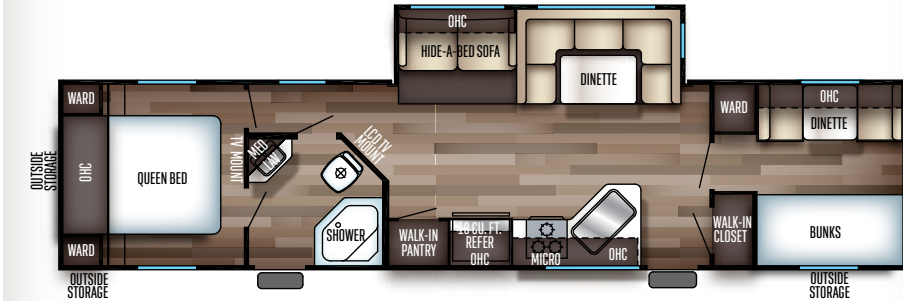

39RL

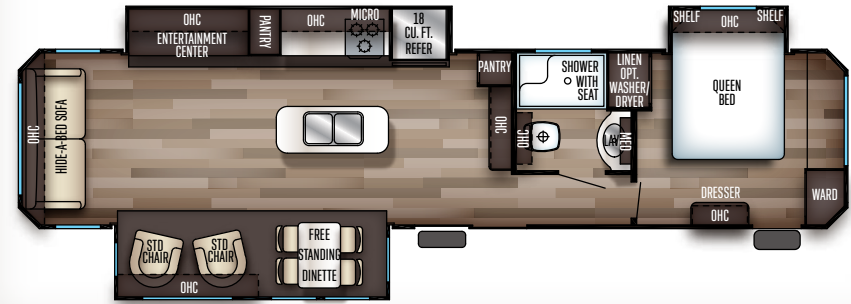

39SR

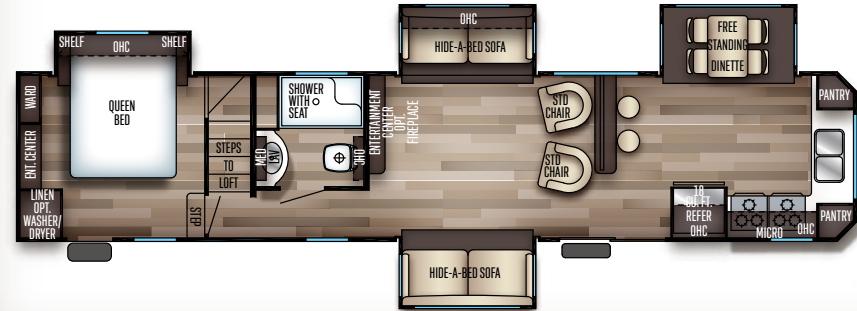

	T39RESE	T39RL	T39SR
DRY HITCH WEIGHT (LBS.)	1608-LBS	1480-LBS.	1480-LBS.
UNLOADED VEHICLE WEIGHT (LBS.)	10346-LBS	10025-LBS.	10025-LBS.
AXLE WEIGHT (LBS.)	8700-LBS.	8507-LBS.	8507-LBS.
SHIP WEIGHT (LBS.)	10308-LBS	9987-LBS.	9987-LBS.
CARGO CARRYING CAPACITY (LBS.)	1462-LBS	1655-LBS.	1655-LBS.
EXTERIOR LENGTH	41'-11"	39'-2"	39'-2"
EXTERIOR HEIGHT W/ AC	12'-10"	12'-10"	12'-10"
GREY CAPACITY (GAL)	38-GAL	38-GAL	38-GAL
BLACK CAPACITY (GAL)	66-GAL	38-GAL	38-GAL
FRESH CAPACITY (GAL)	46 GAL	46 GAL	46 GAL

255 R R

SHOWN IN NATURAL



The 255 RR Fifth Wheel Toy Hauler provides an affordable option for those who like to take adventure on the road. Our featured ramp patio system allows addition space for seating and relaxing.

Cherokee's smart design and remarkable attention to detail is what customers experience when they step inside. A deep level of pride goes into our work and we continue to push ourselves forward when it comes to innovation.







255RR

255RR

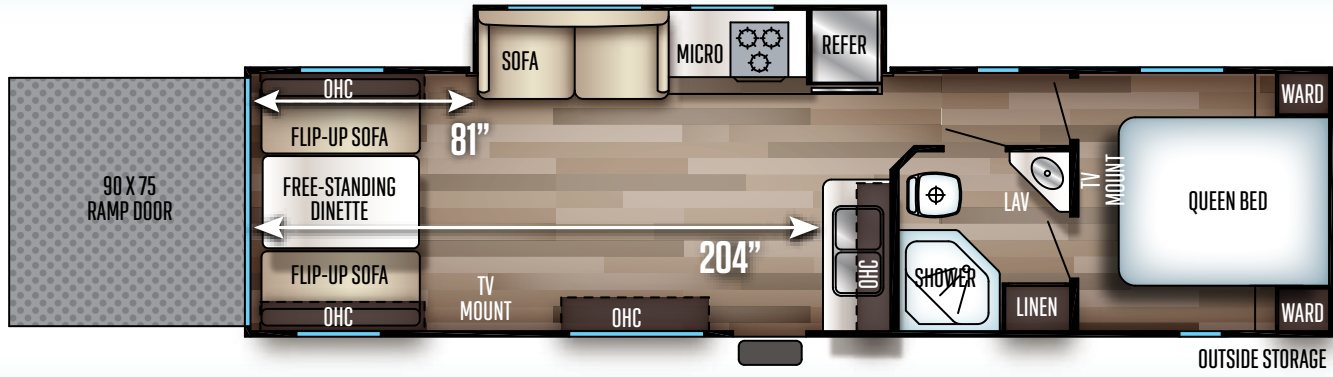

294RR

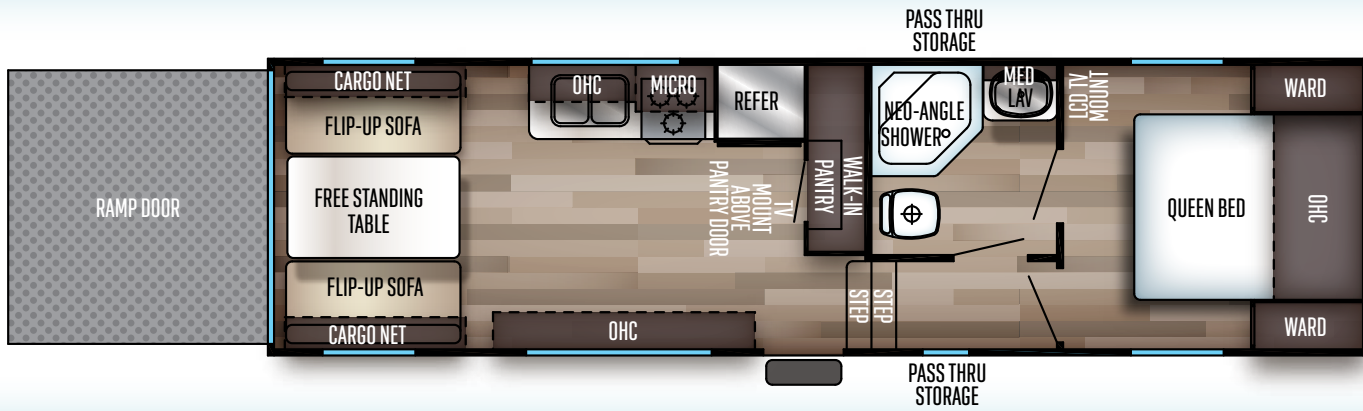

	F255RR	F294RR
DRY HITCH WEIGHT (LBS.)	1415-LBS.	1415-LBS.
UNLOADED VEHICLE WEIGHT (LBS.)	6844-LBS.	6844-LBS.
AXLE WEIGHT (LBS.)	5391-LBS.	5391-LBS.
SHIP WEIGHT (LBS.)	6806-LBS.	6806-LBS.
CARGO CARRYING CAPACITY (LBS.)	4731-LBS.	4731-LBS.
EXTERIOR LENGTH	31'-1"	31'-1"
EXTERIOR HEIGHT W/ AC	13'-5"	13'-5"
GREY CAPACITY (GAL)	38-GAL	38-GAL
BLACK CAPACITY (GAL)	38-GAL	38-GAL
FRESH CAPACITY (GAL)	46 GAL	46 GAL

LIMITED PACKAGE

** Optional package. Not all items available on all models. See participating dealers for details.*



Cherokee Stable Step

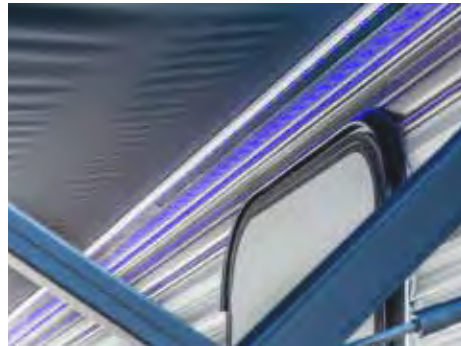

External LED Awning Lights



External Scare Light



Fireplace (not available on all models)



Kitchen Skylight W/ Shade
(N/A on FW & Destination Trailers)

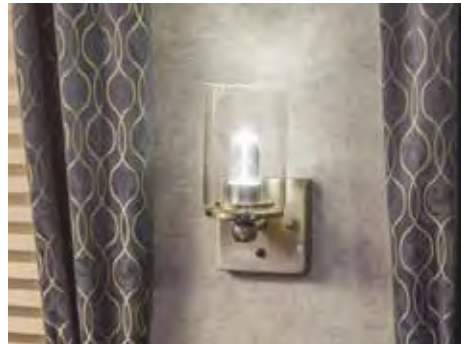

LED Interior Lights



LED Strip Lighting (not available on all models)



Mag Wheels



Night Shades (not available on all models)



Premium Teddy Bear Bunk Mats



Premium Bedding Ensemble and Comforter



Ramp Door Patio System
(Available on RR Models Only)

LIMITED PACKAGE

* Optional package. Not all items available on all models. See participating dealers for details.



Upgraded Designer Glass Backsplash



Super Kitchen



Tire Pressure Monitors



Tub Surround



USB Charging Stations
(Beds, Bunks, Tables where applicable)



Upgraded Entertainment Sofa with lighted cup holders and USB charging port



Upgraded Kitchen Appliance Package

BASECAMP PACKAGE

* Optional package. Not all items available on all models. See participating dealers for details.



Back Up Camera Ready



Outside Shower with Hot and Cold Water



Friction Hinge Entrance Door



Power Awning with Blue Led Strip Lighting



Large Exterior Folding Assist Grab Handle



Black Tank Flush



Flip Down Travel Rack (not available on all models)



Power Tongue Jack(not available on all models)



RVQ Quick Connect



Solar Prep and Wiring



Outside TV Bracket and Hook Ups

CAMPFIRE PACKAGE

* Optional package. Not all items available on all models. See participating dealers for details.



40" Dinette Drawers x 2 (not available on all models)



Sink Cover



6 Gallon Gas/Electric DSI Water Heater

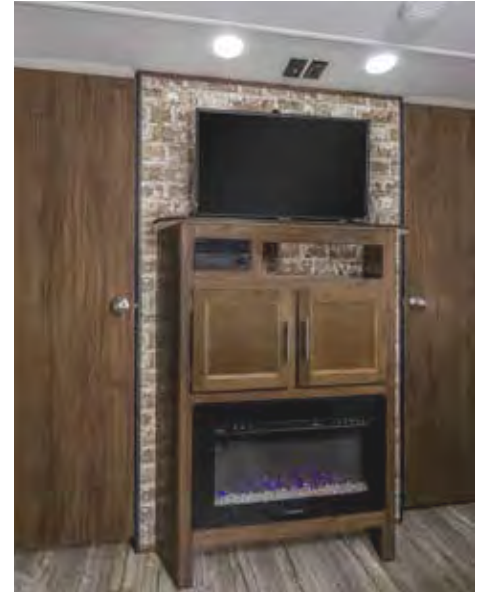

Solid Bedroom Doors (not available on all models)



HDMI Entertainment Center



Skylight over Tub



Oven



Bathroom Fantastic Vent Fan



Ducted A/C (not available on all models)



Cabinets in Bedroom (not available on all models)

CHEROKEE

TRAVEL TRAILERS, FIFTH WHEELS,
DESTINATION TRAILERS

CUSTOMER SATISFACTION



www.ForestRiverBuyLocal.com



PRE-DELIVERY INSPECTION FACILITY

20,000 square feet of quality assurance. The bare essentials for a premium product. This state-of-the-art facility gives immediate daily feedback to production for quality assurance in every unit built.



Learn More

Scan this barcode using a QR Reader on your smart phone to learn more about Forest River.



A Berkshire Hathaway company.



FREE MEMBERSHIP
to Forest River Owners' Group



www.forestriverfrog.com

WWW.FORESTRIVERING.COM

YOUR CHEROKEE DEALER

All information contained in this brochure is believed to be accurate at the time of publication. However, during the model year, it may be necessary to make revisions and Forest River, Inc., reserves the right to make all such changes without notice, including prices, colors, materials, equipment and specifications as well as the addition of new models and the discontinuance of models shown in this brochure. Therefore, please consult with your Forest River, Inc., dealer and confirm the existence of any materials, design or specifications that are material to your purchase decision. Litho. U.S.A. FOR 1516 W: 2019.02.20

24/7 EMERGENCY ROADSIDE ASSISTANCE WITH VEHICLE PURCHASE*

TOWING
JUMP-STARTS
TIRE CHANGES
FLUID DELIVERY
LOCKOUT
SERVICE

WINCH-OUT
MOBILE MECHANIC
TECHNICAL
SUPPORT
DEALER LOCATOR
SERVICES



*VALID FOR 1 YEAR FROM DATE OF PURCHASE

Specification Definitions

GVWR (Gross Vehicle Weight Rating) - is the maximum permissible weight of the unit when fully loaded. It includes all weights, inclusive of all fluids, cargo, optional equipment and accessories. For safety and product performance do NOT exceed the GVWR.

GAWR (Gross Axle Weight Rating) - is the maximum permissible weight, including cargo, fluids, optional equipment and accessories that can be safely supported by a combination of all axles.

UVW (Unloaded Vehicle Weight)* - is the typical weight of the unit as manufactured at the factory. It includes all weight at the unit's axle(s) and tongue or pin and LP Gas. The UVW does not include cargo, fresh potable water, additional optional equipment or dealer installed accessories.

*Estimated average based on standard build optional equipment.

CCC (Cargo Carrying Capacity)** - is the amount of weight available for fresh potable water, cargo, additional optional equipment and accessories. CCC is equal to GVWR minus UVW. Available CCC should accommodate fresh potable water

(8.3 lbs per gallon). Before filling the fresh water tank, empty the black and gray tanks to provide for more cargo capacity.

** Estimated average based on standard build optional equipment

Each Forest River RV is weighed at the manufacturing facility prior to shipping. A label identifying the unloaded vehicle weight of the actual unit and the cargo carrying capacity is applied to every Forest River RV prior to leaving our facilities.

The load capacity of your unit is designated by weight, not by volume, so you cannot necessarily use all available space when loading your unit.