

FORESTER

BY FOREST RIVER

LE

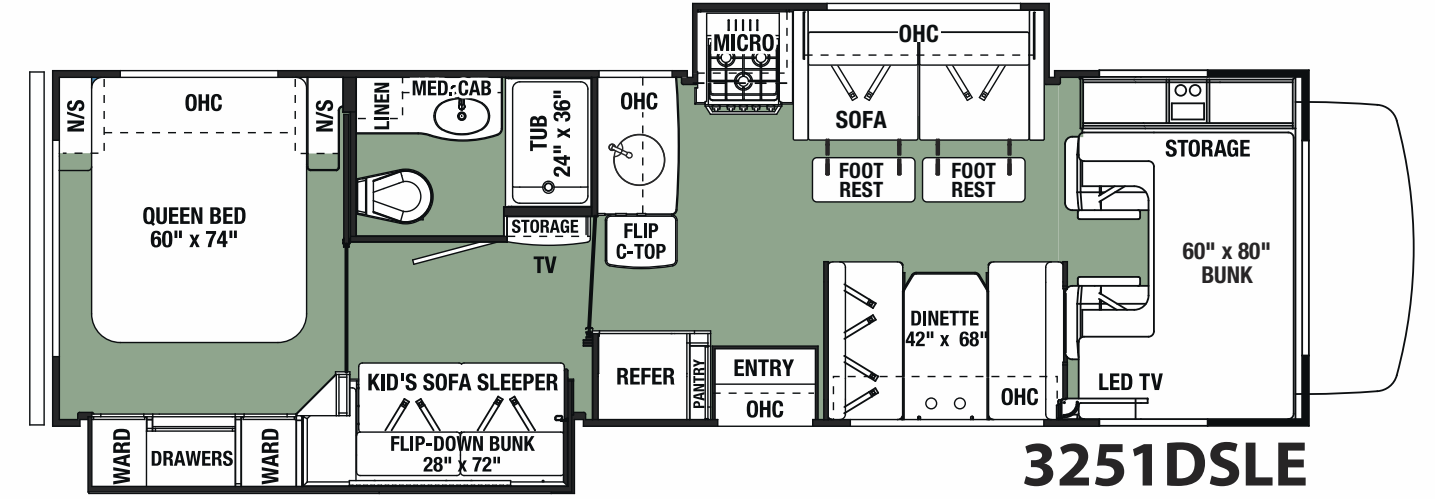
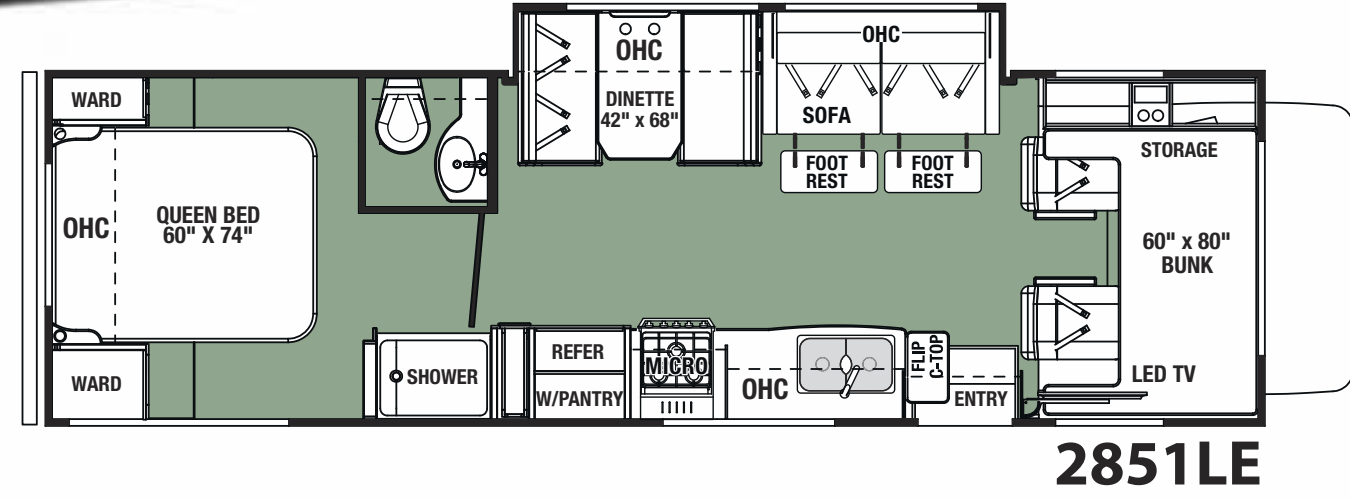
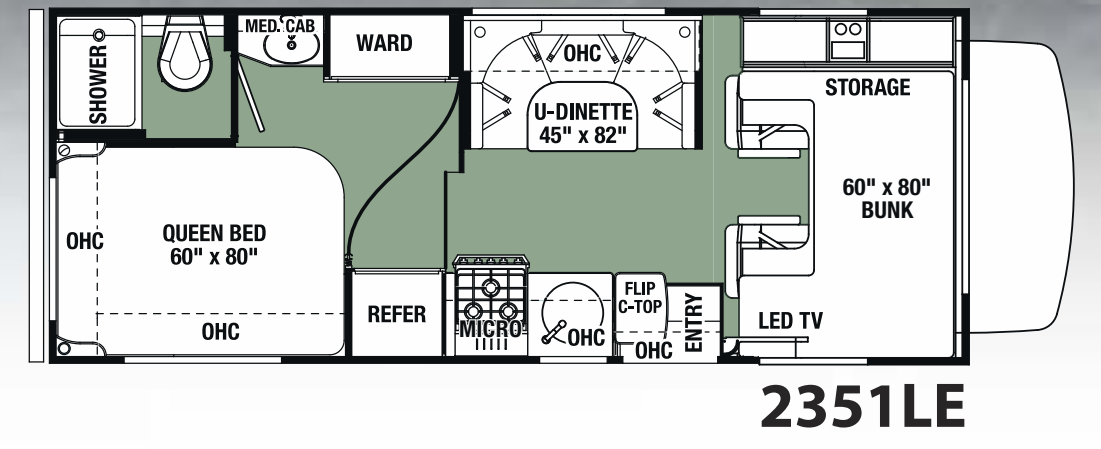
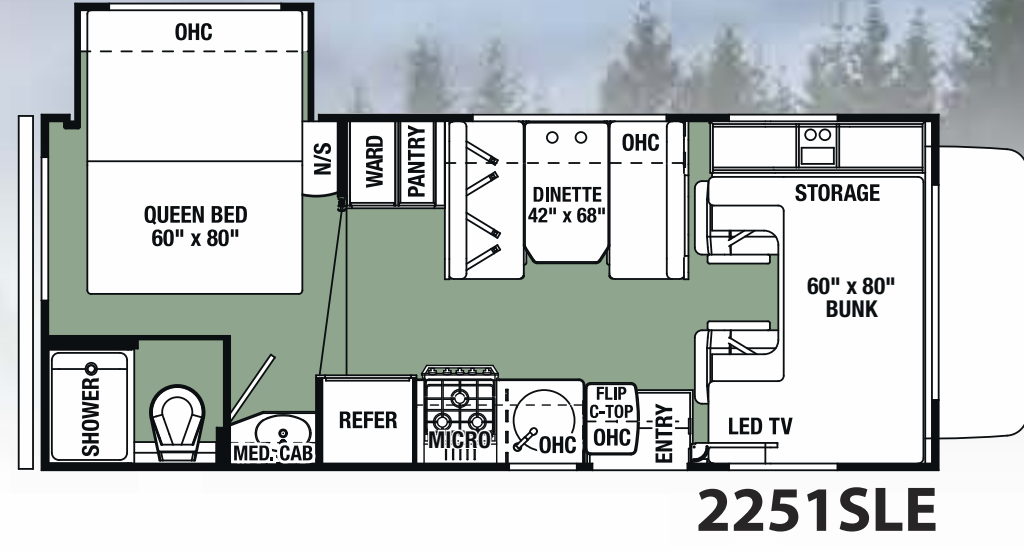

CLASS C



Ocean Blue full body paint option

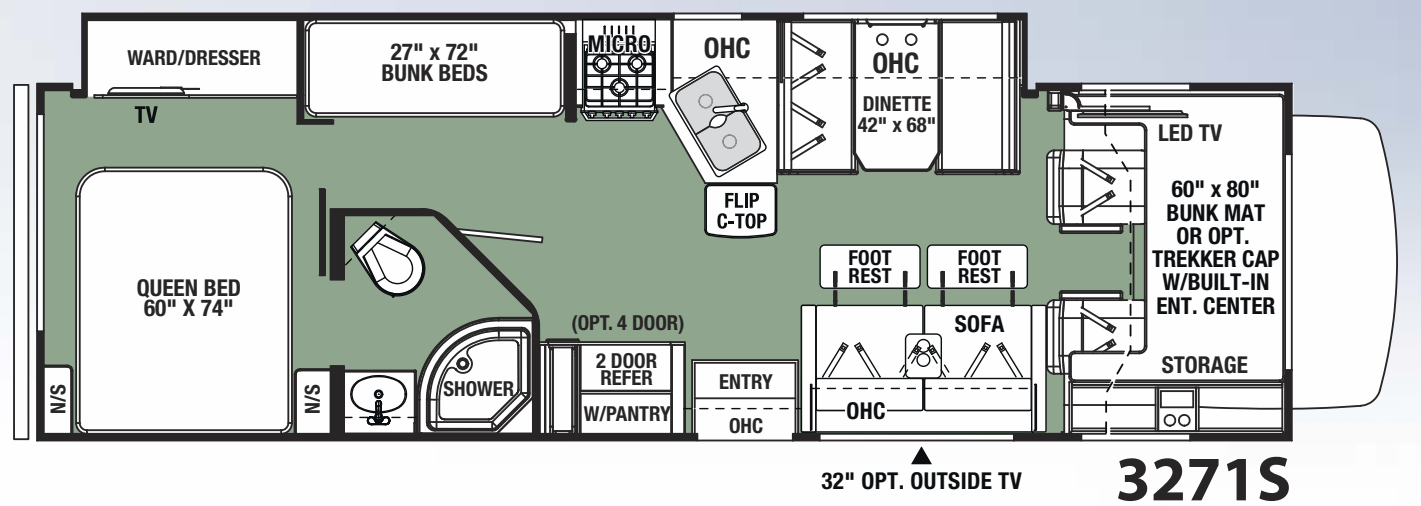
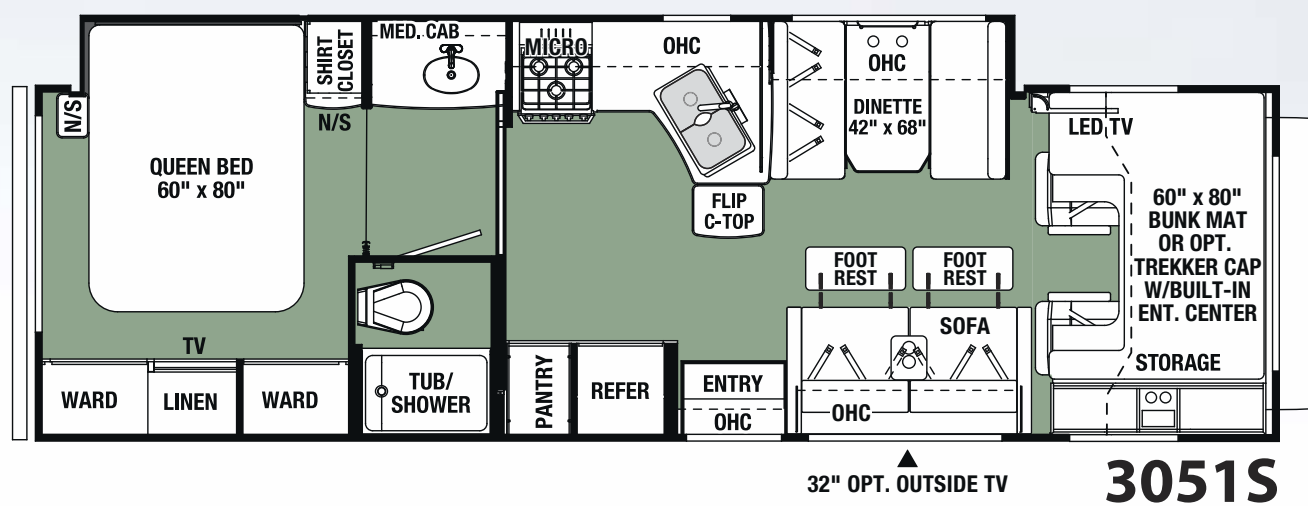
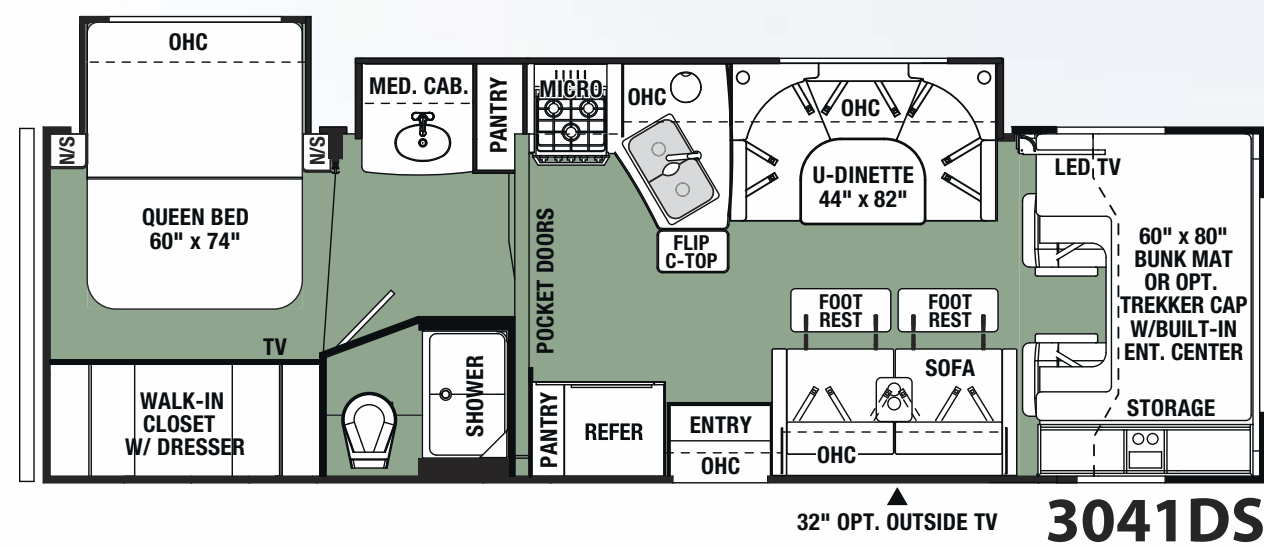
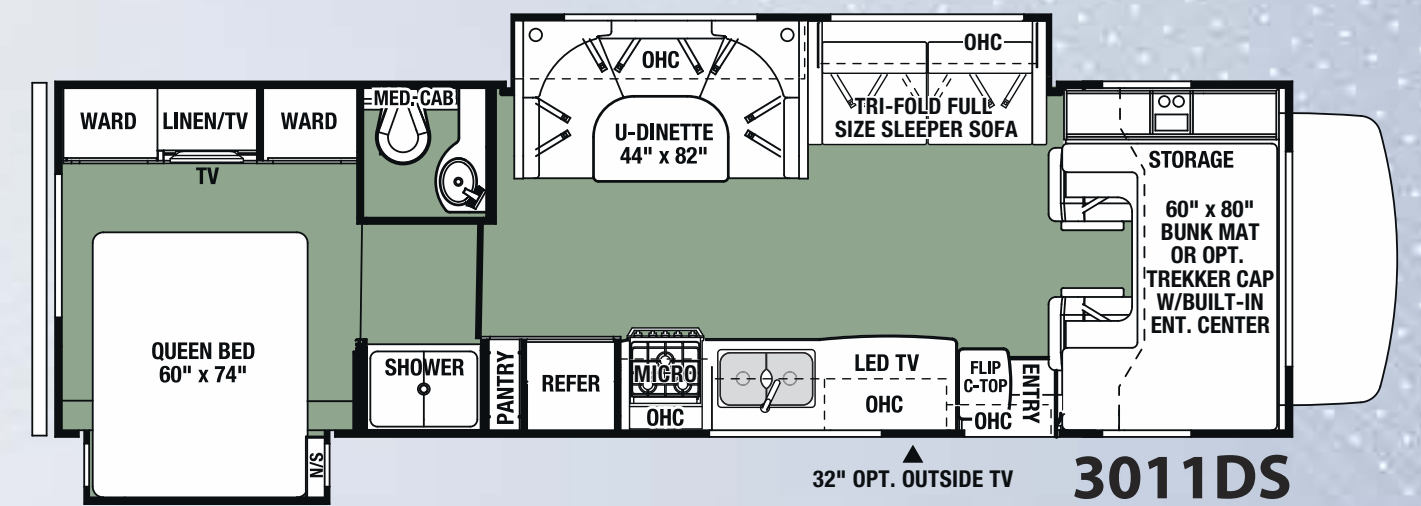
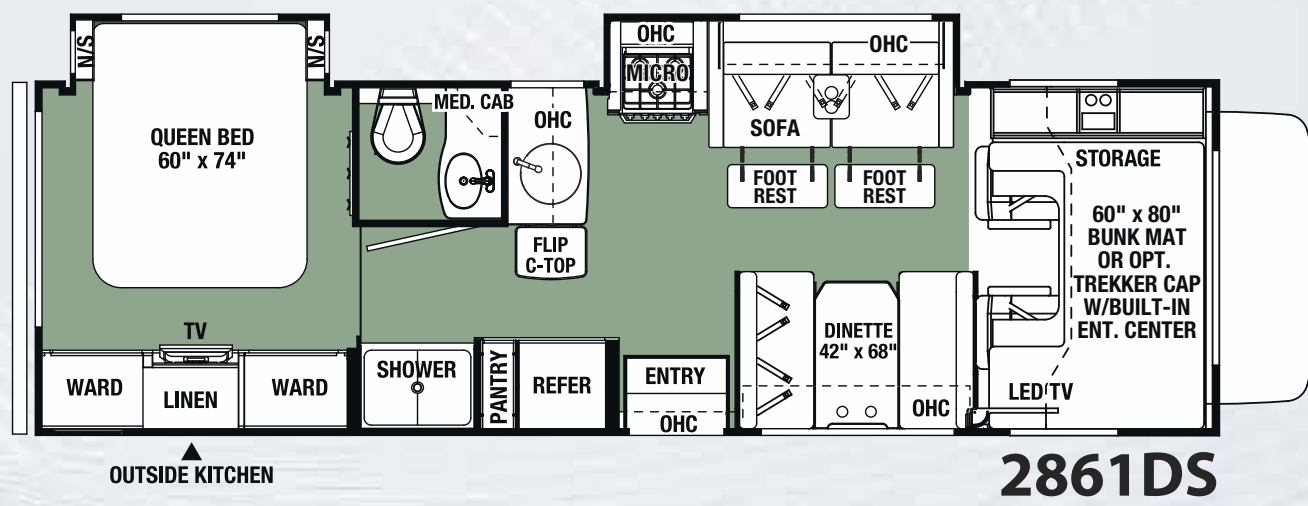
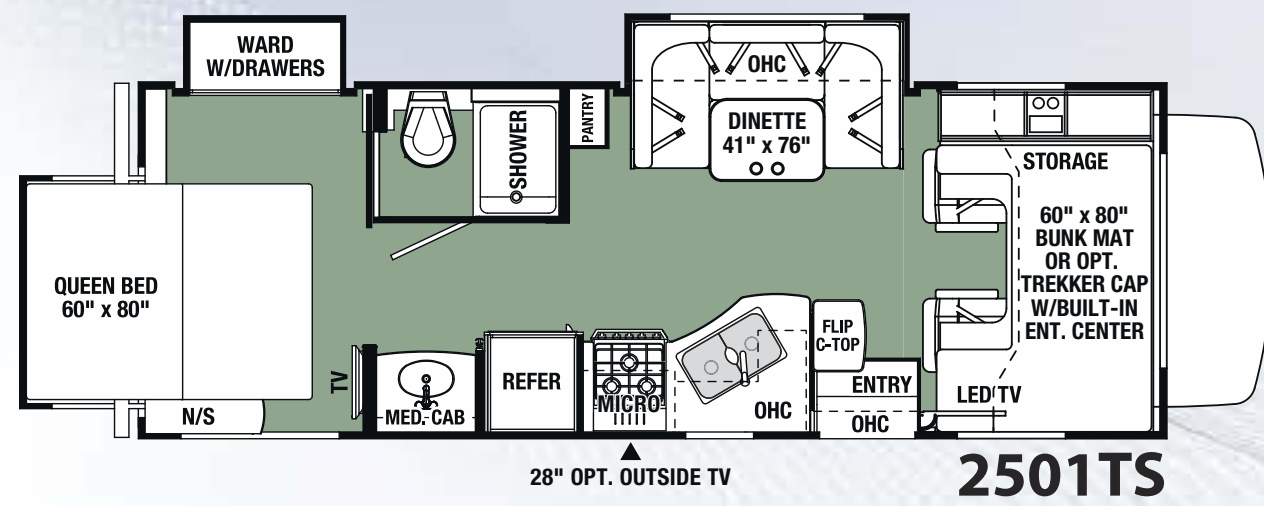
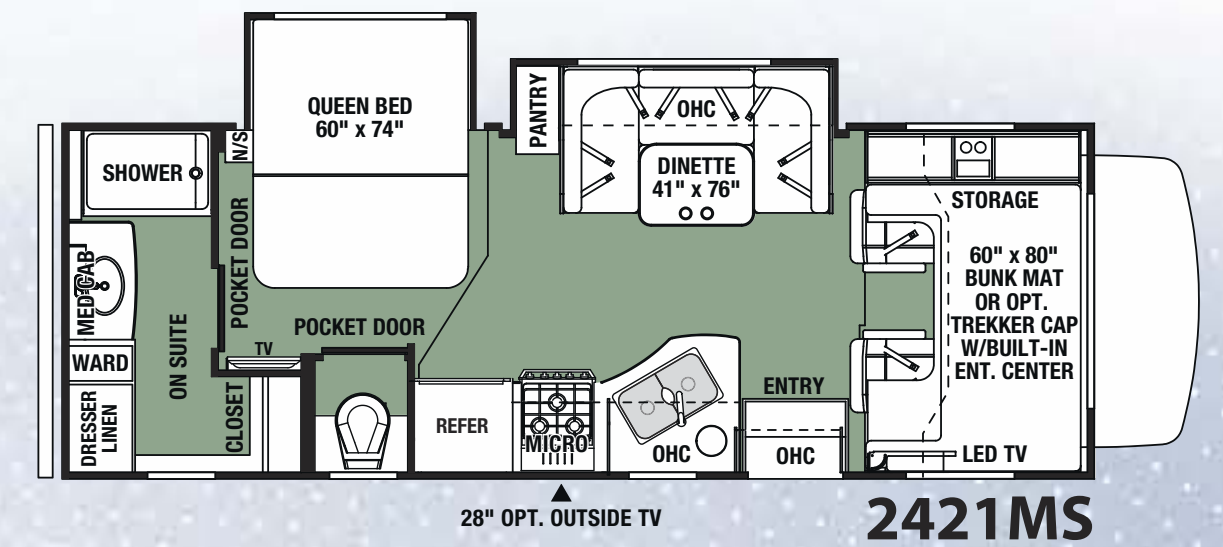
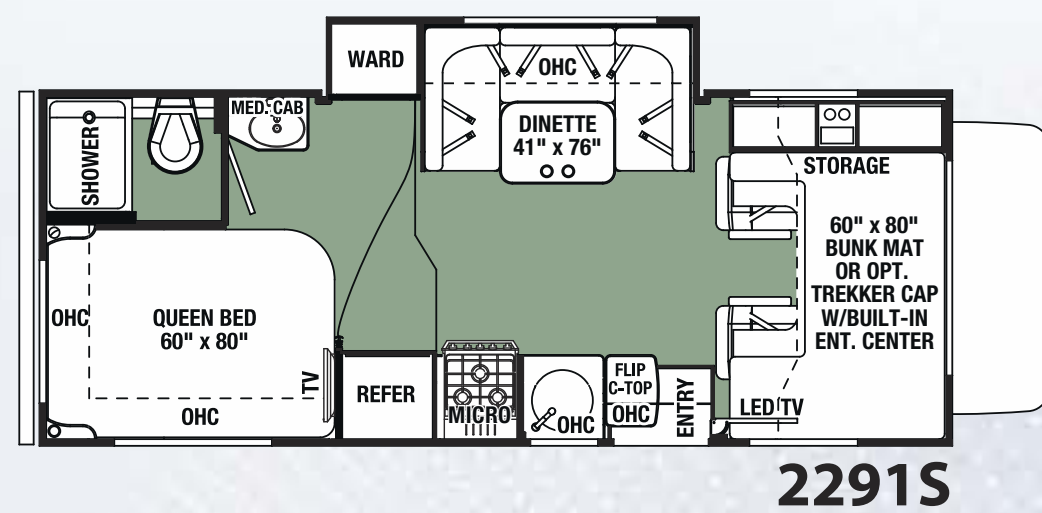

OPTIONS

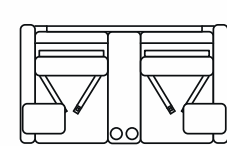

OPT. RECLINERS
3011DS



OPT. SIDE-BY-SIDE REFER
2861DS, 3011DS, 3051S, 3271S

MBS



Saddle full body paint option

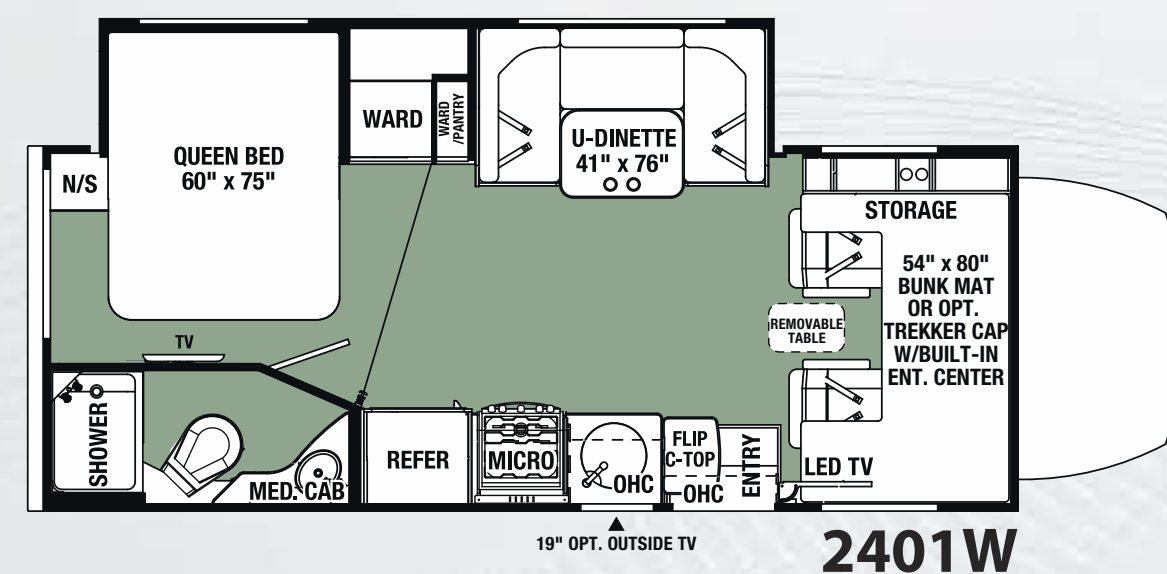
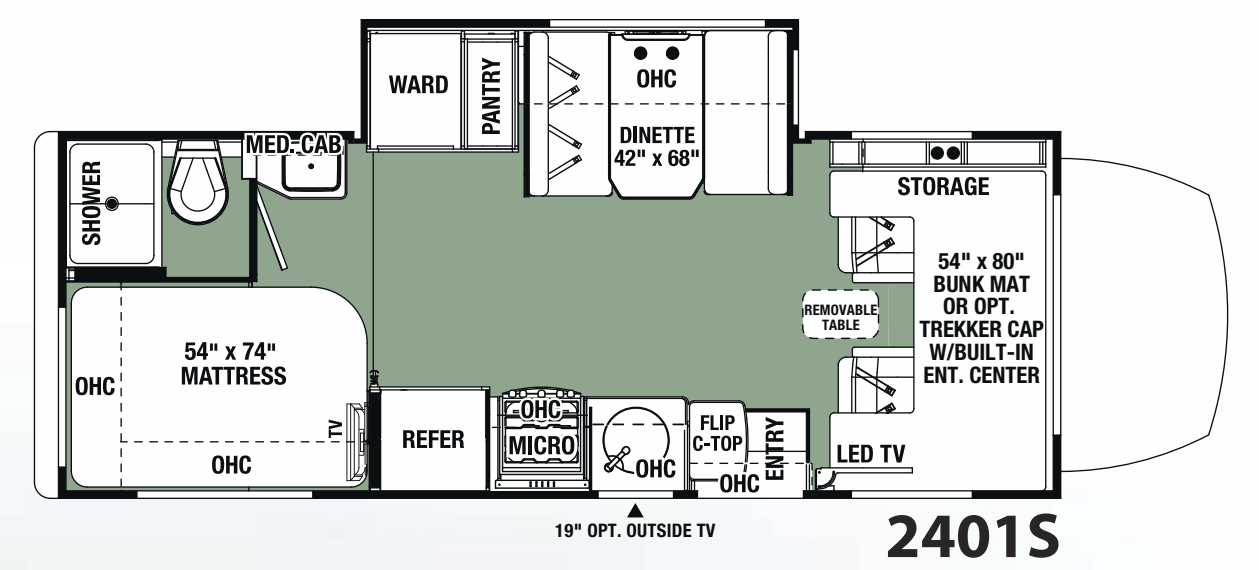
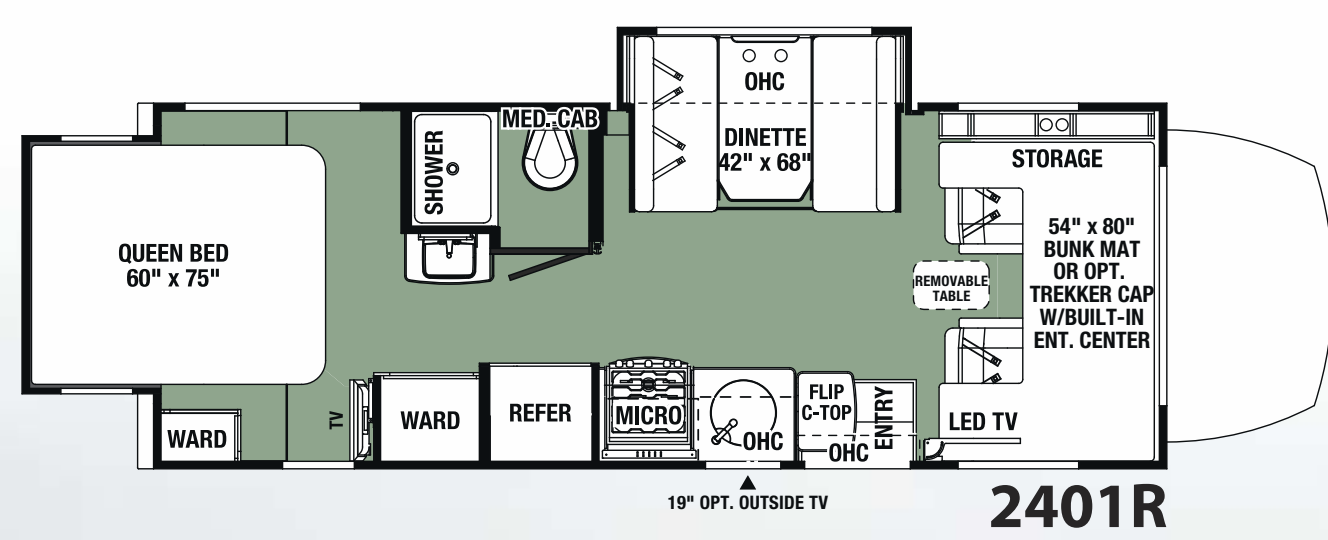

OPTIONS

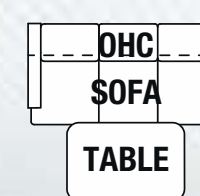

OPT. SOFA
2401R, 2401S, 2401W

TS

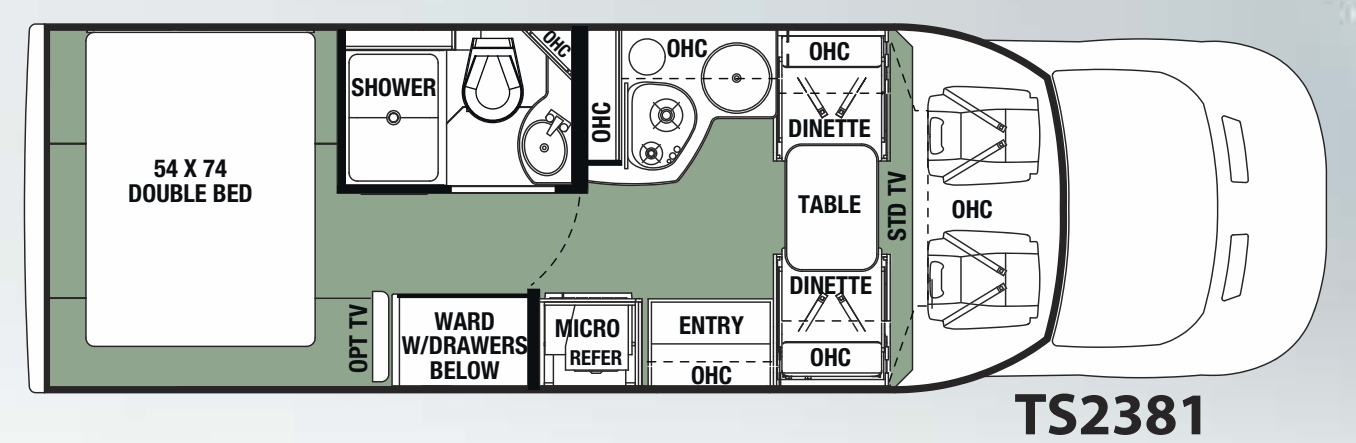
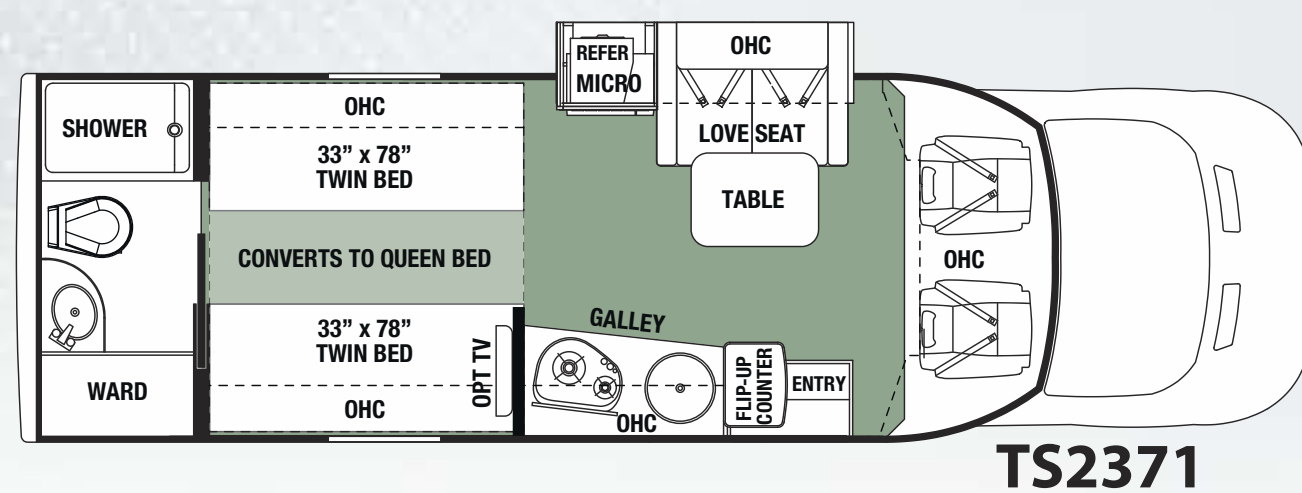

For more information please visit: www.forestriverinc.com/forester • 914 CR 1 • Elkhart, IN 46514 • 574.262.2212 • 800.445.2825

All information contained in this brochure is believed to be accurate at the time of publication. However, during the model year, it may be necessary to make revisions and Forest River, Inc. reserves the right to make all such changes without notice, including prices, colors, materials, equipment and specifications as well as the addition of new models and the discontinuance of models shown in this brochure. Therefore, please consult with your Forest River dealer and confirm the existence of any materials, design or specifications that are material to your purchase decision. ©2018 Forester - a Division of Forest River, Inc. - a Berkshire Hathaway Company 8/18

