

Berkshire_{XLT}

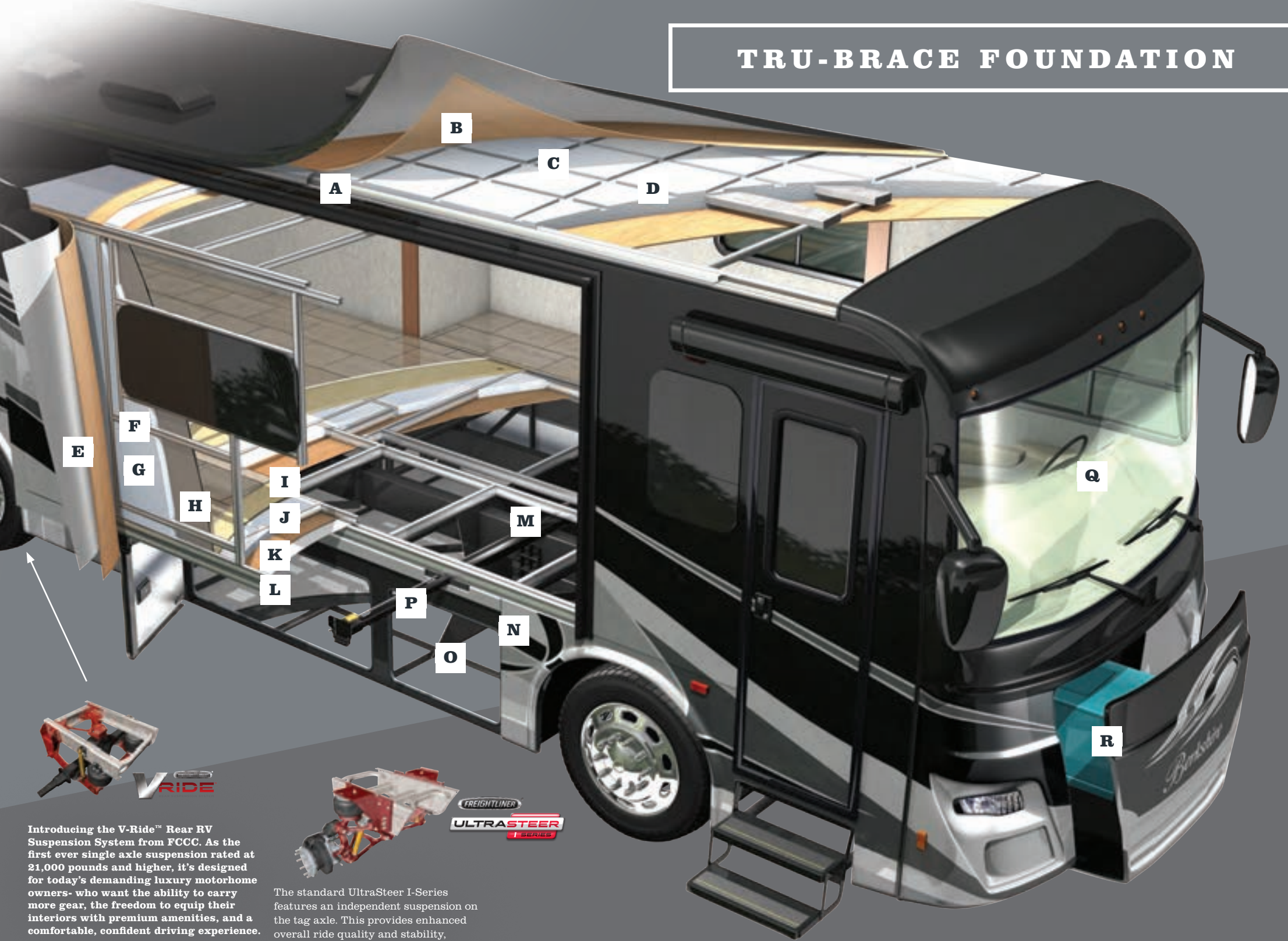

TRU-BRACE FOUNDATION



Introducing the V-Ride™ Rear RV Suspension System from FCCC. As the first ever single axle suspension rated at 21,000 pounds and higher, it's designed for today's demanding luxury motorhome owners- who want the ability to carry more gear, the freedom to equip their interiors with premium amenities, and a comfortable, confident driving experience.



The standard UltraSteer I-Series features an independent suspension on the tag axle. This provides enhanced overall ride quality and stability, with comparable weight capacity and turning angle to the B-Series.*

1 6" ROOF AT THE CROWN, WELDED ALUMINUM TUBE - LAMINATED VACUUM BONDED WITH INTEGRATED A/C DUCTING.

A FRAMING IS WELDED 2" ALUMINUM TUBE

B LAYERED STRUCTURAL 1 PIECE FIBERGLASS

C 5-1/4" RADIUS POLYSTYRENE INSULATION

D GALVANIZED METAL BACKERS FOR A/C'S, SATELLITE, SOLAR PANEL AND ANTENNAE

2 1-7/8" THICK SIDEWALL, WELDED ALUMINUM TUBE - LAMINATED VACUUM BONDED.

E LAYERED STRUCTURAL FIBERGLASS SIDEWALL

F HEAVY WALL ALUMINUM TUBE AROUND PERIMETER AND AROUND SLIDE OPENINGS

G 1-1/2" POLYSTYRENE INSULATION

H 1/8" INTERIOR DÉCOR FINISHING BOARD

3 3-1/8" FLOOR, VACUUM BONDED LAMINATED

I FRAMING IS WELDED 2-1/2" ALUMINUM TUBE.

J 2-1/2" POLYSTYRENE INSULATION

K 1 PIECE 1/2" STRUCTURE BOARD

L DARCO, A WATERPROOF UNDERBELLY MATERIAL

4 FULL PAINT WELDED STEEL CHASSIS STRUCTURE

M TRU-BRACE, CHASSIS STIFFENER SYSTEM

N 1 PIECE ALUMINIZED STEEL SIDE SKIRT

O 1 PIECE BENT STEEL STORAGE COMPARTMENTS

P 1-1/2" INSULATED STEEL TUBE FIREWALL

5 FIBERGLASS MOLDED FRONT AND REAR CAPS

Q 1 PIECE AUTOMOTIVE GRADE BONDED WINDSHIELD

R GENERATOR SLIDE SYSTEM

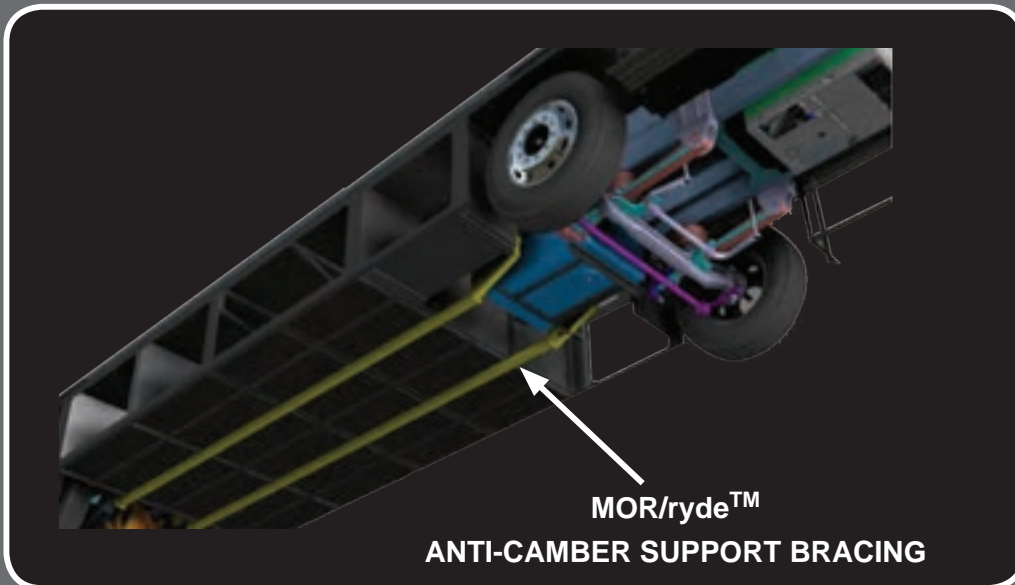

FOR MORE INFORMATION PLEASE VISIT
WWW.FORESTRIVERINC.COM/BERKSHIREXLT

*Berkshire*_{XLT}



*Berkshire*_{XLT}



ALL PICTURES MODEL 45A FEATURING WHITE DIAMOND INTERIOR DECOR



STANDARDS + OPTIONS

CHASSIS

- Freightliner XCR Raised Rail Chassis
- Cummins ISL Turbo Diesel, 450 HP@2100RPM, 2200GOV RPM 1250 LB/FT @1400 RPM
- Allison 3000MH 6-Speed Transmission
- 120V Engine Heater 1000w
- 22.5" Polished Aluminum Wheels
- Michelin X Line Energy Z 275/80R22.5 Tires
- Trailer Hitch, 15,000 Lb. Capacity
- Allison Electronic Push Button Shifter
- 150 Gallon, Locking Dual Fill Fuel Tank
- Driver Side Fill, 15 Gallon DEF Tank
- LCD Engine Message Center
- Day Time Running Lights
- 7-Pin Tow Power Connector
- 18.7 CFM Air Compressor
- Farr Eco-Air Cleaner
- Power Steering
- Washer/Heavy Duty-Wiper w/Intermittent Function
- Two 1900 CCA Maint. Free Chassis Batteries
- Full Air ABS Brakes w/ Auto Slack Adjuster
- Jacobs Compression Brake
- Variable Exhaust Brake
- Telescopic/Tilt Steering Wheel, Adjustable Suspended Pedals
- Suspension Neway (Front/TAG), V- Ride (Rear)
- Sachs Custom Tuned Shock Absorbers
- 55 Degree Wheel Cut
- Auto Air Suspension Deflation System
- Side Radiator System
- 5 Year / 100,000 Mile Coolant (Some Maintenance Required)
- V.I.P. Smart Wheel, 4-Spoke 18" Premium Burlwood Steering Wheel
- Electronic Cruise Control with High Idle
- Ultra Steer TAG Axle

CONSTRUCTION AND EXTERIOR

- Fiberglass Front And Rear Caps
- Full Body Painted Exterior (4X Clear Coat)
- Four (4) Point Fully Auto Hydraulic Leveling System w/Auto Air Dump
- Steel Basement Structure
- TRU-BRACE Chassis Support System
- Rust Resistant Aluminized Steel Chassis Skirts
- Diamond Shield Front Mask Protective Film
- One Piece Fiberglass Roof
- Top-Mount Chrome Remote Exterior/Heated/ Mirrors with Cameras
- Frameless Dual Pane, Dark Tint Windows
- Automotive Foam And Ziebart Seal Undercoating
- Carefree Power Door Awning
- Carefree Latitude Patio Awning w/LED Lighting and Wind Sensor
- Carefree Slideout Topper w/Covers (Full/Wall)
- Full Height Strut Assisted Compartment Doors with Full Pass Through Storage
- "One Key" System, Exterior Compartment, Entry Door & Fuel Fill Doors
- Quiet Integrated A/C Intake/Ducting Roof System
- Crowned and Layered Vacuum Bonded Fiberglass Roof
- Vacuum Bonded 3" Floor w/Tubular Aluminum Frame
- Gel Coat Vacuum Bonded Sidewalls, Slideout Floors & Walls
- Block Foam Polystyrene Insulation in Walls Roof And Floors
- 30" Entryway
- Channeled Drains for A/Cs
- Tubular Steel Firewall w/Polystyrene Insulation
- 84" Interior Ceiling Height
- PTL Steel Entrance Door with Deadbolt
- Auxiliary Air Chuck (Front Driver Side Compartment)

- Auxiliary LP Supply, Quick Connect (Passenger Side)
- LED Marker Lights
- Full Length Mud Flap w/Chrome Forest River Name
- Slide Tray in Basement Compartment
-

ELECTRICAL

- 50A Service w/Auto Transfer Switch and 36' Power Cord Reel
- 10KW Onan Diesel Generator w/Manual Slide Tray
- Energy Management System
- Electronic House Power Disconnect Switch
- Generator Start/Stop Switch (On Dash/ Bedroom)
- Multi-Plex with Precision Plex App Control
- Dimmer Control Lighting Throughout
- Individual Reading Lights Bed Overhead
- 2000w Pure Sine Inverter/Converter
- Auto Generator Start Control
- Four (4) Six Volt Deep Cycle House Batteries
- Easy Read 12V Circuit House Load Center
- Solar Panel Controller with Roof Prep
- Ceiling Fan in Bedroom
- Kitchen Accent Lighting

PLUMBING

- Variable Speed 4 GPM Water Pump
- Individual Zoned Hot/Cold Manifold Water Supply System
- 4-Way Water Management Valve in Water Bay
- Bath - Solid Surface Under Mount Sink
- Fiberglass Shower Base, Tiled Walls, Glass Door and Skylight
- Whole House Water Filter
- Porcelain China Bowl Toilet w/Foot Flush
- Tecma Macerator Toilet (N/A 43B)
- Convenience Monitor Panel at Water Bay
- 360 Roof Vent Caps

DRIVER/PASSENGER/COCKPIT

- One Piece Windshield
- Power Front Day/Night Shades
- Passenger & Driver Window Day/Night Shades
- 10" Dash Radio w/ Color Back-Up, Side View Cameras with Navigation
- Sirius/XM Satellite Roof Mounted Antenna
- Flexsteel Soft Touch Wide Driver Seat w/ Swivel, Recline and 6-Way Power Adjust
- Flexsteel Soft Touch Wide Passenger Seat w/ Swivel, Recline and Power Foot Rest
- Two (2) Defroster Fans with High And Low Settings
- Automotive Dash AC/Heater w/Deluxe Controls
- Multiple AUX/USB Charging Ports at Dash
- Power Flush Floor Step-Well Cover
- Driver & Passenger LED Ceiling Map Lights
- Emergency/AUX Engine Start Switch at Dash

ENTERTAINMENT

- 49" LED TV, Living Room (N/A 45A)
- 40" LED TV, Living Room (45A Only)
- 32" LED TV, Bedroom
- 32" LED TV, Front Dash Overhead
- 22" LED TV, (2) Each Bunk with Easy Access HDMI Jack (N/A 43C, 45B)
- Bose Soundbar w/Integrated Sub and Bluetooth
- Roof Mount Winegard Trav'ler Satellite Prep
- Park/Cable Prep
- High Definition Cat6 Matrix Signal Distribution
- Hi-Definition Digital TV Antenna
- Blu-Ray DVD Player
- Exterior Entertainment Center in Sidewall with 40" TV & Radio with AUX Jack
- Exterior Entertainment center in sidewall w/ Swing Brkt. 43" TV, Radio with AUX jack (45B Only)

INTERIOR

- Polished Porcelain Tile Throughout
- Semi Gloss Hardwood w/Glazing- Cabinetry, Interior Doors and Slideout Fascia (Glazing N/A with Executive Dark Cherry Option)
- Living Room Ceiling Crown Trim
- Villa Dream Booth Dinette with Hide-A-Bed Sofa and Storage (N/A 45B)
- Villa Soft Touch Love Seat (N/A 45A)
- Polished Solid Surface Kitchen/Bathroom Countertops And Backsplash with Tile Inserts
- Soft Close Ball Bearing Metal Drawer Guides in Kitchen and Bathroom
- Galley Storage Compartment for Sink Covers
- Kitchen Pantry
- Bi-Fold Doors, Bunk Beds (N/A 43C, 45B)
- "Soft Touch" Padded Ceiling
- Roller Style Day/Night Shades
- 72"X 80" Serta King Bed with Bedspread and Decorative Pillows
- Bed Night Stands, 1 with Dual USB Jack and Overhead Cabinetry
- Fitted Cockpit Floormat with "Berkshire" Logo
- LP Gas, Carbon Monoxide and Smoke Detectors
- Fire Extinguisher

APPLIANCES

- 15,000 BTU with Heat Pump (Front & Rear), 13,500 BTU (Middle) Low Profile AC's
- Holding Tank Heat Pads
- Aqua Hot Hydronic Heat with Continuous Flow Hot Water
- 30" OTR Convection Microwave Oven
- 23 Cu. Ft. French Door Residential Refrigerator with Ice Maker
- Electric Induction Glass Cooktop
- Power Fan in Bathroom with Rain Cover
- Maxxair In Galley with Wireless Remote Control and Rain Cover
- Washer/Dryer Prep
- Electric Fireplace (N/A 43C, 45B)
- Central Vacuum System

OPTIONS

- Electric Easy-Bed Lift, Cockpit Area
- Free Standing Dinette w/4 Chairs and "Hide-A-Bed" Sofa IPO Ensemble (N/A 45B)
- Booth Dinette with "Hide-A-Bed" Sofa IPO Ensemble (N/A 45B)
- Free Standing Dinette w/4 Chairs and "Theater Seating" IPO Ensemble (N/A 45B)
- Booth Dinette With "Theater Seating" IPO Ensemble (N/A 45B)
- Second Carefree Latitude Dual Pitch Awning w/ LED Lighting and Wind Sensor (43B Only)
- Electric Heated Tile Floors
- Ceramic Wood Plank Tile Throughout
- Trav'ler (Winegard) Satellite Antenna- Direct TV (Us)
- Trav'ler (Winegard) Satellite Antenna-Shaw (Canada)
- Stackable Washer/Dryer
- Stainless Steel Dishwasher

Berkshire_{XLT}

10 FEATURES

- 1 **FREIGHTLINER XCR RAISED RAIL CHASSIS CUMMINS ISL TURBO DIESEL, 450 HP@2100RPM, 2200GOV RPM 1250 LB/FT @1400 RPM**
- 2 **ALLISON 3000MH 6-SPEED TRANSMISSION**
- 3 **AQUA HOT HYDRONIC HEATING, ALL ELECTRIC COACH**
- 4 **FULL HEIGHT, STRUT ASSISTED, INSULATED DIESEL MOTORHOME BAGGAGE DOORS**
- 5 **FULL TILED SHOWER(S)**
- 6 **INDIVIDUAL WATER MANIFOLD SYSTEM WITH POINT TO POINT PLUMBING**
- 7 **RUST RESISTANT ALUMINIZED CHASSIS SKIRTS**
- 8 **PRECISION CIRCUITS MULTIPLEX WIRING WITH SMART PHONE APP CONTROLS**
- 9 **FULL WALL HYDRAULIC SLIDES**
- 10 **FULL BODY PAINT FEATURING 4X SIKKENS® CLEAR COAT**



STANDARD EXTERIOR ENTERTAINMENT CENTER



STANDARD 8KW ONAN DIESEL GENERATOR W/MANUAL SLIDE TRAY

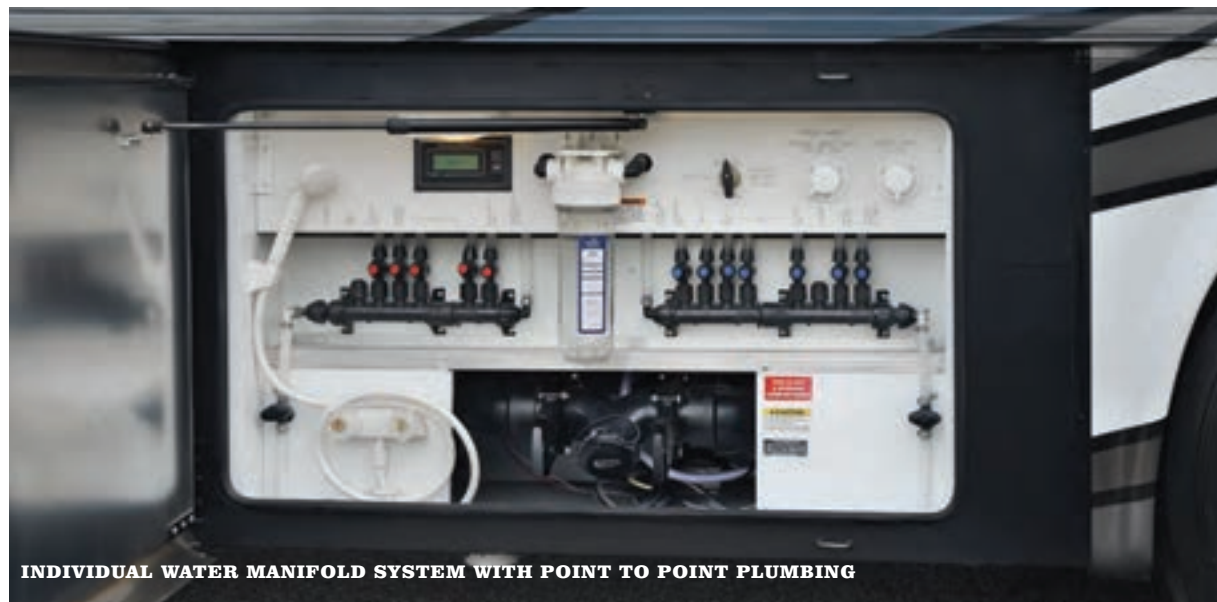

INDIVIDUAL WATER MANIFOLD SYSTEM WITH POINT TO POINT PLUMBING



STANDARD SLIDE TRAY IN STEEL BASEMENT FULL PASS THRU STORAGE COMPARTMENT

FLOORPLANS

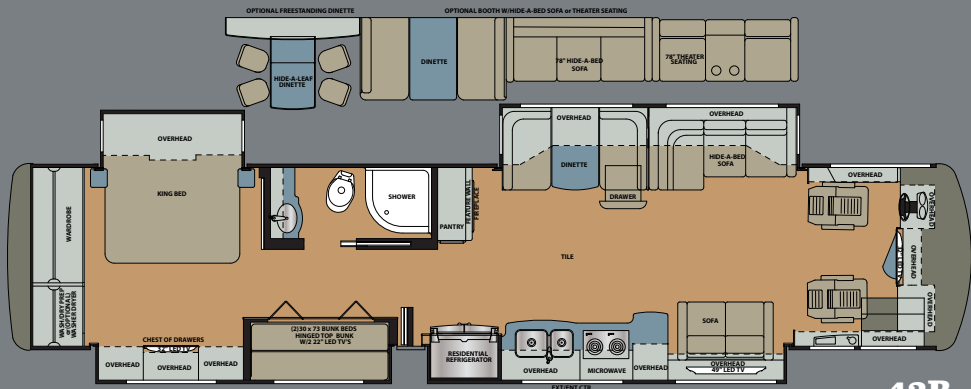

= 9
 = STD. 8
 OPT. 10

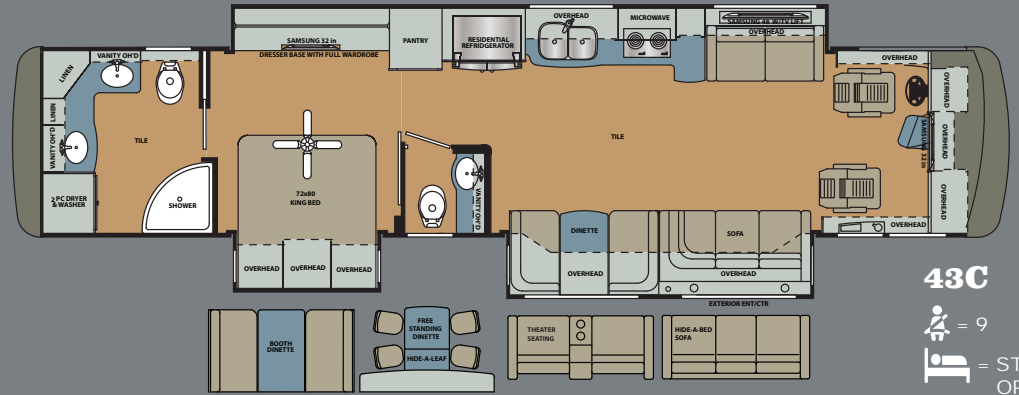

= 9
 = STD. 6
 OPT. 8

= SEAT BELTS
 = SLEEPS
 (STD./STANDARD
 OPT./WITH OPTIONAL BED LIFT)

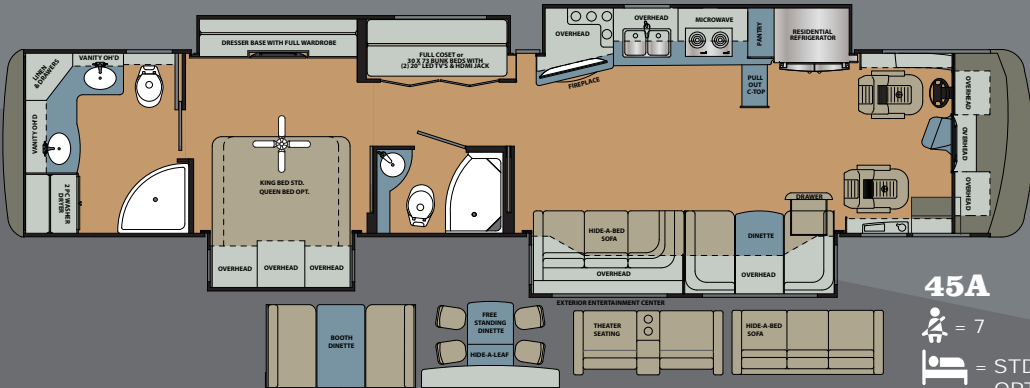

= 7
 = STD. 7
 OPT. 9

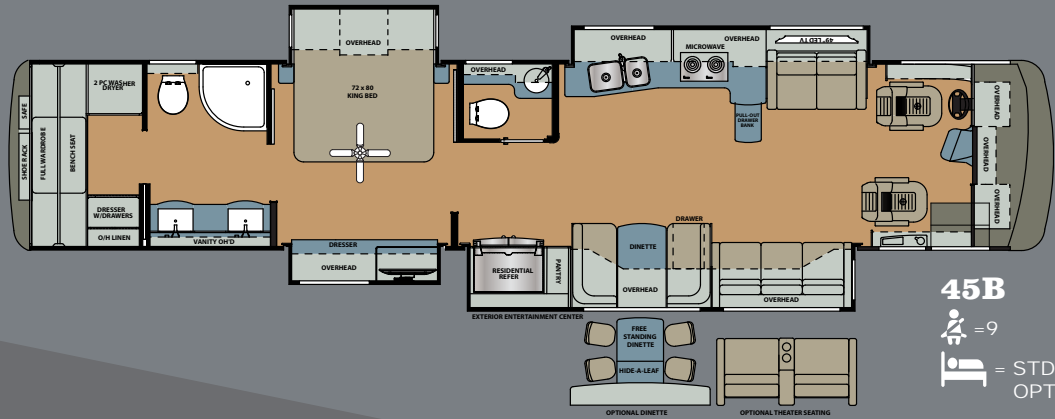

= 9
 = STD. 6
 OPT. 8

Floorplan	Length (Feet)	GVWR (Lbs.)	GCWR (Lbs.)	GAWR Front (Lbs.)	GAWR Rear (Lbs.)	GAWR TAG (Lbs.)	Wheel-base (Inches)	Height* (Feet)	Width* (Inches)	Basement storage* (Cu. Ft.)	Awning (Feet)	Opt. 2nd Awning (Feet)	Fresh Tank* (Gal.)	Gray Tank (Gal.)	Black Tank (Gal.)	Res. LP Tank (Lbs.)	Hydronic Heat (BTU's)	Hot Water
43B	42' 10"	44,320	59,320	14,320	20,000	10,000	273"	12' 11"	100"	227'	15' 8"	12' 9"	103	66	42	20	65,600	Continuous
43C	42' 10"	44,320	59,320	14,320	20,000	10,000	273"	12' 11"	100"	227'	12' 9"	N/A	103	66	42	20	65,600	Continuous
45A	44' 7"	44,320	59,320	14,320	20,000	10,000	294"	12' 11"	100"	261'	12' 9"	N/A	103	66	42	20	65,600	Continuous
45B	44' 7"	44,320	59,320	14,320	20,000	10,000	294"	12' 11"	100"	261'	12' 9"	N/A	103	66	42	20	65,600	Continuous

*Fresh water tank includes quick drain valve | Please see back cover for more information regarding weights.

PAINT PACKAGES

*Berkshire*_{XLT}

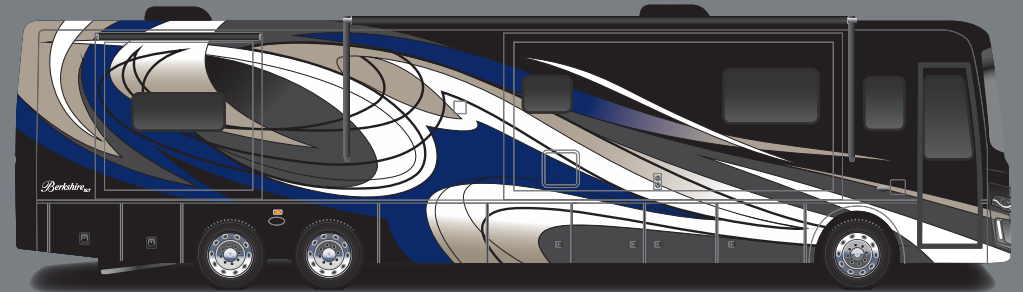

MALIBU

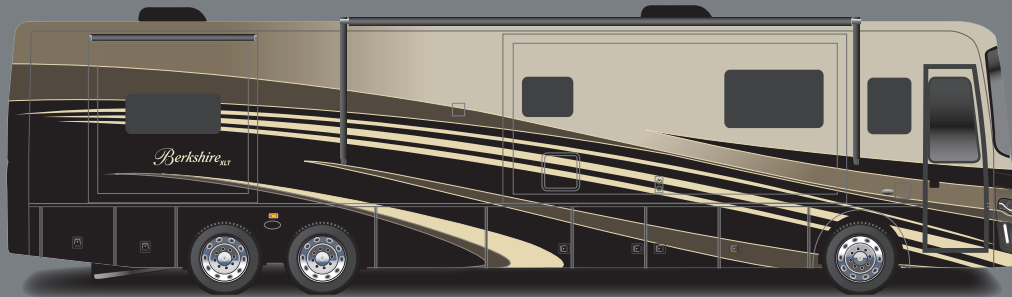

FOSSIL

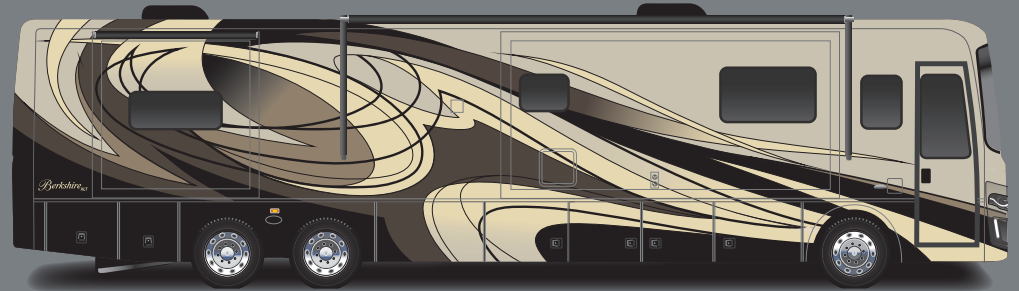

PATAGONIA



HEMATITE

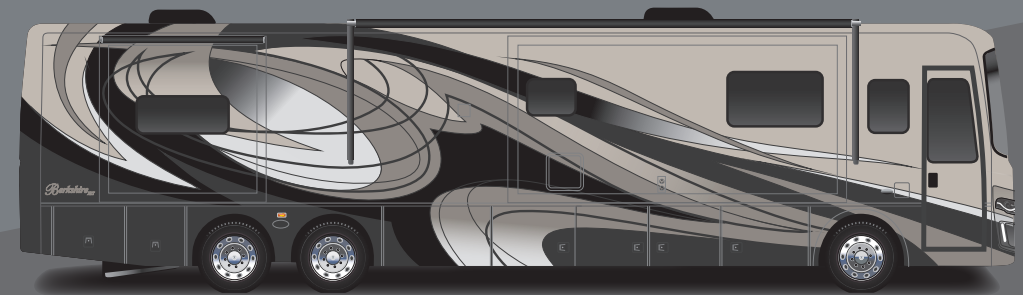

CANTERBURY



TANZANITE

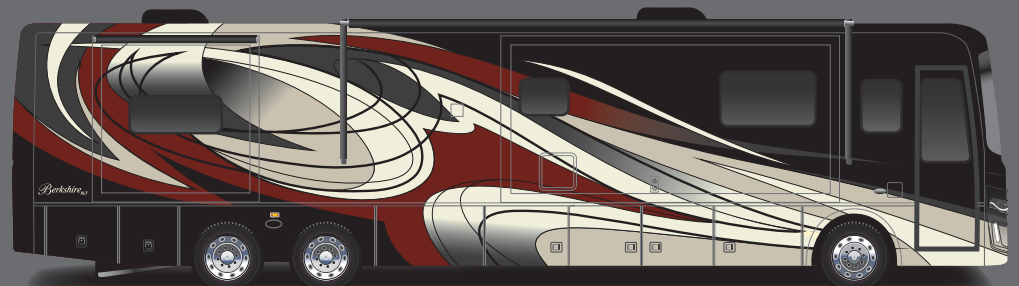

FLORENCE

CUSTOMIZE YOUR INTERIOR

WOOD GRAIN OPTIONS (CHOOSE ONE)



NATIVE CHERRY



BRONZE MAPLE

LEATHERETTE OPTIONS (CHOOSE ONE)

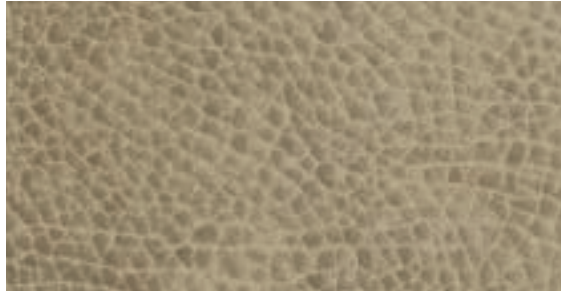

MOCCASIN

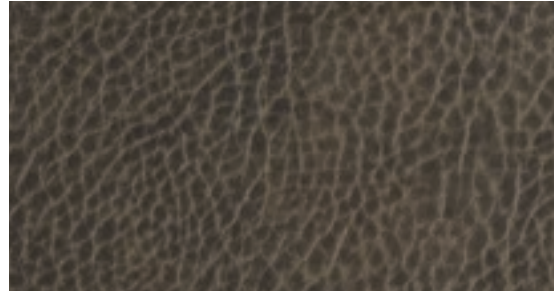

BISON

DESIGNER FABRIC OPTIONS (CHOOSE ONE)

RUSTIC IRON



SILVER BAY



STANDARD FLOORING

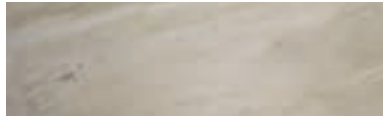

STANDARD COUNTERTOP



WOOD PLANK FLOORING OPTION

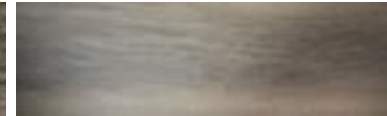

DECOR OPTIONS

WHITE DIAMOND SHIELD FIXED INTERIOR DECOR



EXECUTIVE DARK CHERRY
WOOD GRAIN

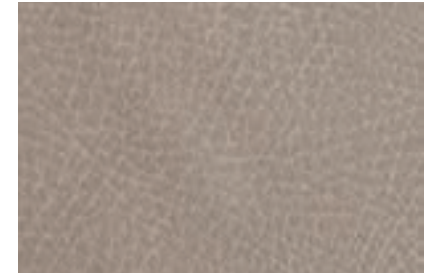

BRISA
LEATHERETTE

DESIGNER FABRICS



WHITE DIAMOND SHIELD FLOORING



WHITE DIAMOND SHIELD COUNTERTOP



WHITE DIAMOND SHIELD WOOD PLANK FLOORING OPTION



CUSTOMER SATISFACTION



www.ForestRiverBuyLocal.com

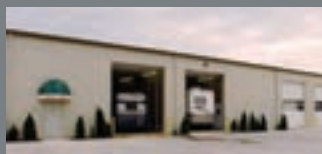

PRE-DELIVERY INSPECTION FACILITY
20,000 square feet of quality assurance. The bare essentials for a premium product. This state-of-the-art facility gives immediate daily feedback to production for quality assurance in every unit built.



GVWR (Gross Vehicle Weight Rating) - is the maximum permissible weight of the unit when fully loaded. It includes all weights, inclusive of all fluids, occupants, cargo, optional equipment and accessories. For safety and product performance do NOT exceed the GVWR.

GCWR (Gross Combined Weight Rating) - Is the maximum permissible loaded weight of your motor home and any towed trailer or towed vehicle. Actual GCWR of this vehicle may be limited by the sum of the GVWR and the installed hitch receiver maximum capacity rating; see hitch rating label for detail.

GAWR (Gross Axle Weight Rating) - is the maximum permissible weight, including cargo, fluids, optional equipment and accessories that can be safely supported by each axle.

UVW (Unloaded Vehicle Weight)* - is the typical weight of the unit as manufactured at the factory. It includes all weight at the unit's axle(s), including full fuel, all fluids and LP Gas. The UVW does not include cargo, fresh potable water, additional optional equipment or dealer installed accessories.

*Estimated Average based on standard build optional equipment.

CCC (Cargo Carrying Capacity)** - is the amount of weight available for fresh potable water, cargo, passengers, additional optional equipment and accessories. CCC is equal to GVWR minus UVW. Available CCC should accommodate fresh potable water (8.3 lbs per gallon). Before filling the fresh water tank, empty the black and gray tanks to provide for more cargo capacity.

** Estimated average based on standard build optional equipment.

Each Forest River RV is weighed at the manufacturing facility prior to shipping. A label identifying the unloaded vehicle weight of the actual unit and the cargo carrying capacity is applied to every Forest River RV prior to leaving our facilities.

The load capacity of your unit is designated by weight, not by volume, so you cannot necessarily use all available space when loading your unit.

Actual towing capacity is dependent upon your particular loading and towing circumstances, which includes the GVWR, GAWR and GCWR as well as adequate trailer brakes. Please refer to the Operator's Manual of your vehicle for further towing information.

Berkshire_{XL}T



Learn More
Scan this barcode using a QR Reader on your smart phone to learn more about Forest River.



A Berkshire Hathaway company.

Forest River Diesel Division
1800 W. Hivally Ave.
Elkhart, IN 46517
(574) 522-3693
www.forestriverinc.com
www.forestriveraccessories.com

All information contained in this brochure is believed to be accurate at the time of publication. However, during the model year, it may be necessary to make revisions and Forest River, Inc., reserves the right to make all such changes without notice, including prices, colors, materials, equipment and specifications as well as the addition of new models and the discontinuance of models shown in this brochure. Therefore, please consult with your Forest River dealer and confirm the existence of any materials, design or specifications that are material to your purchase decision.

FREE MEMBERSHIP
to Forest River Owners' Group

www.forestriverfrog.com

©Berkshire - a division of Forest River Inc.
A Berkshire Hathaway company

