

CEDAR CREEK COTTAGE WIDE BODY TRAVEL TRAILERS



# Cedar Creek

## COTTAGE



THE SMART CHOICE FOR THE EXPERIENCED RV'ER





40CCK | COTTAGE  
CASHMERE INTERIOR

# Cedar Creek



## THE COTTAGE ADVANTAGE

*Enjoy the comfort of your very own Cottage at a favorite vacation spot. The Cedar Creek Cottage offers the convenience of a travel trailer with the amenities of a fine vacation home. The wide body design and eight feet interior heights provide roomy comfort for family and guests. Whether at the lake, in the mountains, or a favorite campground, Cottage's upscale features make you feel right at home.*

# COTTAGE





40CFK2 | COTTAGE  
LINEN INTERIOR



THE SMART CHOICE FOR THE EXPERIENCED RV'ER ... FOR VACATION RELAXATION



*Cedar Creek's residential design and abundant storage creates a feeling of home away from home. High quality, name brand amenities provide comfort, and peace of mind.*



# CEDAR CREEK COTTAGE FLOORPLANS

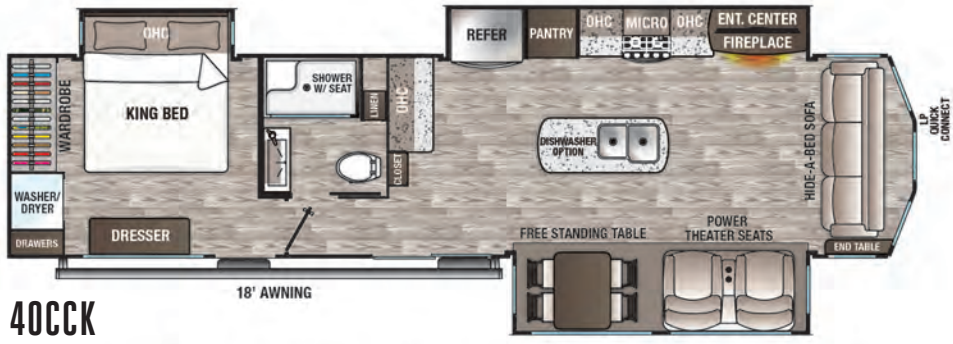

40CCK

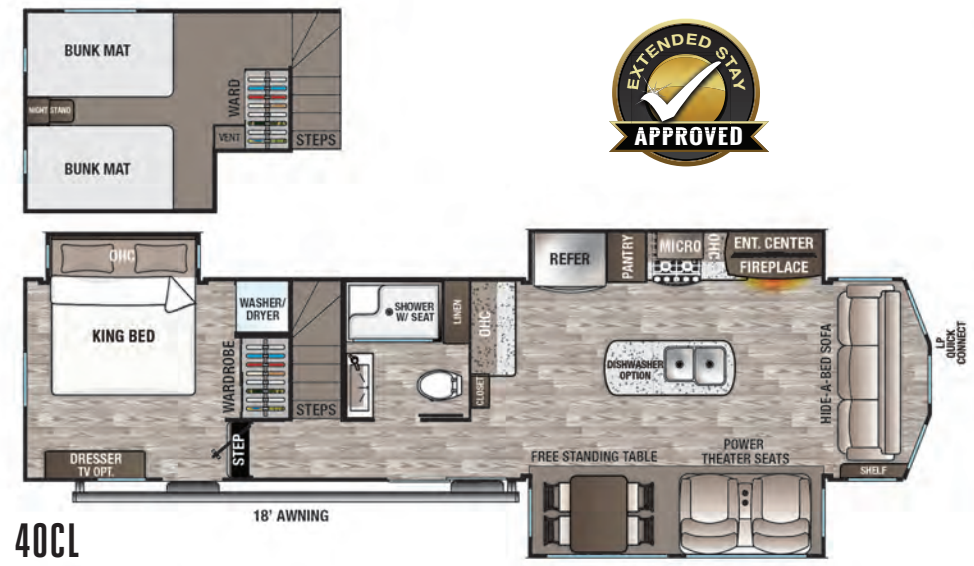

40CL

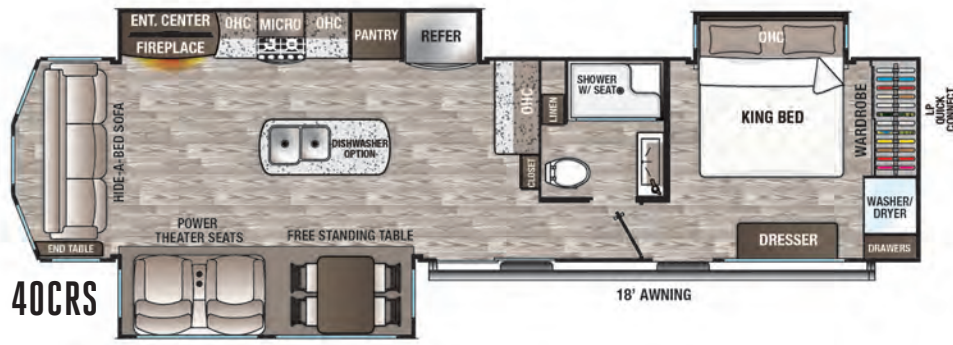

40CRS

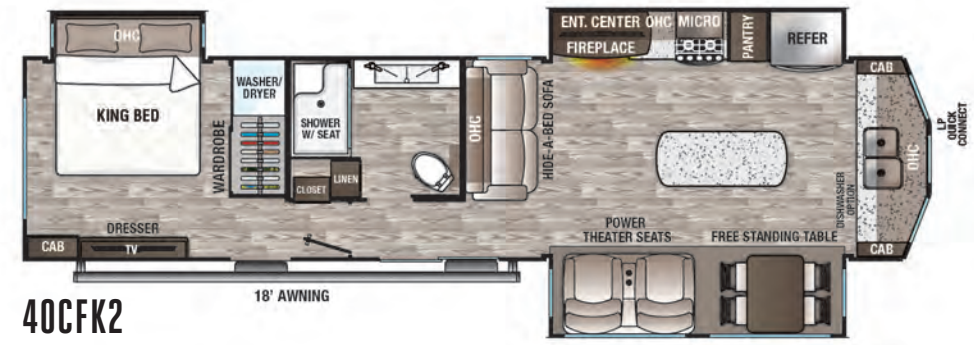

40CFK2

MODEL	40CCK	40CRS	40CL	40CFK2
GVWR	13835 lb.	13565 lb.	13930 lb.	13745 lb.
Hitch Weight	1835 lb.	1565 lb.	1930 lb.	1715 lb.
UVW	11304 lb.	11499 lb.	12484 lb.	11509 lb.
CCC	2531 lb.	2066 lb.	1446 lb.	2236 lb.
Exterior Length	40' 3"	41' 4"	40' 6"	40' 4"
Exterior Height	12' 10"	12' 10"	12' 10"	12' 10"
Exterior Width	102"	102"	102"	102"
On Demand Fresh Water	77 gal.	77 gal.	77 gal.	77 gal.
Gray Water	120 gal.	120 gal.	120 gal.	120 gal.
Black Water	40 gal.	40 gal.	40 gal.	40 gal.
Awning Size	18 ft.	18 ft.	18 ft.	18 ft.

**GVWR (Gross Vehicle Weight Rating)** - is the maximum permissible weight of the unit when fully loaded. It includes all weights, inclusive of all fluids, cargo, optional equipment and accessories. For safety and product performance do NOT exceed the GVWR.

**GAWR (Gross Axle Weight Rating)** - is the maximum permissible weight, including cargo, fluids, optional equipment and accessories that can be safely supported by a combination of all axles.

**UVW (Unloaded Vehicle Weight)\*** - is the typical weight of the unit as manufactured at the factory. It includes all weight at the unit's axle(s) and tongue or pin and LP Gas. The UVW does not include cargo, fresh potable water, additional optional equipment or dealer installed accessories.

\*Estimated Average based on standard build optional equipment.

**CCC (Cargo Carrying Capacity)\*\*** - is the amount of weight available for fresh potable water, cargo, additional optional equipment and accessories. CCC is equal to GVWR minus UVW. Available CCC should accommodate fresh potable water (8.3 lbs per gallon). Before filling the fresh water tank, empty the black and gray tanks to provide for more cargo capacity.

\*\*Estimated average based on standard build optional equipment.

Each Forest River RV is weighed at the manufacturing facility prior to shipping. A label identifying the unloaded vehicle weight of the actual unit and the cargo carrying capacity is applied to every Forest River RV prior to leaving our facilities. The load capacity of your unit is designated by weight, not by volume, so you cannot necessarily use all available space when loading your unit.

Super quiet "HP" (High performance) air conditioning system, includes a larger compressor and cold air returns. 30% More air is being forced into the coach than a standard dual air conditioner.

**KING** The standard KING WiFiMAX WiFi router/range extender creates your own personal, private and secure WiFi network, just like at home. It can be configured to connect to available networks and devices with password access.

# FEATURES AND OPTIONS

## COTTAGE EDITION PACKAGE

### (Mandatory Features)

- "True" High Gloss, Gelcoat Exterior
- Cedar Creek's Famous All Aluminum Construction
- 50" Insignia Television with Swing Arm
- 12V Home Theater System and Control App for Your Smart Phone
- European Beech Cabinet doors with High Sheen Glaze
- Dual Pane Patio Door
- 36" Fireplace with Thermostat
- Intra-vac Central Vacuum System
- Deluxe Hide-A-Bed Sofa
- Power Theater Seating with USB Ports on Each Side
- 20 Cu. Ft., Stainless Steel, Electric Refrigerator
- (4) Sets of Stabilizer Jacks
- Full Pantry in the Kitchen Area
- Congoleum® Flooring in Living Room and Bedroom
- Shaw Carpeting on Dining Slide
- 20 Gallon Electric Water Heater
- 72" x 80" King Mattress
- New, One Piece Backsplash
- Deluxe Day/Night Roller Shades (Day - N/A in bedroom)
- Detachable Hitch
- (2) 15,000 BTU "HP", Whisper Quiet, Air Conditioners

### EXTERIOR FEATURES

- 102" Wide Body
- 50 Amp Service
- Hitch Light

- ABS Ribbed Underbelly Panels with No Screws Into The I-Beam Frame
- Decorative Front Cap with Molded Picket Fence
- Dexter® Heavy Duty Axles with Heavy Duty Link Plates and Shackles
- 16" 6-Lug, ST, "E" Tires
- Electric Awning with LED Night Lighting Strip
- Enclosed and Triple Layered Insulated Underbelly (R-45)
- Large Surface 12V Heating Pads on All Holding and Fresh Water Tanks
- Lighted Entry Step
- Porch Light
- Selector Switches for Slide Rooms
- Clamp Ring Windows with Butyl Rubber Seals
- 5/8" Tongue and Groove Plywood Floor
- New Quick Disconnect LP Gas Line
- Thermal Pane Patio Door



- Large Surface 12V Heating Pads on All Holding and Fresh Water Tanks
- Lighted Entry Step
- Porch Light
- Selector Switches for Slide Rooms
- Clamp Ring Windows with Butyl Rubber Seals
- 5/8" Tongue and Groove Plywood Floor
- New Quick Disconnect LP Gas Line
- Thermal Pane Patio Door

### LIVING ROOM FEATURES

- Large Full View Windows
- Luxury Hide-a-Bed Sofa
- Hardwood Window Treatments
- LED Lighting
- Satellite and cable hook-ups
- Ceiling fan
- Solid Wood, European Beech Fascia Redesign
- New Decorative Paneling

### KITCHEN FEATURES

- Redesigned Island with LED Back Lighting
- USB Ports in Kitchen
- Create-A-Breeze Fantastic Fan with Thermostat and Rain Sensor in Kitchen
- Insignia 24" Freestanding 4-Burner Gas Range

- Stainless Steel 30" Over-The-Range Microwave with Built-In Vent
- Crown Molding Complementing All Overhead Cabinets in Kitchen Area
- Free-standing Table with Hidden Table Leaf Extension and Four (4) Chairs

### BEDROOM FEATURES

- Redesigned Bedroom Package with Shiplap Headboard and King Bed Pillow Package
- Satellite and Cable Hook-ups
- 32" Television
- USB Ports in Bedroom
- Bedroom Roof Vent
- 2" x 2" Finished Bed Base with Gas Lifts
- Side Ventilation Windows
- Ceiling Fan in the Bedroom (N/A 40CL)
- Ceiling Mounted, Individually Switched, Overhead Reading Lights in Slide
- Solid Wood Dresser Top

### BATHROOM FEATURES

- Newly Redesigned Bathroom with Residential, Single Basin, Trough Sink (Double basin trough in 40CFK2 only)
- 18" Tall Porcelain Toilet with Circular Flow Flush System
- One-piece, 48" x 30" Fiberglass Shower
- 10-Blade Bathroom Breeze Power Bath Vent with Convenient Wall Switch
- Bath Towel Rack and Toilet Paper Holder
- Large, Double Stack Bathroom Mirror Medicine Cabinet with Overhead Makeup Lights
- Linen Cabinet

### MISCELLANEOUS FEATURES

- King WiFi Router/Range Extender
- 12V Battery Disconnect
- LP Gas/Carbon Monoxide Detector

- Dometic® Climate Control with Dual Zone Heating and Cooling
- Smoke Detector
- Cedar Creek Switch Control Center
- Solid State 55 Amp Power Converter
- Washer/Dryer Prep
- One-year SafeRide RV Roadside Assistance
- FREE Membership to the Forest River Owner's Group (FROG)

## OPTIONS

### EXTERIOR OPTIONS

- Thule, Second Slide Room, Power Awning
- Slide Room Awning Toppers (All available slides)
- Heat Pump on Main Air Conditioner

### INTERIOR OPTIONS

- Shaw Carpeting in Living Room with Rebond
- Shaw Carpeting in the Bedroom with Rebond
- 30" Stainless Steel Convection Oven/ Microwave
- Splendide, Front Loading, Washer and Dryer
- Fisher & Paykel, Dishdrawer, Stainless Steel Dishwasher in Island

### MATTRESS OPTIONS

- 10" Luxury Queen Mattress
- 10" Luxury King Mattress

### MISCELLANEOUS ITEMS

- Self Regulating Bedroom Wall Heater by Cadet
- Dual Pane Tinted Windows



20 Cu. ft. residential stainless steel electric refrigerator with ice-maker and dedicated inverter.



Full-size pantry with full extension pull out drawers and shelves



Our freestanding table comes standard with a large leaf extension and four chairs.



Shades can be set in any position and are designed with speed and length controls for privacy or a scenic view.



Clean up is quick and easy with stainless steel undermount sinks and this single handle, pull-out faucet with sprayer.



Double waste basket cabinet (40CCK, 40CRS only)



Stainless steel dishwasher is optional on select models.



Free-standing four burner 24" gas range



GRAPHITE

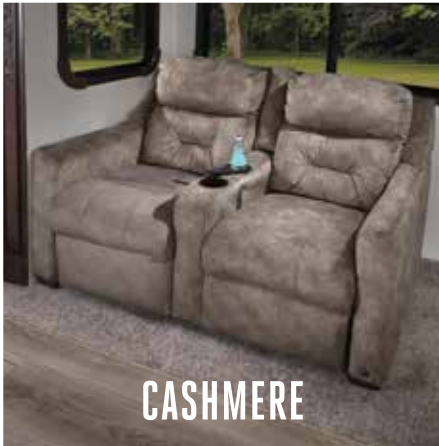

CASHMERE



LINEN

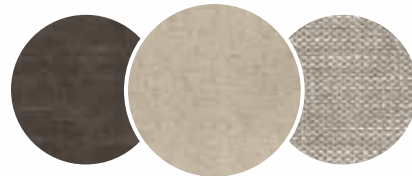
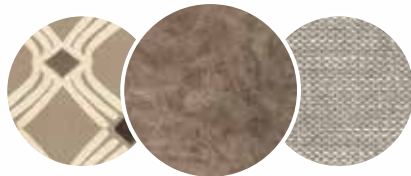

Entertainment center TVs are equipped with swivel mounts for great viewing from any seat.

# Cedar Creek

THE SMART CHOICE FOR THE EXPERIENCED RV'ER

FOREST RIVER INC. • CEDAR CREEK DIVISION

501 Hawpatch Road • Topeka, IN 46571 • Phone : 260-593-2404 • Fax: 260-593-2447  
 Parts & Service: 260-593-4000 • On The Web at: [www.forestriverinc.com/cedarcreek](http://www.forestriverinc.com/cedarcreek)

All information contained in this brochure is believed to be accurate at the time of publication. However, during the model year, it may be necessary to make revisions and Forest River, Inc., reserves the right to make all such changes without notice, including prices, colors, materials, equipment and specifications as well as the addition of new models and the discontinuance of models shown in this brochure. Therefore, please consult with your Forest River dealer and confirm the existence of any materials, design or specifications that are material to your purchase decision. ©2019 Cedar Creek, a Division of Forest River, Inc., a Berkshire Hathaway company. Effective 9/1/19. All Rights Reserved. 11/19

## INTERACTIVE MOBILE MANUALS

Download our Cedar Creek mobile app or visit our dynamic online manual to enhance your ownership experience. These interactive options provide incredible ease and insight into use, maintenance and enjoyment of your Cedar Creek product. Ranging from "How-To" videos, pictures and illustrations of various components, systems and features, to fully searchable content and downloadable PDFs for individual component owner's manuals, answers are always just a click away.

View the online manual at [www.forestriverinc.com/cedarcreek/ownersmanuals](http://www.forestriverinc.com/cedarcreek/ownersmanuals), or download our FREE app from the App Store or Google Play!



### PRE-DELIVERY INSPECTION FACILITY

20,000 square feet of quality assurance. The bare essentials for a premium product. This state-of-the-art facility gives immediate daily feedback to production for quality assurance in every unit built.

**FREE MEMBERSHIP**  
 to Forest River Owners' Group



[www.forestriverfrog.com](http://www.forestriverfrog.com)

**24/7 EMERGENCY  
 ROADSIDE ASSISTANCE  
 WITH VEHICLE PURCHASE\***

TOWING JUMP-STARTS TIRE CHANGES FLUID DELIVERY LOCKOUT SERVICE	WINCH-OUT MOBILE MECHANIC TECHNICAL SUPPORT DEALER LOCATOR SERVICES
---	--

**SAFERIDERV  
 MOTOR CLUB**

\*VALID FOR 1 YEAR FROM DATE OF PURCHASE

**Learn More**  
 Scan this barcode using a QR Reader on your smart phone to learn more about Forest River.

A Berkshire Hathaway company.



[www.ForestRiverBuyLocal.com](http://www.ForestRiverBuyLocal.com)



YOUR CEDAR CREEK COTTAGE DEALER

