

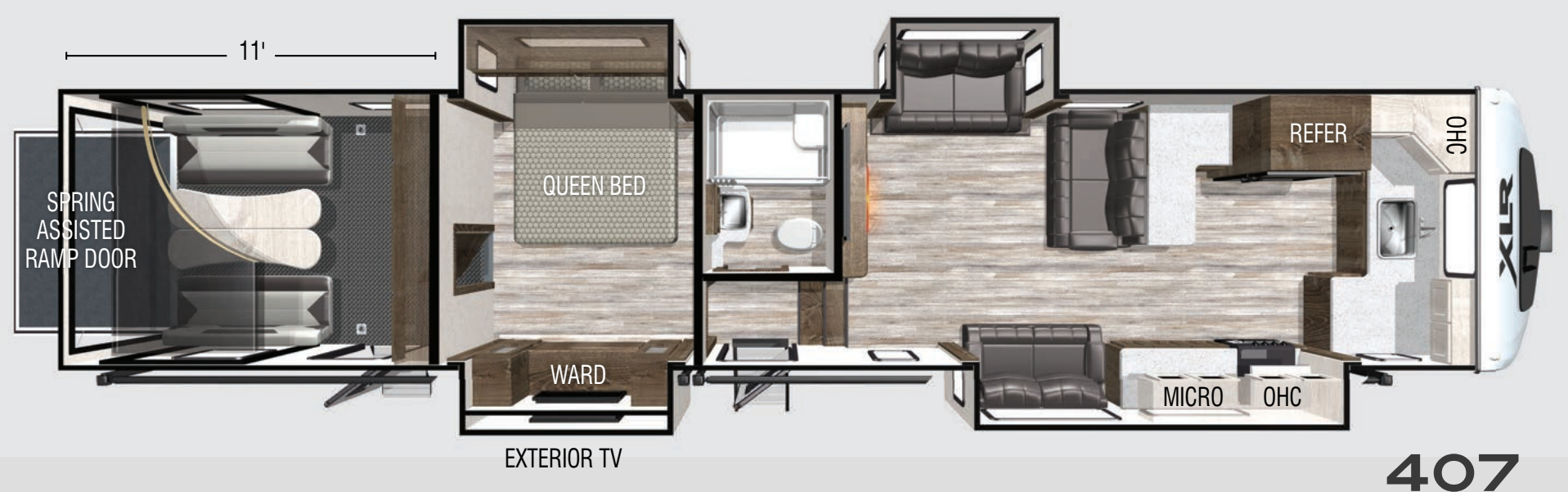

NITRO

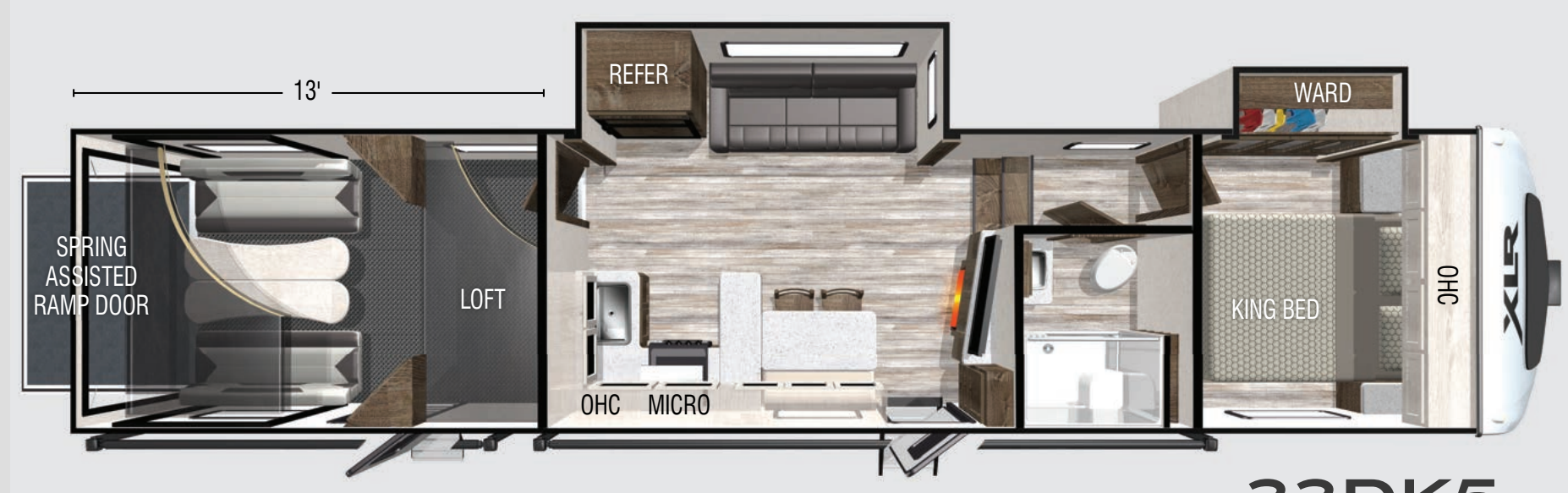
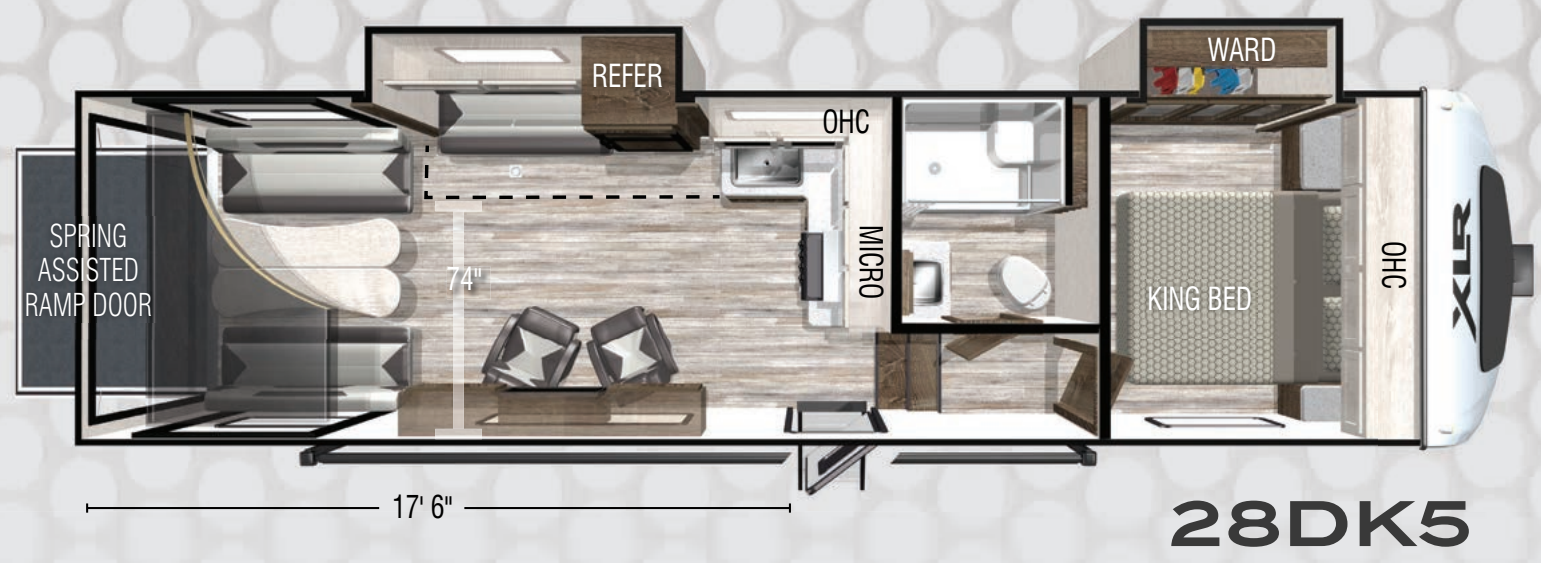

SPECIFICATIONS

	28DK5	321	33DK5	351	35DK5	384	405	407
Hitch Weight (lbs)	2,385	2,585	2,520	2,995	2,810	2,675	3,552	3,695
UVW (lbs)	10,724	12,234	12,454	12,844	13,299	14,849	15,519	14,694
CCC (lbs)	5,661	4,351	4,066	4,146	3,511	6,151	5,481	6,306
Exterior Length	35'	37' 10"	42'	40' 10"	44' 8"	44' 6"	45' 2"	45' 2"
Exterior Height	13' 2"	13' 4"	13' 4"	13' 4"	13' 4"	13' 4"	13' 4"	13' 4"
Exterior Width	102"	102"	102"	102"	102"	102"	102"	102"
Fresh Water (gal)	102	102	102	102	102	102	102	102
Gray Water (gal)	80	71	80	71	80	80	60	60
Black Water (gal)	50	82	50	82	100	50	80	40
Awning Size	20'	18'	18'	18'	20'	20'	20'	20'

CONSTRUCTED TO LAST	
Our radiant-reflective insulation layers are 97% efficient keeping you comfortable all year round.	A MOPlaty® CRE3000 premium suspension smooths out even the toughest of North America's roads.
Heavy-duty Dexter® axles offer you the best in class carrying capacities.	A Wide-Track frame design provides a more stable and stronger foundation over our skinnier competition.
Our Nitro-Fill™ radial tires offer a "No Excuses Guarantee" unmatched in the industry.	XLR utilizes weather resistant tongue-and-groove plywood in all main living areas.
The XLR fully enclosed "Body Armor" underbody is insulated and uses a panel system for ease of access.	XLR has offered the strongest 5,000# tie-down anchor system in the industry since day one to secure your precious cargo.
Our vacuum-bonded technology provides superior adhesion and durability.	Our 1.5" fresh water drain provides a lightning fast way to empty your tank.



forestriverinc.com/rvs/toy-haulers/nitro

Actual towing capacity is dependent on your particular loading and towing circumstances, which includes GVWR, GAWR and GCWR, as well as adequate trailer brakes. Please refer to the Owners Manual of your vehicle for further information. All information contained in this brochure is believed to be accurate at the time of publication. However, during the model year, it may be necessary to make revisions and Forest River, Inc., reserves the right to make all such changes without notice, including prices, colors, materials, equipment and specifications as well as the addition of new models and the discontinuance of models shown in this brochure. Therefore, please consult with your Forest River dealer and confirm the existence of any materials, design or specifications that are material to your purchase decision. ©2020 XLR, a Division of Forest River, Inc., a Berkshire Hathaway company. All Rights Reserved. 12/20



Learn More
Scan this barcode using a QR Reader on your smart phone to learn more about Forest River.

